

Tie 1737' N, 7506' W TO NW COR Section 6, T25N, R50E

6

4

7

8

9

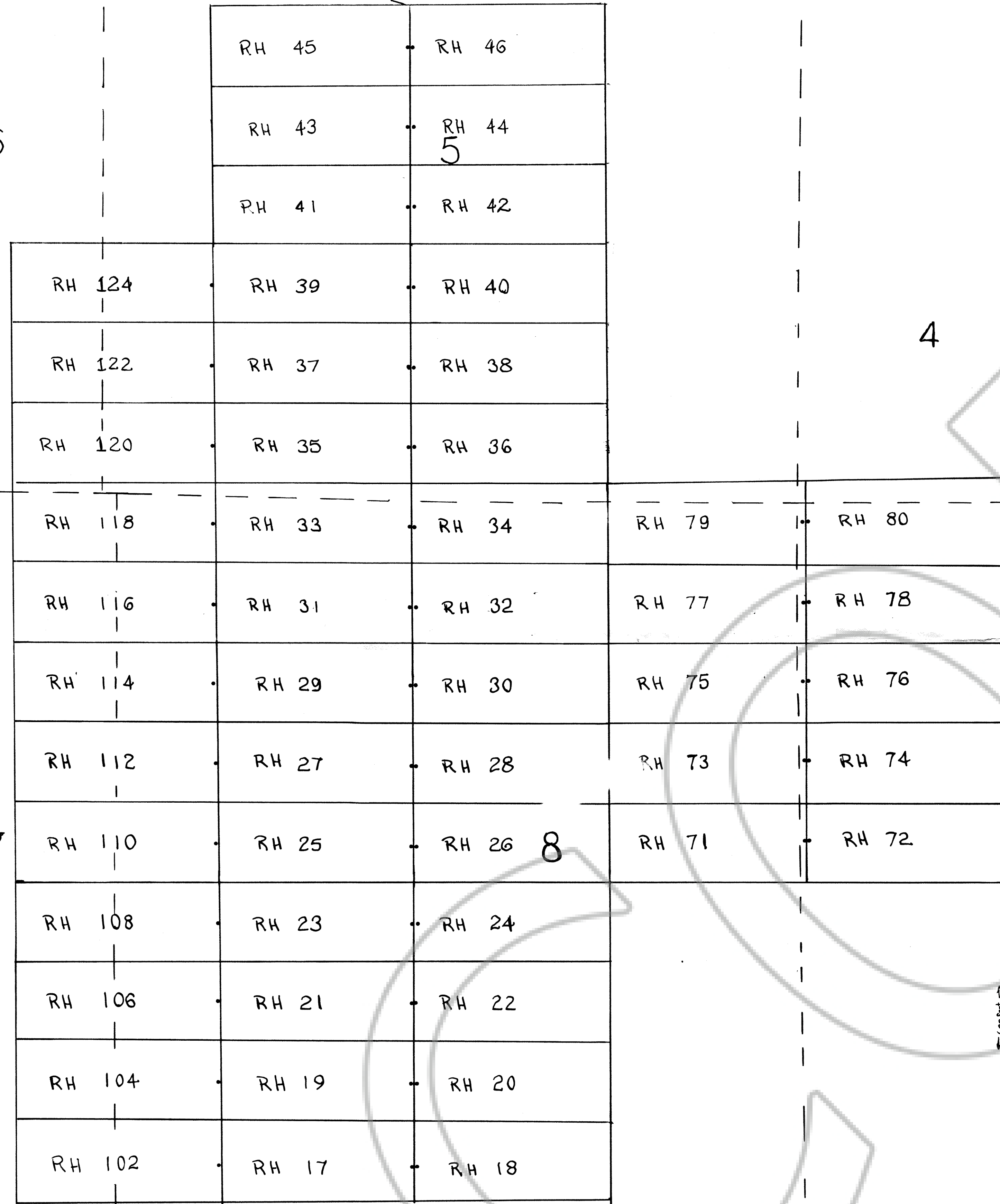

T. 25 N., R. 50 E.

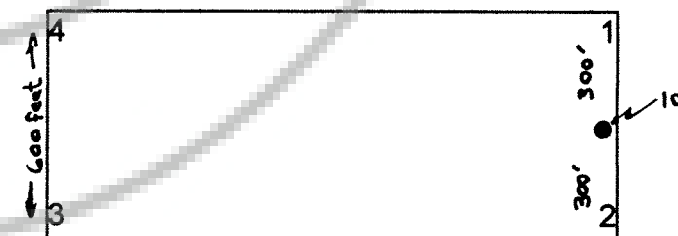

● LOCATION MONUMENT
ALL CLAIM MONUMENTS ARE LOCATED 10 FEET FROM END LINE
ALL CLAIM MONUMENTS ARE 1-1/2" X 1-1/2" X 4' WOOD POST WITH METAL TAGS
SECTION LINES APPROXIMATE

↑ NORTH

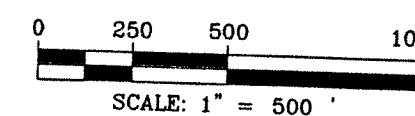

RH CLAIM MAP
17 46, 71-80, 102, 104, 106, 108, 110, 112, 114, 116, 118, 120, 122, 124
LODE MINING CLAIMS

Location Date:

Location: Sections 5, 6, 7, and 8
Township 25 North
Range 50 East
Mount Diablo Meridian
Eureka County, Nevada

Owner: Nevada North Resources (USA), Inc.
501 S. 1st Avenue
Suite N
Arcadia, California 91006

Tie Point: 1,737 feet North and 7,506 feet West to Northwest corner
Section 6, T 25 N, R 50 E, from Northwest corner RH 46

Scale: 1 inch = 500 feet

Note: All claims are 1500 feet x 600 feet
Sections 7 and 8 are unsurveyed

FILED AT THE REQUEST OF *Nevada North Resources*
on *4/22/02* at *5:22* PM, per *10-M*
RECORDS OF EUREKA COUNTY, NEVADA M. N. REBALEATI, Recorder
File No. *178723* Fee \$ *799.00*