

180630

CORNER RECORD

EUREKA COUNTY, NEVADA

SURVEYOR'S CERTIFICATE

- I, MARK D. MORBERG, A PROFESSIONAL LAND SURVEYOR LICENSED IN THE STATE OF NEVADA, CERTIFY THAT:
1. THIS CORNER RECORD REPRESENTS THE ESTABLISHMENT, RESTORATION, OR RECOVERY OF A CORNER OR ACCESSORY TO A CORNER CONDUCTED UNDER MY DIRECT SUPERVISION.
 2. THE MONUMENT OR ACCESSORIES PERPETUATED LIE WITHIN SECTION 1, T.28 NORTH, R.51 EAST, M.D.M. EUREKA COUNTY, NEVADA AND THE ESTABLISHMENT OR RESTORATION WAS COMPLETED ON MARCH 7, 2001.
 3. THIS CORNER RECORD HAS BEEN FILED PURSUANT TO NRS 329.140 OR 329.150 AND COMPLIES WITH THE PROVISIONS OF NAC 329.010 AND ANY LOCAL ORDINANCES IN EFFECT ON THE DATE THAT THE ESTABLISHMENT OR RESTORATION WAS COMPLETED.
 4. THE MONUMENT OR WITNESS MONUMENT AND ACCESSORIES FOUND ARE OF THE CHARACTER SHOWN, OCCUPY THE POSITIONS INDICATED, AND ARE OF SUFFICIENT DURABILITY.

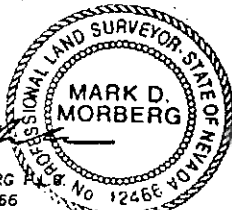

MARK D. MORBERG
NEVADA NO. 12466

3/20/02

Section 1, Township 28 North, Range 51 East, MDM

PT. No. 5316
N 14653297
E 1874137

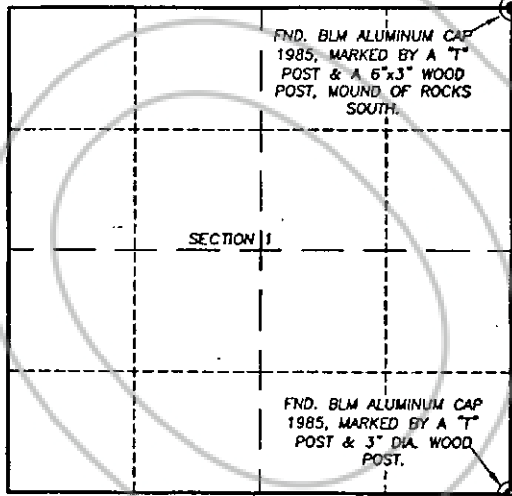

NTS

LEGEND

● FOUND CADASTRAL
CORNER AS DESCRIBED

BASIS OF COORDINATES

NAD 1983 (94 HARN ADJUSTMENT)
UTM, ZONE 11, US SURVEY FEET

NOTES:

1. THE ABOVE REFERENCED CORNER(S) WERE RECOVERED AS PART OF THE SIERRA PACIFIC POWER COMPANY FALCON PROJECT.

RECORDER'S INFORMATION

BOOK 357 PAGE 054

OFFICIAL RECORDS

Stantec Consulting Inc
02 DEC 23 PM 4:27

NEVADA
PUBLIC RECORDS
FILE NO. FEES 14.00

180630



Stantec Consulting Inc.
2000 Lake Center Parkway, Suite 100
Boulder, Colorado 80501-1000
Tel: (303) 440-9111
Fax: (303) 440-9111
www.stantec.com

JOB No. 80400400

JANUARY 2002

SHEET 1 OF 1

BOOK 357 PAGE 054