

180641

# CORNER RECORD

EUREKA COUNTY, NEVADA

## SURVEYOR'S CERTIFICATE

- I, MARK D. MORBERG, A PROFESSIONAL LAND SURVEYOR LICENSED IN THE STATE OF NEVADA, CERTIFY THAT:
1. THIS CORNER RECORD REPRESENTS THE ESTABLISHMENT, RESTORATION, OR RECOVERY OF A CORNER OR ACCESSORY TO A CORNER CONDUCTED UNDER MY DIRECT SUPERVISION.
  2. THE MONUMENT OR ACCESSORIES PERPETUATED LIE WITHIN SECTION 14, T.30 NORTH, R.51 EAST, M.D.M. EUREKA COUNTY, NEVADA AND THE ESTABLISHMENT OR RESTORATION WAS COMPLETED ON OCTOBER 18, 2000.
  3. THIS CORNER RECORD HAS BEEN FILED PURSUANT TO NRS 329.140 OR 329.150 AND COMPLIES WITH THE PROVISIONS OF NAC 329.010 AND ANY LOCAL ORDINANCES IN EFFECT ON THE DATE THAT THE ESTABLISHMENT OR RESTORATION WAS COMPLETED.
  4. THE MONUMENT OR WITNESS MONUMENT AND ACCESSORIES FOUND ARE OF THE CHARACTER SHOWN, OCCUPY THE POSITIONS INDICATED, AND ARE OF SUFFICIENT DURABILITY.

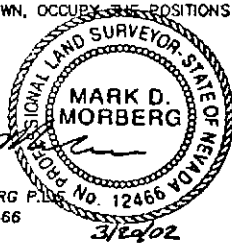

MARK D. MORBERG P.L.S. No. 12466  
NEVADA NO. 12466

Section 14, Township 30 North, Range 51 East, MDM

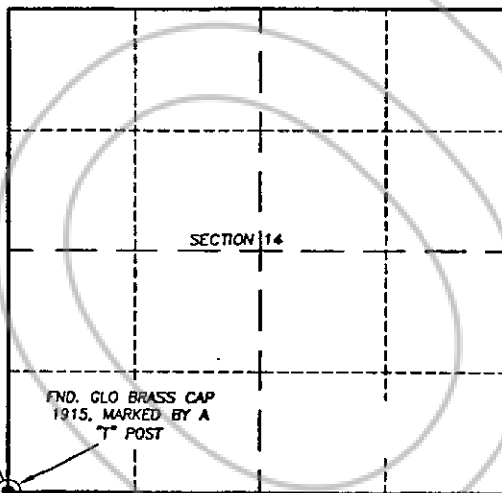

NTS

## LEGEND

- ⊙ FOUND CADASTRAL CORNER AS DESCRIBED

PT. No. 5167  
N 14700530  
E 1863078

FND. GLO BRASS CAP  
1915, MARKED BY A  
T POST

## BASIS OF COORDINATES

NAD 1983 (94 HARN ADJUSTMENT)  
UTM, ZONE 11, US SURVEY FEET

## NOTES:

1. THE ABOVE REFERENCED CORNER(S) WERE RECOVERED AS PART OF THE SIERRA PACIFIC POWER COMPANY FALCON PROJECT.

## RECORDER'S INFORMATION

BOOK 357 PAGE 065  
OFFICIAL RECORDS  
RECORDED IN THE PUBLIC RECORDS  
Stantec Consulting Inc  
02 DEC 23 PM 4:29

RECORDED IN THE PUBLIC RECORDS  
FILE NO.  
FEES \$4.00

180641



Stantec Consulting Inc.  
1000 Lakeside Drive, Suite 100  
Eureka, Nevada 89001-1000  
Tel: 775-850-0077  
Fax: 775-850-0787  
www.stantec.com

JOB No. 80400400  
JANUARY 2002

SHEET 1 OF 1

BOOK 357 PAGE 065