

180668

CORNER RECORD
EUREKA COUNTY, NEVADA
SURVEYOR'S CERTIFICATE

- I, MARK D. MORBERG, A PROFESSIONAL LAND SURVEYOR LICENSED IN THE STATE OF NEVADA, CERTIFY THAT:
1. THIS CORNER RECORD REPRESENTS THE ESTABLISHMENT, RESTORATION, OR RECOVERY OF A CORNER OR ACCESSORY TO A CORNER CONDUCTED UNDER MY DIRECT SUPERVISION.
 2. THE MONUMENT OR ACCESSORIES PERPETUATED LIE WITHIN SECTION 31, T.33 NORTH, R.49 EAST, M.D.M. EUREKA COUNTY, NEVADA AND THE ESTABLISHMENT OR RESTORATION WAS COMPLETED ON OCTOBER 18, 2000.
 3. THIS CORNER RECORD HAS BEEN FILED PURSUANT TO NRS 329.140 OR 329.150 AND COMPLIES WITH THE PROVISIONS OF NAC 329.010 AND ANY LOCAL ORDINANCES IN EFFECT ON THE DATE THAT THE ESTABLISHMENT OR RESTORATION WAS COMPLETED.
 4. THE MONUMENT OR WITNESS MONUMENT AND ACCESSORIES FOUND ARE OF THE CHARACTER SHOWN, OCCUPY THE POSITIONS INDICATED, AND ARE OF SUFFICIENT DURABILITY.

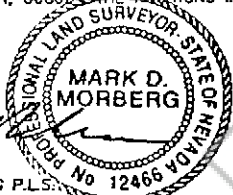

MARK D. MORBERG P.L.S.
NEVADA NO. 12466

3/26/02

Section 31, Township 33 North, Range 49 East, MDM

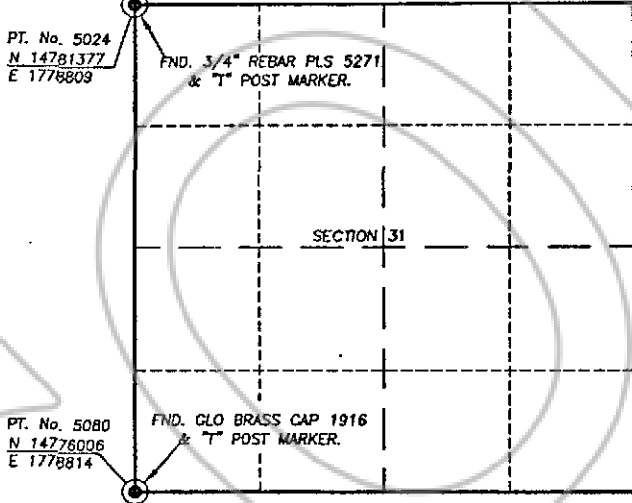

LEGEND

⊙ FOUND CADASTRAL CORNER AS DESCRIBED

BASIS OF COORDINATES

NAD 1983 (94 HARN ADJUSTMENT)
UTM, ZONE 11, US SURVEY FEET

NOTES:

1. THE ABOVE REFERENCED CORNER(S) WERE RECOVERED AS PART OF THE SIERRA PACIFIC POWER COMPANY FALCON PROJECT.

RECORDER'S INFORMATION

BOOK 357 PAGE 092
OFFICIAL RECORDS
Sierrac Consulting Inc.
02 DEC 23 PM 4:32

NEVADA
COUNTY RECORDER
FILE NO. FEES 14.00

180668

01/23/02



Sierrac Consulting Inc.
2000 Lakeshore Parkway, Suite 100
Reno, Nevada 89511 USA
Tel: (775) 786-4137
Fax: (775) 786-4137
www.sierrac.com

JOB No. 80400400
JANUARY 2002
SHEET 1 OF 1