

LODE CLAIM MAP OF THE RMW^{#s} 50-54 AND 73 LODE CLAIM GROUP.

LOCATION: SECTION #6. TOWNSHIP: 31 NORTH. RANGE: 52 EAST.
EUREKA COUNTY, NEVADA. U.S.A.

LOCATOR: CAMRON STITZEL.
LOCATOR ADDRESS: HC#65, Box#1; PALISADE RANCH
CARLIN, NEVADA.
89822.

LOCATION DATE: RMW# 50, 51 JANUARY 10th 2002.
RMW# 52, 53 JANUARY 22nd 2002.
RMW# 73 JANUARY 17th 2002.
RMW# 54 JANUARY 30th 2002.

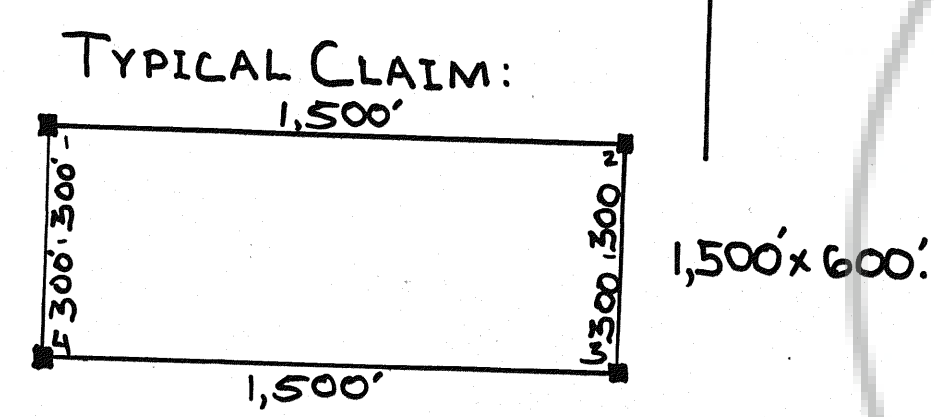

▲: U.S.G.S. SECTION CORNER.
■: 2"x2" CORNER POST.
□: 4"x4" LOCATION POST.
-: 2"x2" LOCATION POST.

////: PRIVATE LAND BOUNDARY.
—: SECTION LINE.
—: LODE CLAIM LINE.
- - - : EXISTING RMW LODE CLAIM LINE WITH N.M.C. NUMBER.
500 ft. —: ONE INCH EQUALS FIVE HUNDRED FEET.
1,500 ft.

