

Claim Location Map for VIO 32 - 78

Locator:
 Placer Dome Exploration Inc.
 Agent: H.H. Tonking
 240 South Rock Blvd Suite 117
 Reno Nv.
 89502

The VIO 32 - 78 Lode Mining Claims are located in Sections 9, 16, 17, 21, and 28 Township 25 North Range 49 East Eureka County, Nevada

"VIO" lode claims 32-58 were located on December 8, 2002
 "VIO" lode claims 59, 62-72 were located on December 9, 2002
 "VIO" lode claims 60, 61, 77, 78 were located on December 10, 2002
 "VIO" lode claims 73-76 were located on December 11, 2002

Notes:
 Location Monuments are set 10' from claim end lines except where noted otherwise. All location and corner monuments are 1.5" X 1.5" X 4' wooden posts with scribed metal tags.

Previously Located Vio claims are in gray.

Typical Claim
 Bearing and Distance

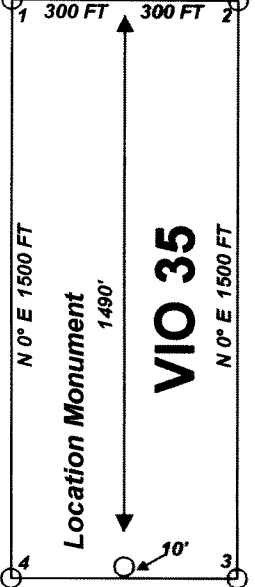

FILED AT THE REQUEST OF *Placer Dome Expl*
 on *Feb 28 2003* at *21 mins past 10 A.M.*
 RECORDS OF EUREKA COUNTY, NEVADA M. N. REBALENTI, Recorder
 File No. *181052* Fee \$ *700.00*

Tie Point Data:
 The NE Corner of VIO 71 bears S3°E26' and is 1451' from the common quarter corner of Sections 16 and 21, T25N R49E.

▲ Surveyed Section Corner



FEET
 Scale 1:6000
 1" = 500'

MINING CLAIM LOCATION MAP
 VIO 32-78 Lode Mining Claims

Placer Dome Exploration Inc.
 Reno, Nevada

Vio_Claim_Map.dwg
 February 18, 2003
 Drawn By: G.I.S. Land Services

Datum: 1927
 Projection: Nevada State Plane Feet East