

11

12

7

R50E
R51E

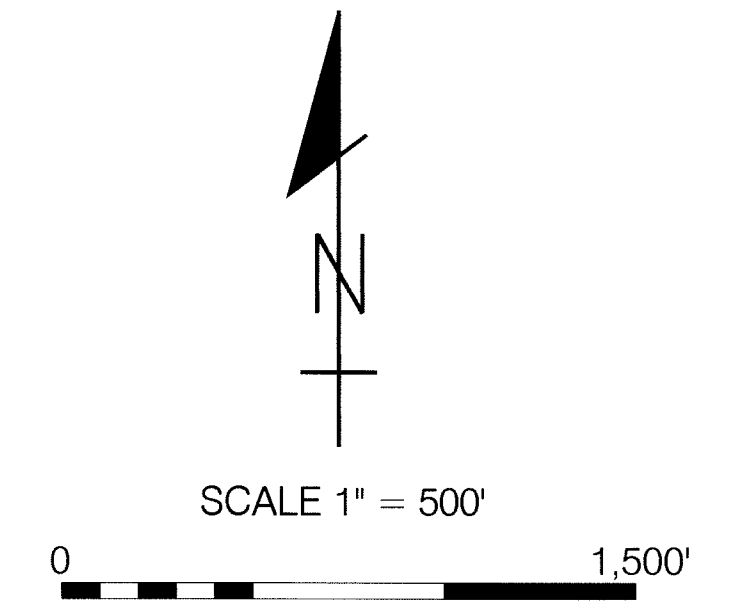

NW Cor of GA-2 is 11,124' S3°W
from NE Cor Sec 1, T24N, R50E

3,000' E-W

GA-2

GA-1

1,500' E-W

GA-15

GA-4

GA-3

1,200' N-S

GA-16

GA-6

GA-5

1,500' E-W

GA-18

GA-17

GA-8

GA-7

GA-20

GA-19

GA-10

GA-9

3,000' N-S

GA-22

GA-21

GA-12

GA-11

GA-24

GA-23

GA-14

GA-13

GA-28

GA-27

GA-26

GA-25

6,000' E-W

18

T24N

19

23

24

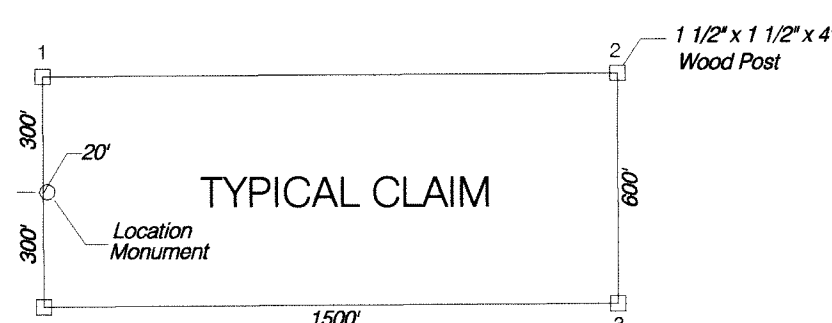

LOCATION DATES

GA-1 THRU GA-10	11/3/03
GA-11 THRU GA-28	11/4/03

LOCATOR

TREND RESOURCES, LLC
 35 N. EDISON WAY, SUITE 4
 RENO, NEVADA 89502

MAP OF THE
 GA-1 THRU GA-28 LODE MINING CLAIMS

SECTIONS 13 AND 24
 TOWNSHIP 24N, RANGE 50E, MDBM
 SECTIONS 18 AND 19
 TOWNSHIP 24N, RANGE 51E, MDBM
 EUREKA COUNTY
 NEVADA

FILED AT THE REQUEST OF *Trend Resources*
 on *Jan 22 04* at *14* mins past *3PM*
 CLERK OF EUREKA COUNTY, NEVADA M. N. REBALEATI, Recorder
 184983