

Recorded at the request of and return to:  
Newmont USA Limited  
d/b/a Newmont Mining Corporation  
PO Box 669  
Carlin, NV 89822

BOOK **375** PAGE **113-116**  
OFFICIAL RECORDS  
RECORDED AT THE REQUEST OF  
*Newmont USA Ltd*  
2004 FEB 17 PM 2:49

EUREKA COUNTY, NEVADA  
M.N. REGALATI, RECORDER  
FILE NO. FEES **17.00**

**185398**

RELEASE

THIS RELEASE is made effective the 15<sup>th</sup> day of February, 2004 by NEWMONT USA LIMITED, a Delaware corporation, d/b/a NEWMONT MINING CORPORATION ("Newmont"), whose address is 1700 Lincoln Street, Denver, Colorado 80203 and NEVADA LAND & RESOURCE COMPANY, LLC, a Delaware limited liability company ("NLRC"), whose address is 704 West Nye Lane, Suite 201, Carson City, Nevada 89703.

RECITALS

A. Santa Fe Pacific Gold Corporation, a Delaware corporation, predecessor in title to Newmont, entered into a Mining Lease (the "1994 Mining Lease") with The Atchison Topeka and Santa Fe Railway Company, predecessor in title to NLRC, dated February 16, 1994, a memorandum of which was recorded on April 25, 1994 in Book 268 at page 404 of the Official Records of Eureka County, Nevada, covering certain rights in and to the property described in Exhibit A attached hereto and by this reference made a part hereof (the "Properties").

B. Pursuant to Section 10 of the 1994 Mining Lease, Newmont desires to release the 1994 Mining Lease by execution and delivery of this release to NLRC.

C. SFP Minerals Corporation, a Delaware corporation, predecessor in title to Newmont, entered into a Minerals Lease (the "1987 Minerals Lease") with Southern Pacific Land Company, predecessor in title to NLRC, dated August 3, 1987, a memorandum of which was recorded on

November 25, 1987 in Book 169 at page 160 of the Official Records of Eureka County, Nevada covering certain rights in and to the Properties.

D. Newmont desires to retain all right, title and interest to the Properties under the terms of the 1987 Minerals Lease.

WITNESSETH:

Subject to all right, title and interest retained by Newmont under the 1987 Minerals Lease, Newmont, pursuant to Section 10 of the 1994 Mining Lease, hereby releases the 1994 Mining Lease effective February 15, 2004.

NEWMONT EXPRESSLY RETAINS ALL RIGHT, TITLE AND INTEREST UNDER THE 1987 MINERALS LEASE, INCLUDING BUT NOT LIMITED TO SUCH RIGHT, TITLE AND INTEREST IN AND TO THE PROPERTIES. THIS RELEASE SHALL IN NO WAY MODIFY, AMEND, OR DIMINISH NEWMONT'S RIGHT, TITLE AND INTEREST UNDER THE 1987 MINERALS LEASE, INCLUDING BUT NOT LIMITED TO SUCH RIGHT, TITLE AND INTEREST IN AND TO THE PROPERTIES.

IN WITNESS WHEREOF, Newmont has caused this Release to be executed as of the day and year first above written.

NEWMONT:

Newmont USA Limited  
d/b/a Newmont Mining Corporation  
a Delaware corporation

TX By: 

Name: Thomas P. Mahoney

Title: Vice President

STATE OF Colorado )

) ss.

COUNTY OF Denver )

On this 28<sup>th</sup> day of January, 2004, personally appeared before me, a Notary Public, Thomas P. Mahoney, Vice President of Newmont USA Limited, a Delaware corporation d/b/a Newmont Mining Corporation, who acknowledged to me that he executed the foregoing instrument on behalf of the corporation.

Vicki Engeman Kelley  
Notary Public

My Commission Expires: 7-16-2005



**EXHIBIT A**

**PROPERTIES**

Eureka County, Nevada

Township 31 North, Range 49 East, MDB&M

Section 7: E/2    320 acres

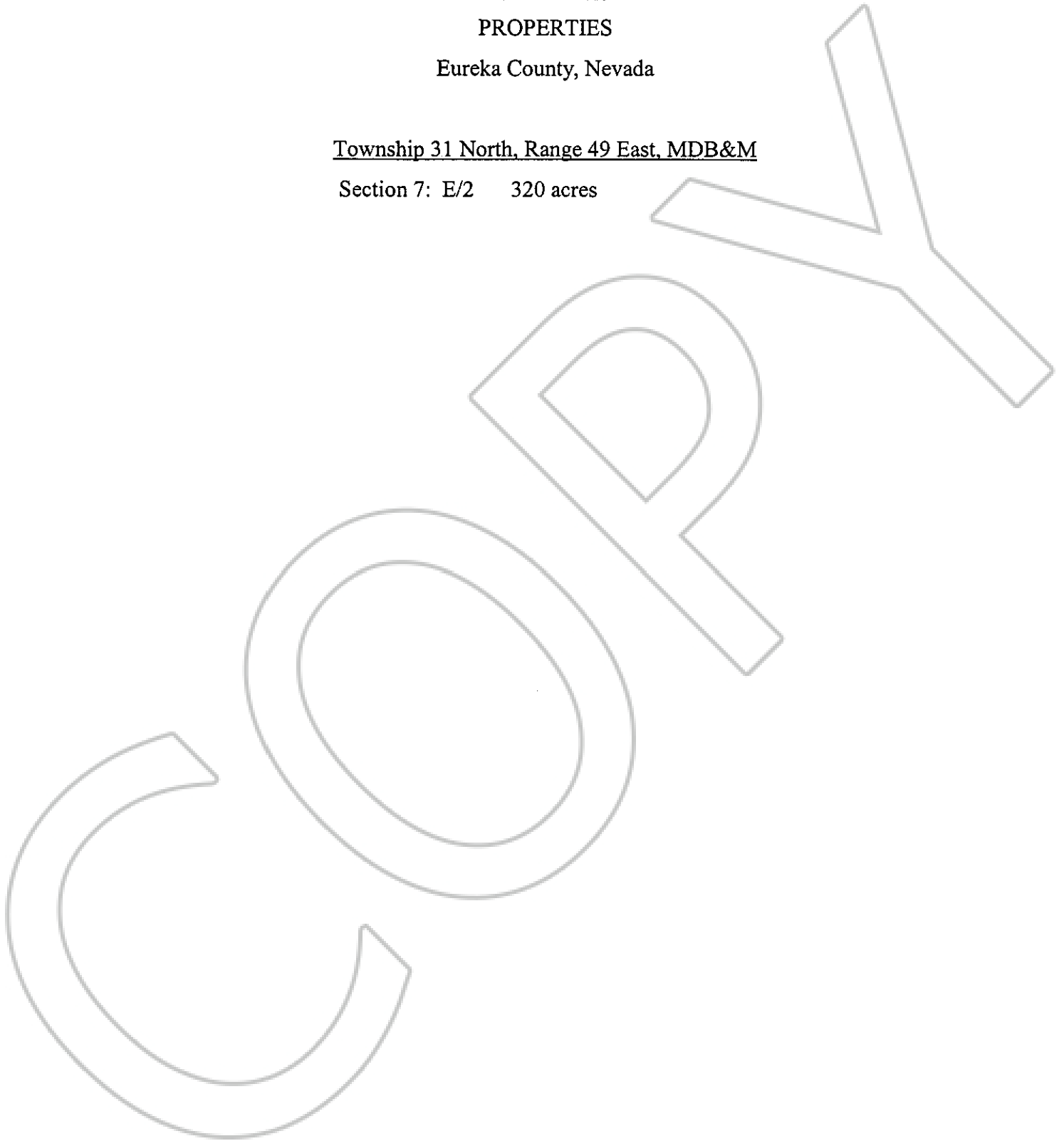

**185398**