

T25N



SCALE 1" = 500'



12

13

48

49

47

46

45

13

1,500' E-W

43

44

24

41

42

39

40

37

38

4,800' N-S

35

36

33

34

31

32

29

30

3,000' E-W

24

25

R48E
R48 1/2E

Tie: The SE Cor of FIL 30 is
2,139' S17°E from the NW Cor
of Sec 25, T25N, R48 1/2E

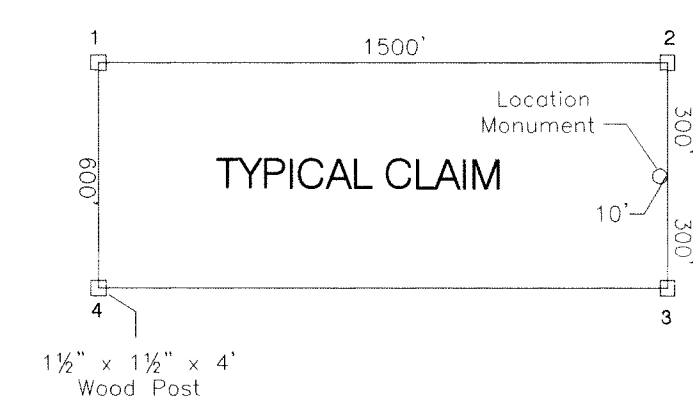

27

28

25

26

LOCATION DATES

FIL 1-49

11/7/03

LOCATOR

WHITE KNIGHT GOLD (US) INC
4790 CAUGHLIN PARKWAY #137
RENO, NEVADA 89509-0907

AMENDED MAP OF THE
FIL 1-49 LODE MINING CLAIMS
SECTIONS 13, 24, 25, 36, TWP 25N, RGE 48E, MBD&M
SECTIONS 24-25, 36 TWP 25N, RGE 48 1/2E, MBD&M
SECTION 1, TWP 24N, RGE 48 1/2E, MBD&M
EUREKA COUNTY
NEVADA

FILED AT THE REQUEST OF *White Knight Gold*
on *April 19* 20 *04* at *10* min past *8* A.M.
RECORDS OF EUREKA COUNTY, NEVADA M. N. REBALEATI, Recorder
File No. **186553** Fee \$ *14.00*