

2

1

6,600' E-W

11 13 15 17 19 21

1,500' N-S

SCALE 1" = 500'

0 1,500'

3,000' E-W

12 14 16 18 20 22 143 144 145 146 147

1,500' N-S

1,200' E-W

35 37 39 41 43 45 47 49 51

36 38 40 42 44 46 48 50 52

6,000' N-S

T23N

71 73 75 77 79 81 83 85 87

SEE PAGE 2

14

13

R49E

R50E

72 74 76 78 80 82 84 86 88

18

4,200' E-W

111 113 115 117 119 121 123 125 127 129 131 133 135 137 139 141

3,000' N-S

112 114 116 118 120 122 124 126 128 130 132 134 136 138 140 142

16,200' E-W

23

24

19

LOCATION DATES  
SUM 1-88 12/16/03  
SUM 89-147 12/17/03

LOCATOR  
WHITE KNIGHT GOLD (US) INC  
4790 CAUGHLIN PARKWAY #137  
RENO, NEVADA 89509-0907

### AMENDED MAP OF THE SUM MINING CLAIMS

SECTIONS 10 THRU 15 AND 22 THRU 24  
TOWNSHIP 23N, RANGE 49E, MDBM

&  
SECTIONS 18 & 19  
TOWNSHIP 23N, RANGE 50E, MDBM

EUREKA COUNTY  
NEVADA

FILED AT THE REQUEST OF White Knight Gold  
on April 19, 2004, at 11 min. past 8 A. M.  
RECORDS OF EUREKA COUNTY, NEVADA M. N. REBALEATI, Recorder  
File No. 186554 Fee \$ 15.00

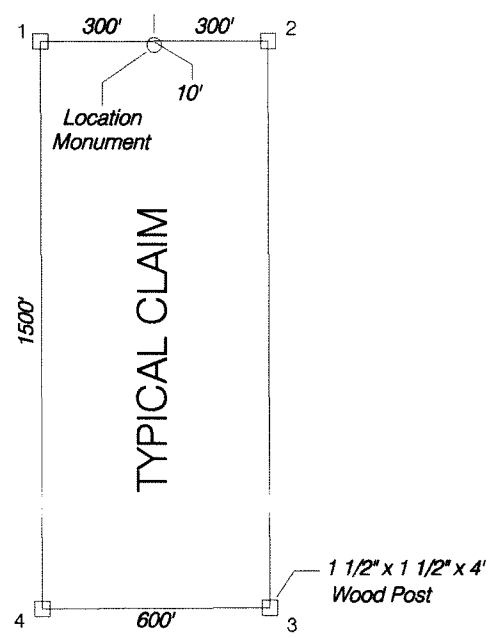
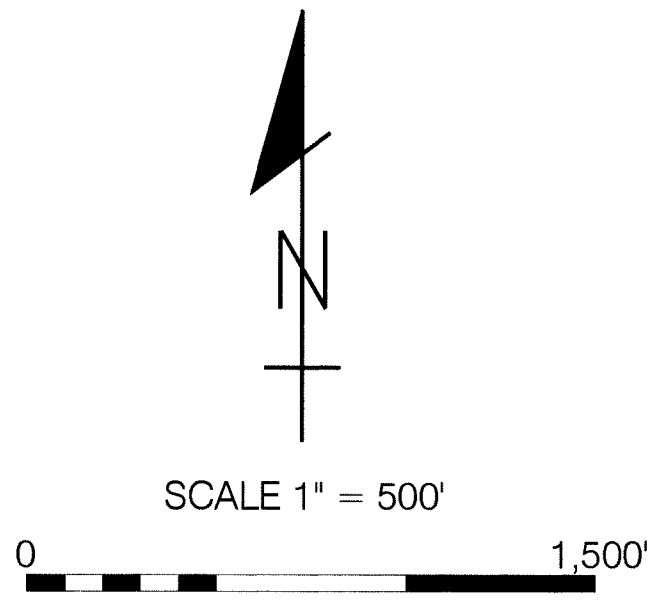

R49E

6,600' E-W

1 3 5 7 9 11 13

2 4 6 8 10 12 14 11

600' E-W

23 25 27 29 31 33 35 37

3,000' N-S

24 26 28 30 32 34 36 38

1,200' E-W

55 57 59 61 63 65 67 69 71 73

1,200' E-W

15

53 54 56 58 60 62 64 66 68 70 72 74

600' E-W

89 91 93 95 97 99 101 103 105 107 109 111 113

TIE: The NW Cor of SUM 90 is 204' S40°E from the SE Cor of Sec 16, T23N, R49E

3,000' N-S

90 92 94 96 98 100 102 104 106 108 110 112 114

16,200' E-W

21

22

23

SEE PAGE 1

T23N

16

14

AMENDED MAP OF THE  
SUM MINING CLAIMS

LOCATION DATES  
SUM 1-88 12/16/03  
SUM 89-147 12/17/03

LOCATOR  
WHITE KNIGHT GOLD (US) INC  
4790 CAUGHLIN PARKWAY #137  
RENO, NEVADA 89509-0907

SECTIONS 10 THRU 15 AND 22 THRU 24  
TOWNSHIP 23N, RANGE 49E, MDBM  
&  
SECTIONS 18 & 19  
TOWNSHIP 23N, RANGE 50E, MDBM  
EUREKA COUNTY  
NEVADA

FILED AT THE REQUEST OF *White Knight Gold*  
*April 19, 2004* at *11* mins. past *8 A.M.*  
RECORDS OF EUREKA COUNTY, NEVADA M. N. REBALEATI, Recorder  
File No. **186554** Fee \$ *15.00*