

FOUND SECTION CORNER

15 14 T2IN R54E
22 23
N 25 W
780 FT

NATIVE
TIMBER

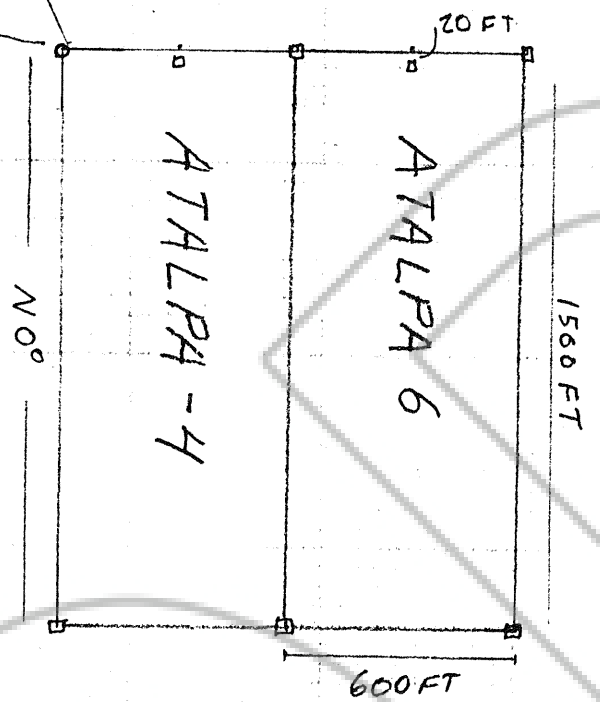

MAP
OF THE
ATALPA
CLAIMS
IN S.23 T2IN R54E
PHILLIPSBURG DISTRICT
EUREKA COUNTY
NEVADA

LOCATED 9/11/2004
BY: DAVE C. MOUGH
Box 1937
NEVADA CITY CA
95959

ALL POSTS 2IN X 2IN
WOOD EXCEPT AS
INDICATED -

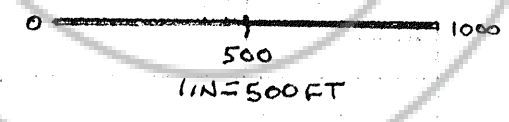

FILED AT THE REQUEST OF Dave C Mough
on Nov 15 20 04 at 44 mins. past 9 A M.
RECORDS of EUREKA COUNTY, NEVADA M. N. REBALEATI, Recorder
File No. 193772 Fee \$ 34.00