

MAP OF THE BEN (78-94) GROUP  
OF LODE CLAIMS

Unsurveyed Sections 4, 9-11, T22N, R50E, MDB&M  
Unknown mining district, Eureka County, Nevada

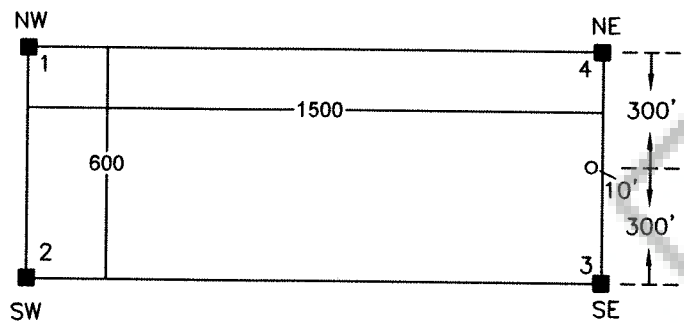

Typical Claim



Location Monument

All claims are 1500' long X 600' wide, EXCEPT Ben 87-90, which are 1250' long.  
All location monuments are set-in 10' from end lines EXCEPT  
location monuments for Ben 78, 87-90, & 94 which are 50' from end lines.  
All monuments are 2" X 2" wooden posts marked with metal tags.

Location Dates:  
Ben 79-82, 87-88 April 6, 2005  
Ben 78, 83-86, 91-94 April 7, 2005  
Ben 89-90 April 8, 2005

Locator:  
White Knight Gold (U.S.) Inc.  
121 Woodland Ave., #140  
Reno, NV 89523

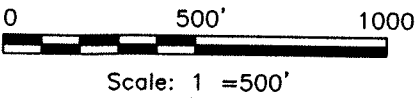

The NE corner of Ben 94 is approximately 5,551' at a bearing of  
N88°37'W from the NE corner of section 10, T22N R50E, MDBM

T22N R50E

The NE corner of Ben 90 is  
approximately 2,834' at a  
bearing of S36°53'E from  
the NE corner of section 10,  
T22N R50E, MDBM

Ben 94
Ben 93
Ben 92
Ben 91

Ben 78	Ben 85	Ben 86	Ben 90
	Ben 83	Ben 84	Ben 89
	Ben 81	Ben 82	Ben 88
	Ben 79	Ben 80	Ben 87