

# Eureka County Road Map

## MAIN ROADS

M-101 EUREKA-THOMPSONS (STATE ROUTE 46) [44.75 miles]  
M-102 HUNTER RANCH - NEWARK SUMMIT [7.43 miles]  
M-103 HIGHWAY 50 - DUCKWATER ROAD [11.52 miles]  
M-104 FISH CREEK RANCH - NYE COUNTY LINE [10.45 miles]  
M-105 ANTELOPE VALLEY ROAD [28.01 miles]  
M-106 MONITOR VALLEY ROAD [6.82 miles]  
M-107 BARTINE TO J.D. RANCH [43.79 miles]  
M-108 ROBERTS CREEK ROAD [13.86 miles]  
M-108A HENDERSON - ROBERTS CREEK ROAD [11.19 miles]  
M-109 SULFUR - THOMPSON (OLD PONY EXPRESS TRAIL) [11.31 miles]  
M-110 SADLER - SIRI - UNTION [39.02 miles]  
M-111 J.D. RANCH AND WEST [24.04 miles]  
M-112 J.D. RANCH - MINERAL STATION [7.06 miles]  
M-113 ALPHA - TONKIN [15.50 miles]  
M-114 GRASS VALLEY - CORTEZ - CRESCENT VALLEY [19.89 miles]  
M-115 DEAN - DANN - SPA [18.07 miles]  
M-116 BEOVAWE - GEYSER ROAD [7.17 miles]  
M-117 MAGGIE CREEK ROAD [11.67 miles]  
M-118 1ST [0.52 miles]  
M-119 3RD [4.00 miles]  
M-120 4TH [0.62 miles]  
M-121 6TH [3.27 miles]  
M-122 7TH [6.62 miles]  
M-123 9TH [7.88 miles]  
M-124 11TH [6.05 miles]  
M-125 12TH [3.04 miles]  
M-126 14TH [2.95 miles]  
M-127 15TH [2.00 miles]  
M-128 17TH [1.47 miles]  
M-129 COLLINGWOOD LANE [1.47 miles]  
M-130 EUREKA AIRPORT [0.26 miles]  
M-131 EAGLE STREET [1.55 miles]

TOTAL MAIN ROAD MILEAGE: 373.25 miles

## GENERAL ROADS

G-201 SPRING VALLEY [23.39 miles]  
G-201A MCCULLOUGH SPRINGS [26.94 miles]  
G-201B BOB BROWN [8.53 miles]  
G-202 GOODWIN CANYON [1.65 miles]  
G-203 DIAMOND MINE [2.80 miles]  
G-204 WINDFALL MINE [10.98 miles]  
G-204A RATTON CANYON [10.73 miles]  
G-204B WINDFALL CUTOFF [2.82 miles]  
G-205 FIORENTI RANCH [2.00 miles]  
G-206 FOUR EYED NICKS [2.49 miles]  
G-207 FISH CREEK - ARDAN RANCH [25.68 miles]  
G-207A COCKALORUM [8.29 miles]  
G-208 MILE WELL - 3C [13.82 miles]  
G-208A WHISTLER [13.23 miles]  
G-209 ARDAN WELL - 3C [7.08 miles]  
G-210 ARDAN SULLIVAN [1.36 miles]  
G-211 MARTIN RANCH [7.38 miles]  
G-212 FERGUSON RANCH [6.07 miles]  
G-213 FERGUSON - SANTA FE RANCH [3.45 miles]  
G-214 SANTE FE RANCH ROAD [5.18 miles]  
G-215 ROBERTS CREEK - SANTA FE RANCH [22.30 miles]  
G-215A 3 BAR TO LONE MOUNTAIN [15.84 miles]  
G-216 DIAMOND FOOTHILL [12.46 miles]  
G-217 OLD ARDAN RANCH [2.80 miles]  
G-218 COTTONWOOD [1.07 miles]  
G-219 SESTANOVICH ROAD [2.49 miles]  
G-220 RAND RANCH [2.21 miles]  
G-221 SLAGOWSKI RANCH [0.71 miles]  
G-222 SHEEP CREEK [19.65 miles]  
G-223 MINERAL HILL TO STATE ROUTE 278 [5.09 miles]  
G-223B FLYNN RANCH - TELEGRAPH CANYON [12.43 miles]  
G-224 JD RANCH TO KNIGHTS RANCH [7.07 miles]  
G-225 ALPHA TO JD RANCH [6.53 miles]  
G-226 WILLOW CREEK - NORTH [3.59 miles]  
G-226A PETE HANSON [5.09 miles]  
G-226B DRY CREEK [17.69 miles]  
G-227 HORSE RANCH [4.30 miles]  
G-228 ROSSI [8.55 miles]  
G-229 MCCLUSKEY [8.65 miles]  
G-230 BUCKHORN RANCH [26.00 miles]  
G-231 DANN - FRENCHIE [23.14 miles]  
G-231A DANN RANCH - BEOVAWE [20.71 miles]  
G-233 ROSE RANCH - BEOVAWE [13.85 miles]  
G-233A WILLOW CORRAL PASS [13.85 miles]  
G-233B GOLD SPRING POINT [7.09 miles]  
G-234 SANSINENA RANCH [1.42 miles]  
G-235 DUNPHY [0.49 miles]  
G-236 PALISADE - AIRPLANE SUMMIT [8.06 miles]  
G-236A MARY'S MOUNTAIN [6.16 miles]  
G-238 BARTH [5.38 miles]  
G-239 BAILEY PASS [5.38 miles]  
G-240 BRIGHAM LANE [0.12 miles]  
G-241 DESERT STREET [1.00 miles]  
G-242 DRY LAKE [2.53 miles]  
G-244 EL CENTRO [1.00 miles]  
G-245 EL PASO [1.00 miles]  
G-246 EL TORO [0.50 miles]  
G-247 FIRE CREEK ROAD [1.82 miles]  
G-248 FREDLORD CANYON [0.41 miles]  
G-249 FRONTIER STREET [3.98 miles]  
G-250 GOLD STREET [4.00 miles]  
G-251 TODD FARM ROAD [1.14 miles]  
G-252 KEG STREET [6.27 miles]  
G-253 LIPE ROAD [2.55 miles]  
G-254 MINOLETTI ROAD [0.27 miles]  
G-255 MOYLE ROAD [2.98 miles]  
G-256 MOYLE LANE [0.49 miles]  
G-257 MUSTANG ROAD [2.41 miles]  
G-257A NUGGET ROAD [1.48 miles]  
G-258 PANNING ROAD [1.51 miles]  
G-259 PRIMEAUX CANYON [0.21 miles]  
G-260 SELIM WAY [0.32 miles]  
G-260A RUBY LANE [0.12 miles]  
G-261 SIRRAH WAY [0.15 miles]  
G-262 TAYLOR LANE [0.07 miles]  
G-263 EASY STREET [0.27 miles]  
G-264 THIRD STREET CUTOFF [2.19 miles]  
G-265 ANDERSON RANCH ROAD [0.50 miles]  
G-266 20TH STREET [0.24 miles]  
G-267 INDUSTRIAL ROAD [0.97 miles]  
G-268 LARIAT [1.00 miles]  
G-269 EL RANCHO [0.25 miles]  
G-270 EL CAJON [0.25 miles]  
G-271 EL CAMINO [0.25 miles]  
G-272 EL GATO [0.25 miles]  
G-273 EL DORADO [0.50 miles]  
G-274 WEST 10TH STREET [0.30 miles]  
G-274A ROSE ROAD [0.08 miles]  
G-275 SHARROW CIRCLE [0.53 miles]

TOTAL GENERAL ROAD MILES: 508.62 miles

## MINOR ROADS

237 BOULDER VALLEY [21.73 miles]  
237A RODEO FLAT [12.37 miles]  
301 EAST ANTELOPE [11.24 miles]  
302 KELLY CREEK [1.76 miles]  
303 REYNOLDS CREEK [2.40 miles]  
304 FAULKNER CREEK [0.88 miles]  
305 CEDAR CREEK [0.88 miles]  
306 FOUR CORNERS [4.18 miles]  
307 HOG PEN CANYON [2.94 miles]  
307A HOG PEN CANYON [0.71 miles]  
308 FAIRGROUND ACCESS [0.77 miles]  
309 COTTONWOOD BYPASS [2.02 miles]  
310 BLACK POINT [1.60 miles]  
311 EAST 11TH [1.08 miles]  
312 WEST 18TH [0.89 miles]  
313 WEST 20TH [0.61 miles]  
314 DAVIS CANYON [1.21 miles]  
315 GARCIA FLAT [1.24 miles]  
316 RUTABAGA CREEK [2.27 miles]  
317 MARE FIELD [0.86 miles]  
319 ALLEN RANCH [0.97 miles]  
321 ISAACS RANCH [2.49 miles]  
322 BIG SPRING [0.48 miles]  
323 AIKEN SPRING - MINERAL HILL [2.56 miles]  
323A MINERAL HILL CEMETARY [0.24 miles]  
324 WILLOW SPRING [1.56 miles]  
325 COTTONWOOD CANYON [11.89 miles]  
326 KNIGHT RANCH TO PAPPY'S [5.76 miles]  
329 TRANSFER SITE [0.31 miles]  
330 MAIDEN'S GRAVE [3.81 miles]  
332 STITZEL PASS [5.68 miles]  
335 ACKERMAN CANYON [0.06 miles]  
336 RUBY LANE [0.12 miles]  
338 MORRISON RANCH [1.17 miles]  
339 KITCHEN MEADOW [3.67 miles]

TOTAL MINOR ROAD MILES: 112.72 miles

NOTE: Mileages are approximate.

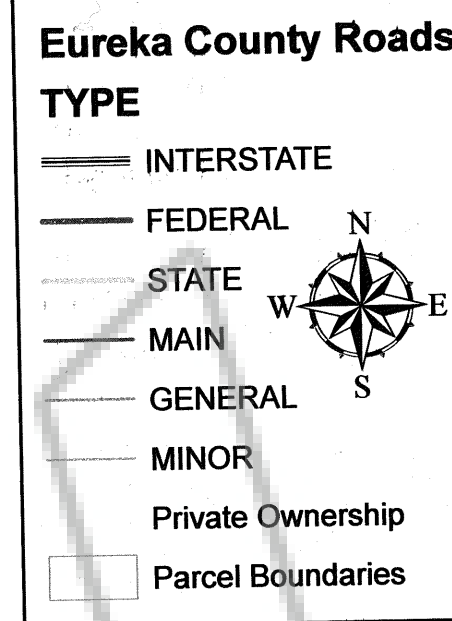
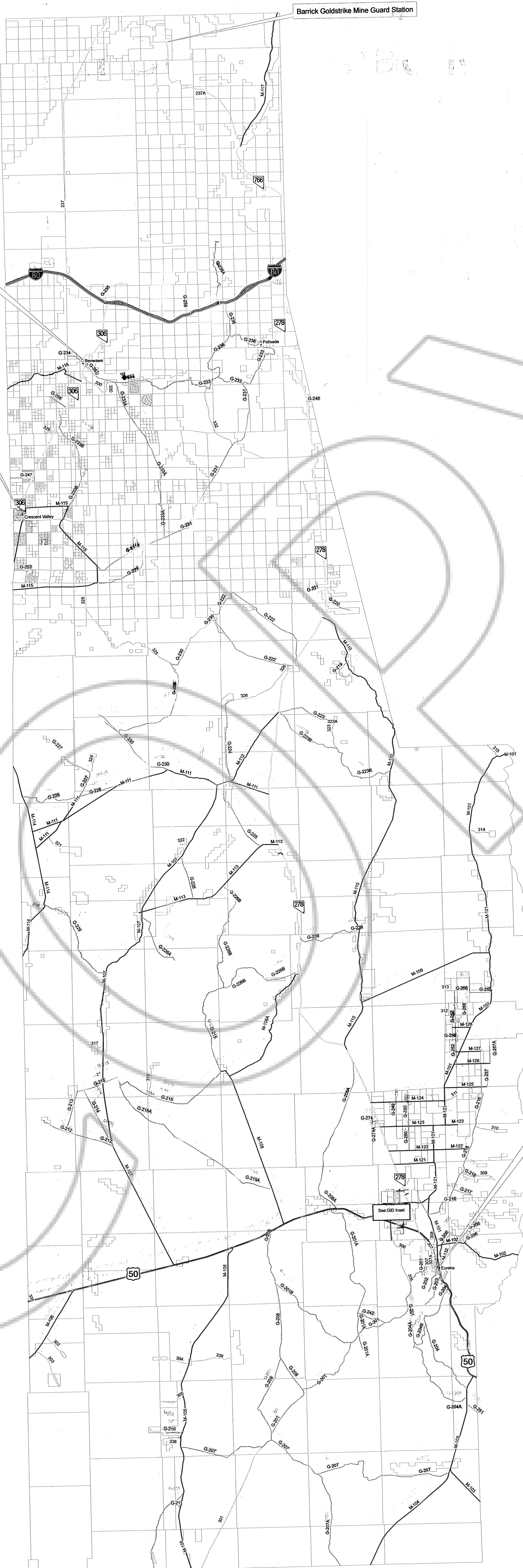

NOTE: This map is for display purposes only and does not represent a survey. Road data has been gathered utilizing GPS technology where available. Other data has been digitized to USGS DOQQ files (1995-97 series).

NRS 403.170 Designation of main, general and minor county roads; immunity of State and county from liability resulting from use of minor county roads; reclassification and abandonment of roads; hearing.

1. The board of county highway commissioners of each of the several counties of the State of Nevada shall:

(a) Lay out and designate which of the roads, generally termed public highways, are the most important to the people of the whole county and over which there is the greatest amount of general public travel and shall designate these roads as main county roads.

(b) Lay out and designate other roads of the county over which there is general public travel, and which are generally termed county roads, and shall designate these roads as general county roads.

(c) Lay out and designate other roads which are neither main nor general county roads but have been established by usage, or were constructed for use by the public, and shall designate these roads as minor county roads. This section does not require any maintenance for minor county roads. The State and the county are immune from liability for damages suffered by a person as a result of using any road designated as a minor county road.

2. The board of county highway commissioners may, from time to time, reclassify the roads and may lay out new roads of any class, or the board may change or abandon any roads termed as public highways.

3. The designation of a new road as a main county road, as a general county road or as a minor county road, or the reclassification of any road, or the abandonment of any road does not become effective until after a public hearing is held at which parties in interest and citizens have an opportunity to be heard. At least 10 days' notice of the time and place of the hearing must be published in a newspaper of general circulation in the county.

[1: Art. 4.257; 1913, 1919 RL p. 2903; NCL § 5375]—(NRS A 1979, 1173; 1993, 1999)

NRS 403.190 Map of county roads filed by board of county highway commissioners; authority of user to file map of minor county road; fees.

1. Except as otherwise provided in subsection 3, upon laying out and designating the county roads as required in NRS 403.170, the board of county highway commissioners shall cause a map of the county to be made, showing the county roads and their designations. The board shall file one copy of the map with the clerk of the board of county highway commissioners, one copy with the Department of Transportation, one copy with the county clerk and one copy with the county recorder.

2. When any road has been designated by the board of county highway commissioners as a standard county road, as provided in NRS 403.180, that designation must be made on the copies of the map on file with the clerk of the board of county highway commissioners, the county clerk, the Department of Transportation and the county recorder.

3. The board of county highway commissioners need not include a minor county road upon the map required by subsection 1. Any person who uses a minor county road upon the map by the person filing it. The map must:

(a) Be a topographical map prepared by the United States Geological Survey, unless the board of county highway commissioners determines that other specific maps are acceptable.

(b) Have written on its face, in black ink, the townships, ranges and sections through which the road traverses.

4. The map so filed is evidence of the existence and location of the road. Each person filing such a map shall pay to the county recorder a fee of \$17 for the first sheet of the map plus \$10 for each additional sheet.

[3: Art. 4.257; 1913, 1919 RL p. 2903; NCL § 5377]—(NRS A 1979, 1174; 1993, 1400; 2001, 3220)

This Eureka County Road map and the maps it explicitly refers to, showing the Main, General and Minor County Roads, updates all previously filed road maps. The designation of Main, General and Minor County Roads on this map is made pursuant to NRS 403.170 and NRS 403.190.

DATED this 21<sup>st</sup> day of November, 2005

Donna Bailey  
Chairman, Board of County Commissioners

Attest: Frances Gale  
Frances Gale, County Clerk

**RECORDER'S CERTIFICATE**

File Number 201710  
Filed at the request of the Eureka County Clerk.

DATED this 21<sup>st</sup> day of November, 2005  
TIME 3:16 p.m.

Michael Rebalati, by Isaac Stinson  
Michael Rebalati, Eureka County Recorder

Eureka Town  
See Map File #  
127447  
170339  
170173  
173053

