

SW

R 52 E

SE

SW

SE

T 35 N

Tie: From the NE corner of Dry #20, T35N, R52N Bear N118°49'E 436 Feet to the NE corner DRY #5

NW

NE

NW

NE

Tie: From the NE corner Section 30, T35N, R52N Bear S64°35'E 5805 Feet to the NW corner DRY #23

EUREKA COUNTY
ELKO COUNTY

30

29

SW

SE

SW

SE

16

17

18

19

20

21

22

32

33

NW

NE

NW

NE

31

41

42

43

44

45

46

47

48

49

50

51

52

53

54

55

56

57

58

59

60

61

62

63

64

65

66

67

Tie: From the SW corner Section 32, T35N, R52N Bear S17°15'W 155 Feet to the SW corner DRY #69

T 35 N

T 34 N

T 34 N

103

10

112

11

LOCATION DATES:

OCTOBER 5, 2005 ——— DRY (69-210).
OCTOBER 6, 2005 ——— DRY (1-67).

ALL CLAIMS ARE 600' WIDE X 1500' LONG UNLESS NOTED.
ALL LOCATION MONUMENTS ARE 5' IN FROM THE END CENTER UNLESS NOTED.
ALL LOCATION MONUMENTS AND CLAIM CORNERS ARE 2'X2'X4' WOOD POST.

- INDICATES A FOUND 1/4 CORNER (BRASS CAP).
- INDICATES A FOUND SECTION CORNER (BRASS CAP).

TIE POINTS:

FROM COR.#3 THE SE COR. OF DRY 210, BEAR N62°30'E 82 FEET TO THE SE CORNER OF SEC. 10, T34N, R52E, M.D.M.

FROM COR.#1 THE NW COR. OF DRY 139, BEAR S27°08'E 110 FEET TO THE NE CORNER OF SEC. 3, T34N, R52E, M.D.M.

FROM COR.#3 THE SE COR. OF DRY 102, BEAR N64°35'W 98 FEET TO THE NE CORNER OF SEC. 3, T34N, R52E, M.D.M.

FROM COR.#2 THE NE COR. OF DRY 5, BEAR S18°49'W 436 FEET TO THE NE CORNER OF SEC. 30, T35N, R52E, M.D.M.

FROM COR.#1 THE NW COR. OF DRY 23, BEAR N64°35'W 5805 FEET TO THE NE CORNER OF SEC. 30, T35N, R52E, M.D.M.

FROM COR.#1 THE NW COR. OF DRY 130, BEAR N53°57'W 6554 FEET TO THE SW CORNER OF SEC. 32, T35N, R52E, M.D.M.

FROM COR.#4 THE SW COR. OF DRY 59, BEAR N1°E 155 FEET TO THE SW CORNER OF SEC. 32, T35N, R52E, M.D.M.

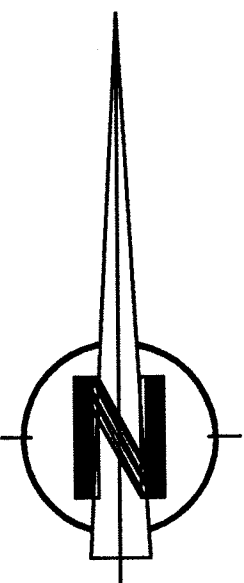

FILED AT THE REQUEST OF Red Star Gold
ON 10-29-05 AT 10:30 AM, 2005
RECORDS OF EUREKA COUNTY, NEVADA
J.M. REBALENTI, COUNTY CLERK
File No. 203054

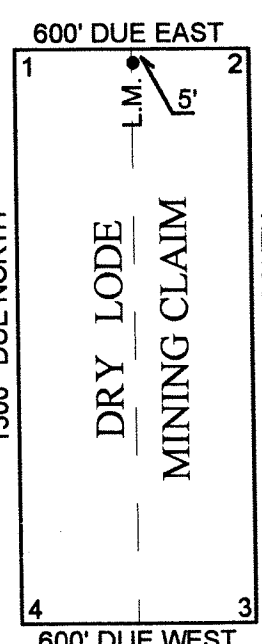
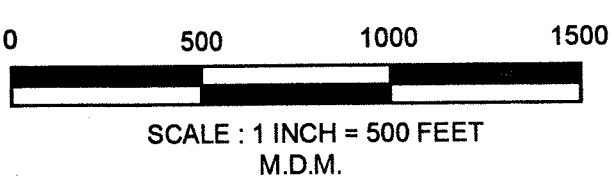

TYPICAL CLAIM & CORNER NUMBERS

REDSTAR GOLD USA INC.
3775 HEAVENLY VALLEY LANE
RENO, NEVADA 89509

DRY LODE MINING CLAIMS
NUMBERS [1-67], [69-210]
SECTIONS 28,30,32&34, T35N, R52E M.D.M.
SECTIONS. 2,4,&10, T34N, R52E M.D.M.
ELKO & EUREKA COUNTY, NEVADA