

2

6

TIE POINT DATA:  
THE SOUTHWEST CORNER OF WFW2 LIES APPROXIMATELY  
5,144 FEET EAST AND 14,988 FEET NORTH OF THE NORTHEAST  
CORNER OF SECTION 36, T.31N., R.50E., M.D.B.M.

LOCATION DATES:  
March 7, 2006 - WFW 2  
March 8, 2006 - WFW 6, 24

TIE POINT DATA:  
THE SOUTHWEST CORNER OF WFW6 LIES APPROXIMATELY  
6,344 FEET EAST AND 15,001 FEET NORTH OF THE NORTHEAST  
CORNER OF SECTION 36, T.31N., R.50E., M.D.B.M.

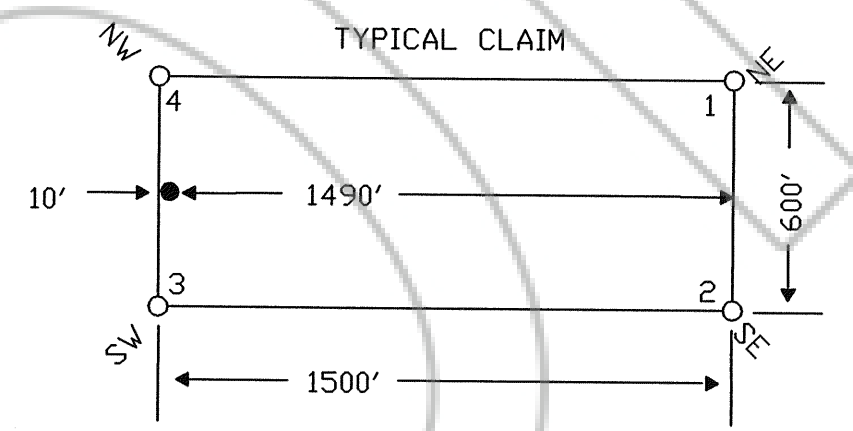

NOTES:  
LOCATION MONUMENTS SET 10' FROM CLAIM END  
CENTERLINES. ALL LOCATION MONUMENTS AND CLAIM  
POSTS ARE 2"x2"x4' WOODEN STAKES.  
DASHED SECTION LINES INDICATE PROJECTED SECTIONS.

TIE POINT DATA:  
THE NORTHEAST CORNER OF WFW24 LIES APPROXIMATELY  
7,325 FEET EAST AND 10,689 FEET NORTH OF THE NORTHEAST  
CORNER OF SECTION 36, T.31N., R.50E., M.D.B.M.

