

**NOTES:**

ALL LOCATION MONUMENTS AND CLAIM CORNERS ARE 2" x 2" x 4' WOOD.

LOCATION MONUMENTS ARE SET ON THE CENTERLINE OF EACH CLAIM.

20 FEET FROM THE NEAR ENDLINE AND 1480 FEET FROM THE OPPOSITE ENDLINE, EXCEPT:

ROY 2R IS SET 10 FEET FROM NEAR ENDLINE AND 1,490 FEET FROM OPPOSITE ENDLINE.  
ROY 3R IS SET 500 FEET FROM NEAR ENDLINE AND 1,000 FEET FROM OPPOSITE ENDLINE.  
ROY 4R IS SET 300 FEET FROM NEAR ENDLINE AND 1,200 FEET FROM OPPOSITE ENDLINE.  
ROY 5R IS SET 660 FEET FROM NEAR ENDLINE AND 840 FEET FROM OPPOSITE ENDLINE.  
ROY 6R IS SET 320 FEET FROM NEAR ENDLINE AND 1,180 FEET FROM OPPOSITE ENDLINE.  
ROY 7R IS SET 400 FEET FROM NEAR ENDLINE AND 1,100 FEET FROM OPPOSITE ENDLINE.  
ROY 11R AND 13R ARE SET 700 FEET FROM NEAR ENDLINE AND 800 FEET FROM OPPOSITE ENDLINE.  
ROY 12R IS SET 600 FEET FROM NEAR ENDLINE AND 900 FEET FROM OPPOSITE ENDLINE.  
ROY 28R - ROY 36R ARE SET 20 FEET FROM NEAR ENDLINE AND 980 FEET FROM OPPOSITE ENDLINE.

ALL CLAIMS ARE 1500' LONG BY 600' WIDE EXCEPT ROY 28R - 36R WHICH ARE 1000' LONG BY 600' WIDE.

BASIS OF BEARING: EAST LINE SECTION 30, T35N, R51E, MDM FROM THE SE CORNER AT N01°10'32"E TO THE EAST QUARTER CORNER.

**WITNESS CORNERS SET:**

- Roy 1R - WITNESS CORNERS SET 300 FEET EAST OF TRUE NE CORNER NO. 1 AND 900 FEET EAST OF TRUE NW CORNER NO. 4.
- Roy 2R - WITNESS CORNERS SET 180 FEET EAST OF TRUE NE CORNER NO. 1 AND 250 FEET SOUTH OF TRUE SE CORNER NO. 2 AND 300 FEET EAST OF TRUE NW CORNER NO. 4.
- Roy 3R - WITNESS CORNERS SET 80 FEET EAST OF TRUE NE CORNER NO. 1 AND 600 FEET SOUTH OF TRUE SE CORNER NO. 2 AND 250 FEET SOUTH OF TRUE SW CORNER NO. 3 AND 180 FEET EAST OF TRUE NW CORNER NO. 4.
- Roy 4R - WITNESS CORNERS SET 230 FEET NORTH OF TRUE SE CORNER NO. 2 AND 600 FEET SOUTH OF TRUE SW CORNER NO. 3 AND 80 FEET EAST OF TRUE NW CORNER NO. 4.
- Roy 5R - WITNESS CORNERS SET 230 FEET NORTH OF TRUE SE CORNER NO. 2 AND 230 FEET NORTH OF TRUE SW CORNER NO. 3.
- Roy 6R - WITNESS CORNERS SET 575 FEET NORTH OF TRUE SE CORNER NO. 2 AND 230 FEET NORTH OF TRUE SW CORNER NO. 3.
- Roy 7R - WITNESS CORNERS SET 350 FEET NORTH OF TRUE SE CORNER NO. 2 AND 575 FEET NORTH OF TRUE SW CORNER NO. 3.
- Roy 8R - WITNESS CORNER SET 350 FEET NORTH OF TRUE SW CORNER NO. 3.
- Roy 11R - WITNESS CORNER SET 250 FEET SOUTH OF TRUE NE CORNER NO. 1.
- Roy 12R - WITNESS CORNERS SET 600 FEET SOUTH OF TRUE NE CORNER NO. 1 AND 250 FEET SOUTH OF TRUE NW CORNER NO. 4.
- Roy 13R - WITNESS CORNERS SET 230 FEET NORTH OF TRUE NE CORNER NO. 1 AND 600 FEET SOUTH OF TRUE NW CORNER NO. 4.
- Roy 14R - WITNESS CORNERS SET 230 FEET NORTH OF TRUE NE CORNER NO. 1 AND 230 FEET NORTH OF TRUE NW CORNER NO. 4.
- Roy 15R - WITNESS CORNERS SET 575 FEET NORTH OF TRUE NE CORNER NO. 1 AND 230 FEET NORTH OF TRUE NW CORNER NO. 4.
- Roy 16R - WITNESS CORNERS SET 350 FEET NORTH OF TRUE NE CORNER NO. 1 AND 575 FEET NORTH OF TRUE NW CORNER NO. 4.
- Roy 17R - WITNESS CORNER SET 350 FEET NORTH OF TRUE NW CORNER NO. 4.

**TIE POINT:**

The SE corner of ROY 36R is located 141.77 feet S. 58°51'35"E. from the found SE corner of Section 30, T35N, R51E, M.D.M.

**OWNER:**

NEWMONT USA LIMITED d/b/a  
NEWMONT MINING CORPORATION  
555 FIFTH STREET  
ELKO, NEVADA 89801

**LEGEND:**

- = 2" x 2" x 4' WOOD POST CLAIM CORNER
- = 2" x 2" x 4' WOOD POST LOCATION MONUMENT
- ◆ = FOUND SURVEY MONUMENT

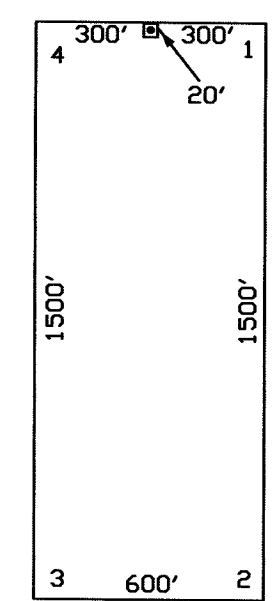
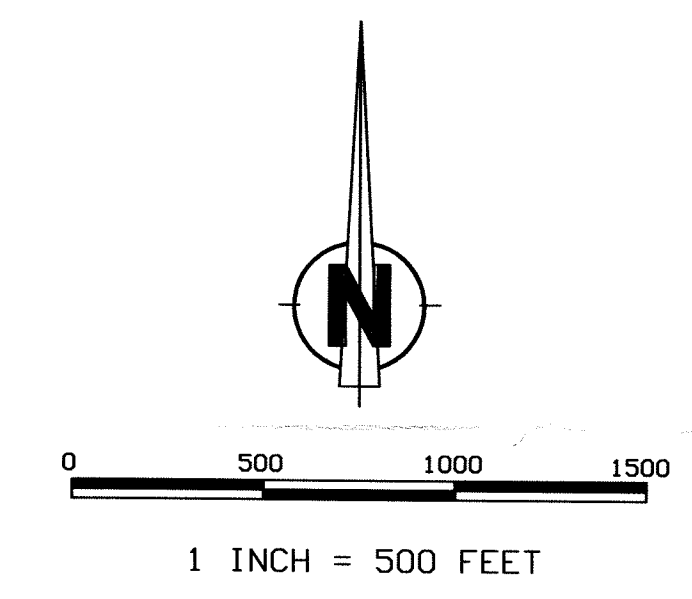

TYPICAL LODGE CLAIM  
UNLESS OTHERWISE SHOWN  
LOCATION MONUMENT MAY LIE AT EITHER END OF THE CLAIM

CLAIM MAP OF  
**ROY 1R - 36R**  
Lode Claims located within  
Sections 24 and 25,  
T35N, R50E, M.D.M.  
Sections 19, 20, and 29-32,  
T35N, R51E, M.D.M.  
Eureka County, Nevada

NEWMONT MINING CORPORATION

FILED AT THE REQUEST OF *Newmont Mining Corp*  
on 8/24/2016 at 5:55 mins. past 3:00 P.M.  
RECORDS OF EUREKA COUNTY, NEVADA  
J.A.N. REBALEATI, Recorder  
Fee \$ 544.00  
206017