

CORNER NUMBERING (TYPICAL)

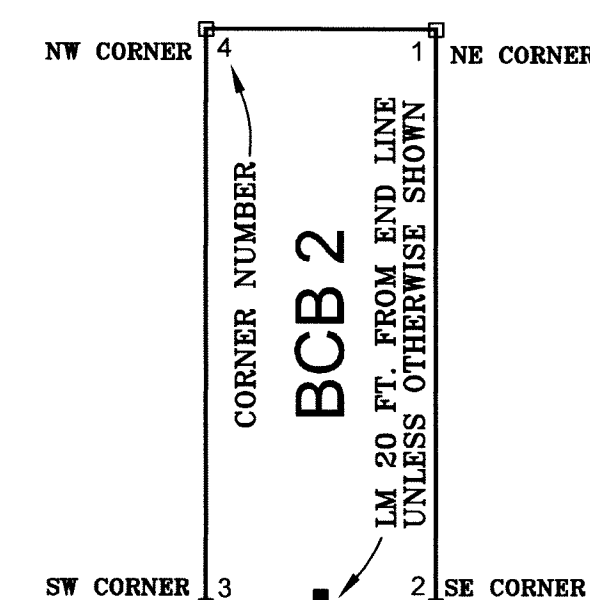

NOTES
 Section lines are approximate.
 1/4 Section lines are approximate.
 Source, Nevada BLM GCDB
 Basis of Bearings NAD27 NV SP East Zone

- LEGEND**
- Location Monument
1.5"x 1.5"x 4' long wood post
 - Claim Corner
1.5"x 1.5"x 4' long wood post
 - ◆ Found SECTION CORNER
GLO Brass Cap 1922 on iron pipe

DOC # 0208319
 Official Record
 Recording requested by:
 BARRICK GOLD U.S. INC.
 Eureka County - NV
 Mike Rebaletti - Recorder
 Fee \$304.00 Page 1 of 1
 gptt Recorded By: FEC
 Book- Page- 0000
 0208319

LOCATION DATES
 BCB 1 - 20: Jan. 14, 2007

LOCATOR: BARRICK GOLD U.S. INC.
 ADDRESS: 136 E. SOUTH TEMPLE, SUITE 1300
 SALT LAKE CITY, UT 84111

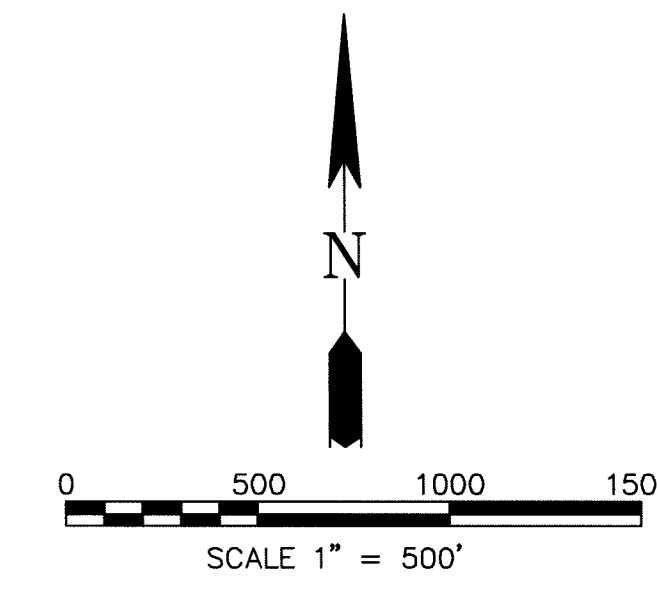

MAP OF LODGE CLAIMS
 BCB 1 THROUGH BCB 20

WITHIN
 SECTIONS 23, 24, 25, 26, 27,
 T26N, R49E, MDM

EUREKA COUNTY, NEVADA
 BARRICK GOLD U.S. INC.

SHEET 1 OF 1