

- : PRIVATE MINERAL BOUNDARY.
- : EXISTING CLAIM BOUNDARY.
- : SECTION LINE.
- : LODGE CLAIM LINE.
- : 4"x4" WOOD POST.
- : 2"x2 WOOD POST.

LOCATION DATE: MARCH 19TH, 2007.

500ft.
SCALE 1 INCH = 500 FEET

⊠: SECTION CORNER.

SECTION*19 SECTION*20

SECTION*21

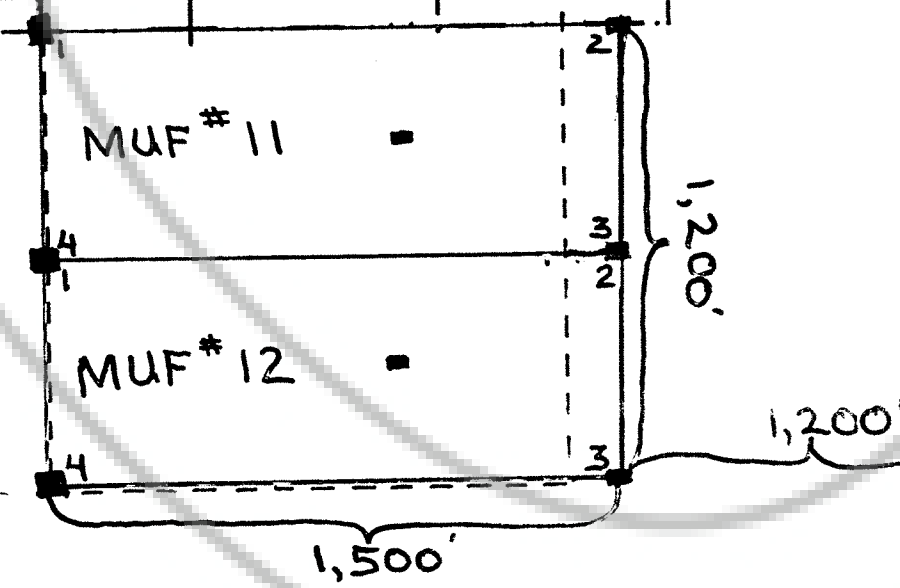
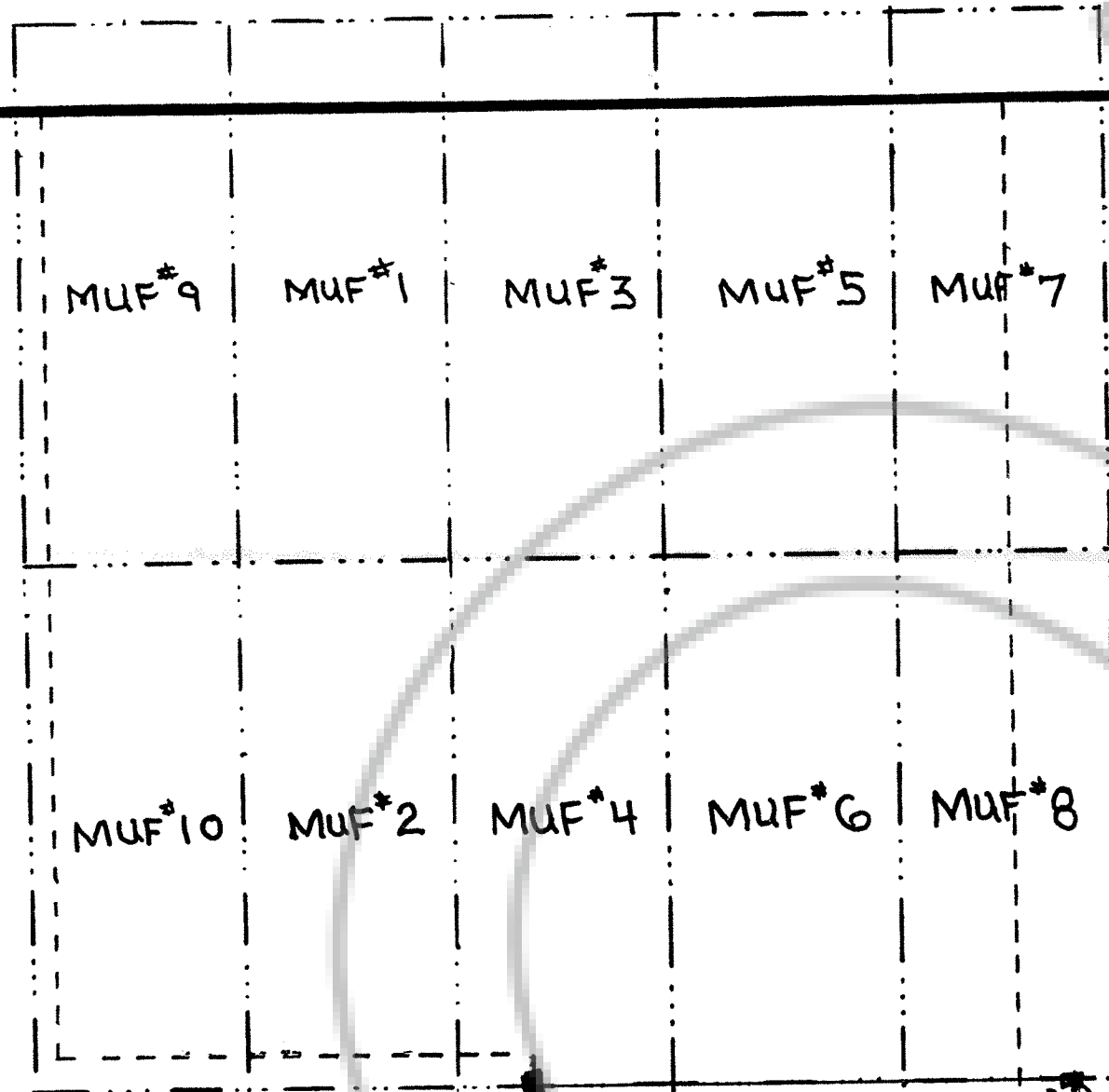

1,320'

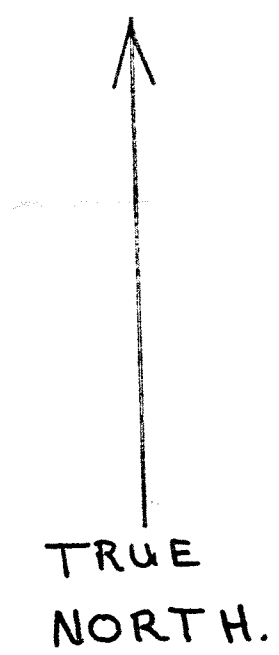
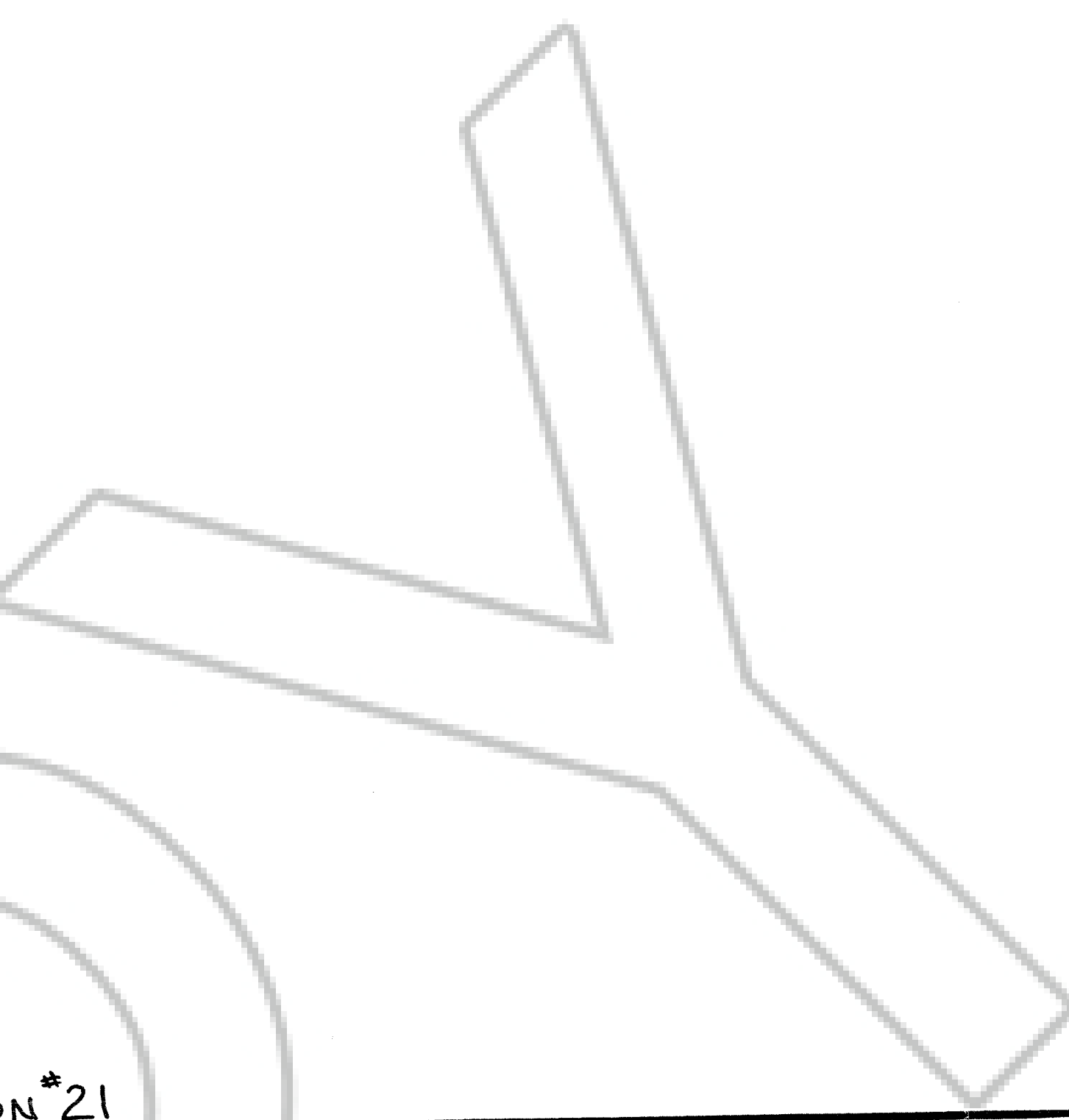

LOCATION: SECTION: *29
TOWNSHIP: *31 N.
RANGE: 51 E, M.D.M.

EUREKA COUNTY, NEVADA.

LOCATORS: CAMRON STITZEL AND DEAN STITZEL.

LOCATORS ADDRESS: HC-65, Box*1
CARLIN, NEVADA
89822

SECTION*30 SECTION*29

SECTION*28

SECTION*31

SECTION*32 SECTION*33

**CLAIM MAP OF
THE MUF*11 AND*12
LODE CLAIM GROUP,
AND EXISTING
MUF*1-10.**

DOC # 0208901
04/17/2007
Official Record
Recorded & Registered By
CAMRON STITZEL
Eureka County - NV
Mike Rebaletti - Recorder
Fee \$34.00 Page 1 of 1
Recorded By LLH
Book Page 0000

