

DOC # 0212407

08/28/2008

09:35 AM

Official RecordRecording requested By
BASIN & RANGE RESOURCES LLC

Eureka County - NV

Mike Rebaleati - Recorder

Fee: \$22.50

Page 1 of 1

RPTT:

Recorded By: FS

Book- 0476 Page- 0215

CERTIFICATE OF LOCATION
LODE MINING CLAIM**TO ALL WHOM IT MAY CONCERN:**

The undersigned hereby certifies that he has caused to be located the

RM 230

Lode Mining

Claim in the following quarter section(s):



0212407

RECORDER'S STAMP

1/4	Section	Township	Range	Meridian
NE	13	19N	53E	MDBM
NW	13	19N	53E	MDBM

In Eureka County, Nevada, on the 5th day of June, 2008.

Name and mailing address of locator is:

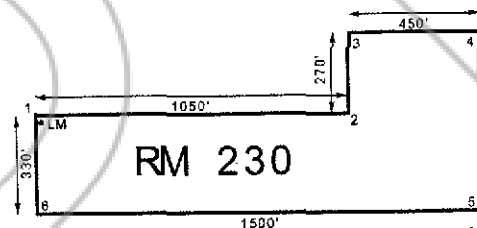
Basin & Range Resources, LLC.**1815 E. Winsett St.****Tucson, AZ 85719**

The Claim is approximately 1500 feet long and 600 feet wide, such that 1480 feet are claimed in a east direction and 20 feet in a west direction from the point of discovery (monument of location), at which the Notice of Location was posted, together with 300 feet on each side of the monument of location and center line of the Claim except where it borders private property along the Northwestern edge of the Claim in Section 13. The general course of the lode or vein is from the east to the west direction.

The number, location and markings on each corner monument are as follows:

No.	Location	Markings	Description
No. 1	NW	NW cor. of RM 230 & map	1 1/2" X 1 1/2" wooden posts
No. 2	N	South cor. Of North side of RM 230 & map	1 1/2" X 1 1/2" wooden posts
No. 3	N	North cor. of North side of RM 230 & map	1 1/2" X 1 1/2" wooden posts
No. 4	NE	NE cor. of RM 230 & map	1 1/2" X 1 1/2" wooden posts
No. 5	SE	SE cor. of RM 230 & map	1 1/2" X 1 1/2" wooden posts
No. 6	SW	SW cor. of RM 230 & map	1 1/2" X 1 1/2" wooden posts

As erected on the ground, each corner monument consists of 1 1/2" by 1 1/2" by 4' wooden posts marked with metal tags containing the claim name, corner location, and general location map. Location work consisted of making a claim map as provided in NRS 517.040

Dated the 5th day of June, 2008

SIGNATURE OF LOCATOR:

By

Agent for Basin And Range Resources, LLC / Chris Creel

Suggested Form - Nevada Division of Minerals (REV. 11/13/2006 LV)
Nevada Lode Notice of Location - NRS 517.010