

DOC # 0214299

12/04/2009

10:18 AM

Official Record

Recording requested By
RABO AGRIFINANCE INC

Eureka County - NV

Mike Rebaleati - Recorder

Fee \$16.00

Page 1 of 3

RPTT:

Recorded By: FES

Book- 496 Page- 0131

Drafted by:

John P. Manning V

Vice President and Counsel

Rabo Agrifinance, Inc.

One CityPlace Dr., Suite 200

St. Louis, MO 63141



WHEN RECORDED MAIL TO:
RABO AGRIFINANCE, INC.
ONE CITYPLACE DR., SUITE 200
St. LOUIS, MO 63141

Loan No. 20101909

**ASSIGNMENT OF NEVADA DEED OF TRUST
AND SECURITY AGREEMENT**

KNOW ALL MEN BY THESE PRESENTS: That U.S. Bank National Association as Custodian/Trustee, a National Association, having its principal office and post office address at 180 East Fifth Street St. Paul, MN 55101, party of the first part, in consideration of \$10.00 and other valuable consideration to it in hand paid by Rabo Agrifinance, Inc., whose address is One CityPlace Drive, Suite 200; St. Louis, MO 63141, the party of the second part, the receipt of which is hereby acknowledged, does hereby grant, bargain, sell, assign, and set over to said party of the second part, its successors and assigns, a certain Mortgage, Deed of Trust, Security Deed, Act of Mortgage, Trust Deed or similar instrument ("Mortgage") to Rabo Agrifinance, Inc. bearing the date of February 5, 2002, executed by Mark S. Moyle and Teresa Y. Moyle, as Co-Trustees of Mark & Teresa Moyle Family Trust dated December 23, 1999 to Lend Lease Agri-Business, Inc. situate in Eureka County, Nevada and filed for record on the 2nd day of February, 2002 in the records of Eureka County, Nevada, in Book 346 Page 107, together with all right, title, and interest to the premises described in said Mortgage and together with the Security Agreement and the Promissory Note therein described and the money due or to become due thereon, with interest, and together with all other instruments evidencing or securing repayment of the loan.

SEE ATTACHED EXHIBIT A, LEGAL DESCRIPTION

TO HAVE AND TO HOLD the same unto Rabo Agrifinance, Inc., its successors and assigns forever, subject only to the provisions contained in the said Mortgage.

IT BEING UNDERSTOOD AND AGREED, however, that this Assignment is made without recourse to and without covenant or warranty express or implied by the

said U.S. Bank National Association as Custodian/Trustee in any event whatsoever.

IN WITNESS WHEREOF, U.S. Bank National Association as Custodian/Trustee has caused these presents to be executed by its Attorney-in-fact for Rabo Agrifinance, Inc. by Shirley L. Dobbs, Vice President, at St. Louis County, Missouri effective as of the 25th day of March, 2009.

APPROVED



PRESENT BENEFICIARY:

U.S. BANK NATIONAL ASSOCIATION
AS CUSTODIAN/TRUSTEE

BY: Rabo Agrifinance, Inc.
Not personally, but as Attorney-In-Fact

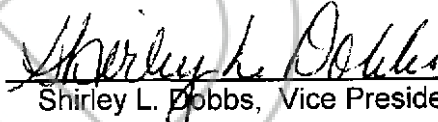
BY: 
Shirley L. Dobbs, Vice President

STATE OF MISSOURI)
) SS:
COUNTY OF ST. LOUIS)

BE IT REMEMBERED, that on this 6th day of November, 2009, before me, a Notary Public in and for the County and State aforesaid, personally appeared Shirley L. Dobbs, Vice President, of Rabo Agrifinance, Inc., a Delaware corporation, as Attorney-in-Fact for U.S. Bank National Association who is personally known to me to be the said officer of said corporation, and the same person who executed the foregoing instrument, and he duly acknowledged the execution of the same for and on behalf of and as the act and deed of said corporation as Attorney-in-Fact for U.S. Bank National Association.

IN WITNESS WHEREOF, I have hereunto subscribed my name affixed my official seal, on the day and year last above written.

Notary Public
Tammy R. Christopher
Name Printed

My commission expires: June 4, 2012

TAMMY R CHRISTOPHER
Notary Public - Notary Seal
State of Missouri
Commissioned for Jefferson County
My Commission Expires: June 04, 2012
Commission Number: 08568/08

EXHIBIT A

PARCEL 1:

PARCEL ONE (1) AS SHOWN ON PARCEL MAP FOR SANDRA CHANEY GREEN RECORDED JANUARY 23, 2002, IN THE OFFICE OF THE EUREKA COUNTY RECORDER'S OFFICE, EUREKA COUNTY, NEVADA, AS FILE NO. 177684.

PARCEL 2:

PARCEL ONE (1) AS SHOWN ON PARCEL MAP FOR MARK MOYLE FARMS, LLC RECORDED JANUARY 23, 2002, IN THE OFFICE OF THE EUREKA COUNTY RECORDER'S OFFICE, EUREKA COUNTY, NEVADA, AS FILE NO. 177683.

20501147

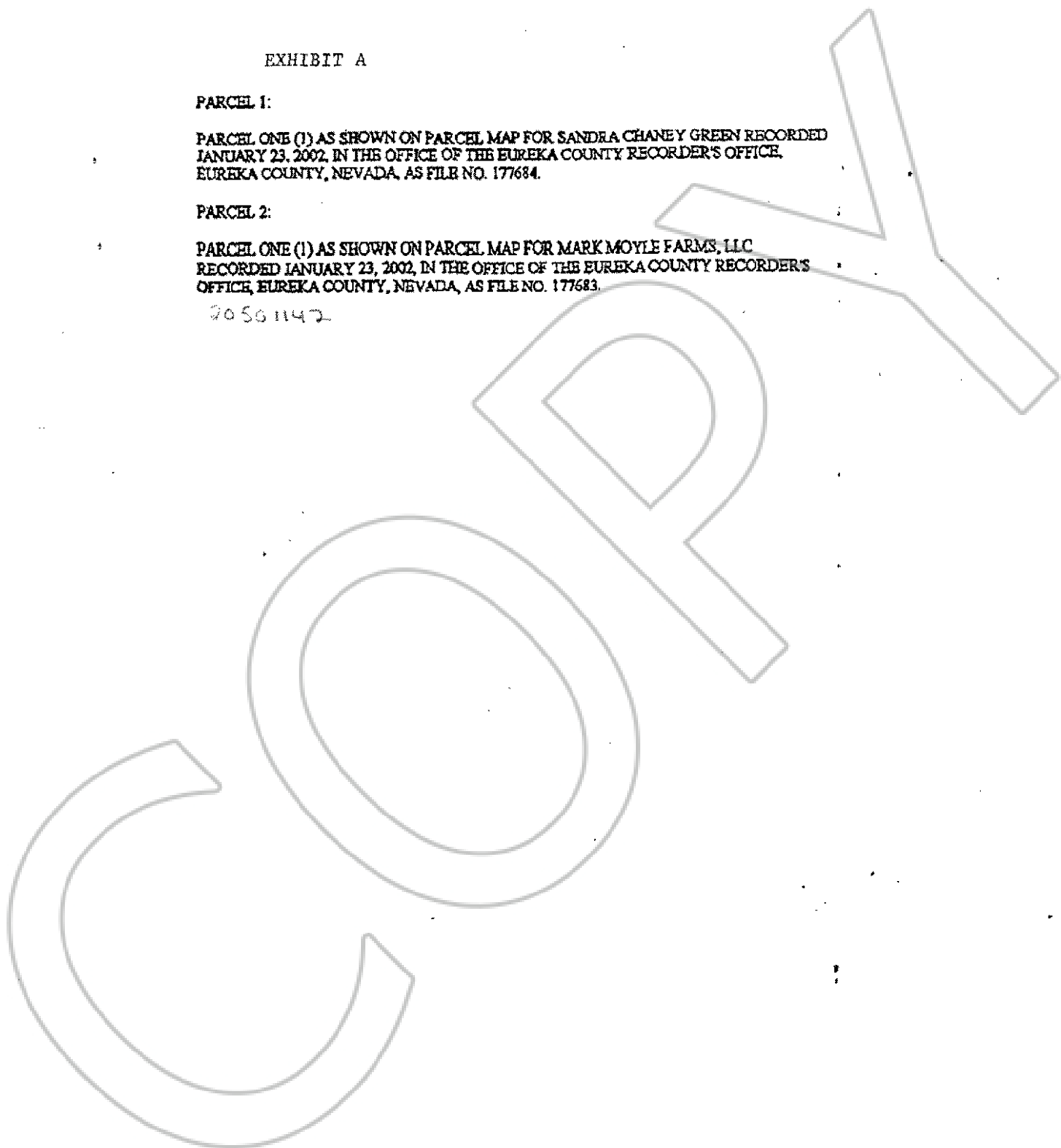

0214299

Book 496
Page 133

12/04/2009
Page 3 of 3