

All claims are tied into the surveyed SW corner of Section 35, T. 24N. - R. 51E., that lies approximately 203 ft west and 5,330 feet south of the NW corner ZK 103.

**THE ZK GROUP OF
LODE CLAIMS**
ZK 1-147, 153-210
(map 1 of 2)
Eureka County, Nevada
(Map 1 of 2)
scale 1:6000

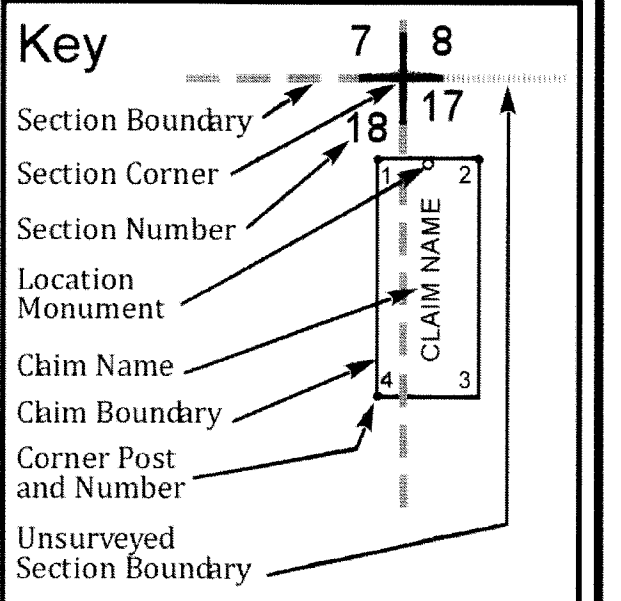
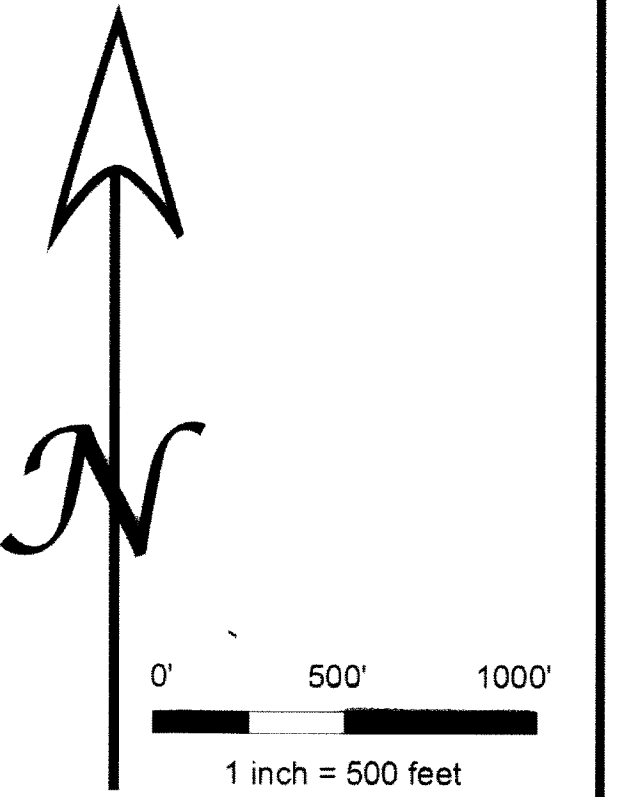

NOTES

- Claims were located on March 15 - 26, 2011 by Chris Creel, agent for Basin and Range Resources, L.L.C., 1815 E. Winsett St. Tucson, AZ 85719
- These claims lie in: Sections 1 and 12 of T 23N - R 51E, Sections 6, 7, and 18 of T 23N - R 52E, Sections 25, 26, 35, and 36 of T 24N - 51E, and Sections 30 and 31 of T 24N - R 52E, Mount Diablo Base and Meridian, Projection NAD 27, zone 11.
- The corner and location monuments are made of wooden posts at least 4 feet long, and marked with metal tags.
- Each claim is 1500' long and 600' wide, except where noted on the Certificate of Location and on this map.
- All claims are tied into the surveyed SW corner of Section 35, T. 24N. - R. 51E., that lies approximately 203 ft west and 5,330 feet south of the NW corner of ZK 103.
- Township, Range, and Section lines are adapted from Frazier Creek, NV and Garden Pass, NV, USGS 7.5 Minute, 1:24,000 scale Quadrangle. Portions of these maps may be unsurveyed and are indicated as such.

County Recorder Certificate

Filed for the record at the request of Basin and Range Resources, L.L.C., on this ___ day of _____, 2011.
DOC # 0217652
06/09/2011 03:06 PM
Official Record
Recording requested by: BASIN & RANGE RESOURCES, L.L.C.
Eureka County - NV
Mike Rebeleli - Recorder
Fee \$3,079.00 Page 1 of 2
Recorded By: FES
Book- Page- 0000
0217652

Basin and Range Resources, L.L.C.
1815 E. Winsett St. Tucson, AZ 85719
Office: 520.624.4153 Fax: 520.624.4192

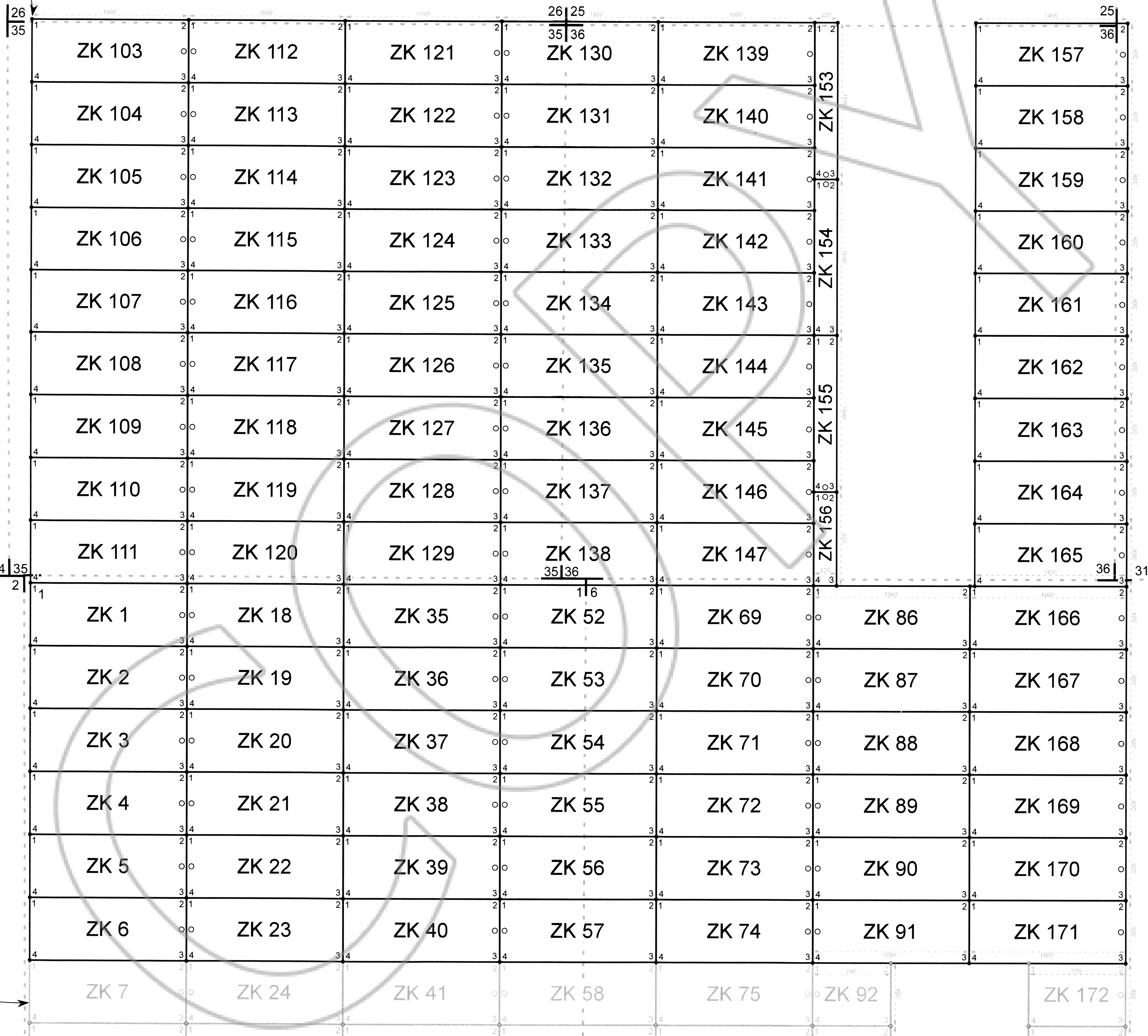

Claims shown in gray are presented on map 2 and shown here for reference only.

Claims shown in gray are presented on map 2 and shown here for reference only.

	ZK 6	ZK 23	ZK 40	ZK 57	ZK 74	ZK 91	ZK 171
1	ZK 7	ZK 24	ZK 41	ZK 58	ZK 75	ZK 92	ZK 172
4	ZK 8	ZK 25	ZK 42	ZK 59	ZK 76	ZK 93	ZK 173
1	ZK 9	ZK 26	ZK 43	ZK 60 ⁶ / ₇	ZK 77	ZK 94	ZK 174
4	ZK 10	ZK 27	ZK 44	ZK 61	ZK 78	ZK 95	ZK 175
1	ZK 11	ZK 28	ZK 45	ZK 62	ZK 79	ZK 96	ZK 176
4	ZK 12	ZK 29	ZK 46	ZK 63	ZK 80	ZK 97	ZK 177
1	ZK 13	ZK 30	ZK 47	ZK 64	ZK 81	ZK 98	ZK 178
4	ZK 14	ZK 31	ZK 48	ZK 65	ZK 82	ZK 99	ZK 179
1	ZK 15	ZK 32	ZK 49	ZK 66	ZK 83	ZK 100	ZK 180
4	ZK 16	ZK 33	ZK 50	ZK 67	ZK 84	ZK 101	ZK 181
1	ZK 17	ZK 34	ZK 51	ZK 68	ZK 85	ZK 102	ZK 182
4	ZK 183	ZK 187	ZK 191	ZK 195 ¹ / ₇ ¹² / ₁₈	ZK 199	ZK 203	ZK 207
1	ZK 184	ZK 188	ZK 192	ZK 196	ZK 200	ZK 204	ZK 208
4	ZK 185	ZK 189	ZK 193	ZK 197	ZK 201	ZK 205	ZK 209
1	ZK 186	ZK 190	ZK 194	ZK 198	ZK 202	ZK 206	ZK 210

T 23N R 51 E
T 23N R 52 E

**THE ZK GROUP OF
LODE CLAIMS**
ZK 1-147, 153-210
(map 2 of 2)
Eureka County, Nevada
(Map 1 of 2)
scale 1:6000

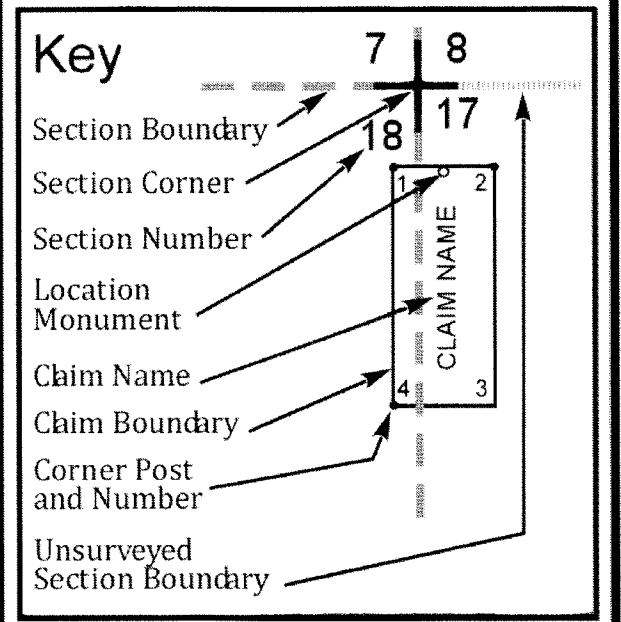
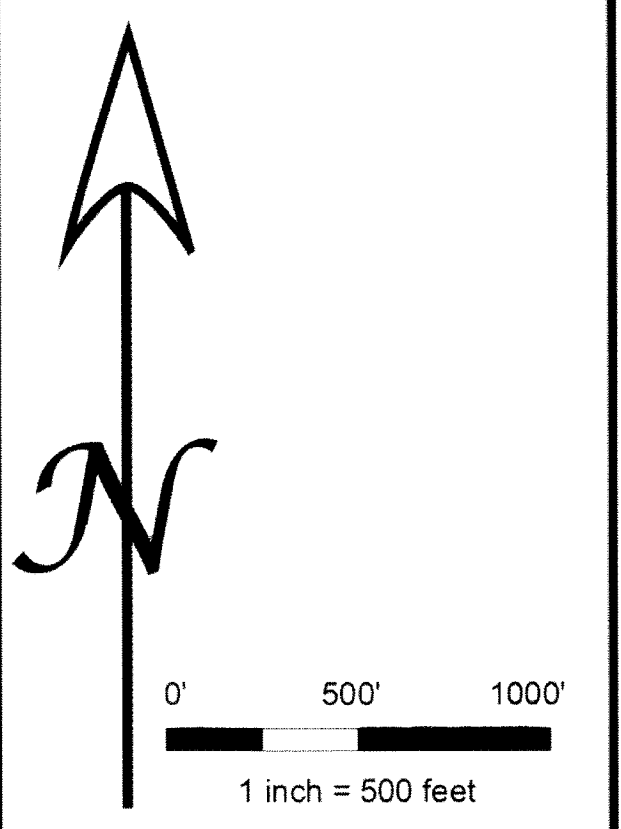

- NOTES**
- Claims were located on March 15 - 26, 2011 by Chris Creel, agent for Basin and Range Resources, L.L.C. 1815 E. Winslett St. Tucson, AZ 85719
 - These claims lie in: Sections 1, and 12 of T 23N - R 51E, Sections 6, 7, and 18 of T 23N - R 52E, Sections 25, 26, 35, and 36 of T 24N - R 51E, and Sections 30 and 31 of T 24N - R 52E, Mount Diablo Base and Meridian, Projection NAD 83, zone 11.
 - The corner and location monuments are made of wooden posts at least 4 feet long and marked with metal tags.
 - Each claim is 1500' long and 600' wide, except where noted on the Certificate of Location and on this map.
 - All claims are tied into the surveyed SW corner of Section 35, T 124N - R 51E, that has approximately 233 ft west and 5,330 feet south of the NW corner of ZK 103.
 - Township, Range, and Section lines are adapted from Frazier Creek, NV and Garden Pass, NV, USGS 7.5 Minute, 1:24,000 scale Quadrangle. Portions of these maps may be unsurveyed and are indicated as such.

County Recorder Certificate
Filed for the record at the request of Basin and Range Resources, L.L.C., on this ___ day of _____, 2011.
DOC # 0217652
06/09/2011 03:06 PM
Official Record
Recorded and Indexed by:
Eureka County - NV
Mike Rebaletti - Recorder
Fee \$3,079.00 Page 2 of 2
RPT- Recorder By: FES
Book- Page- 0000

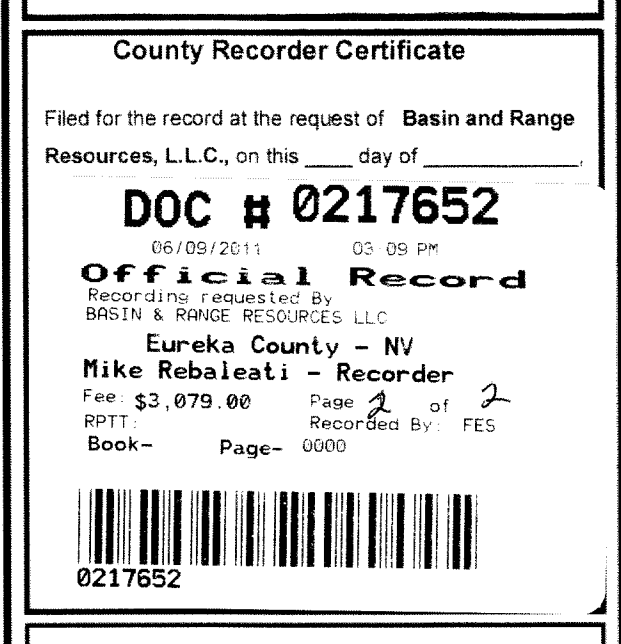

Basin and Range Resources, L.L.C.
1815 E. Winslett St. Tucson, AZ 85719
Office: 520.624.4153 Fax: 520.624.4192