

DOC # 0218342

08/05/2011

11:27 AM

**Official Record**

Recording requested By  
EUREKA MOLY

Eureka County - NV

Mike Rebaleati - Recorder

Fee: \$45.00

Page 1 of 7

RPTT:

Recorded By FES

Book- 520 Page- 0009

APN# \_\_\_\_\_

Recording Requested by:

Name Eureka Moly

Address 1726 Cole Blvd, Suite 115

City/State/Zip Lakewood, CO 80401



MEMORANDUM OF AGREEMENT

(Title of Document)

This page added to provide additional information required by NRS 111.312 Sections 1-2.  
(Additional recording fee applies)

This cover page must be typed or printed.

**MEMORANDUM OF AGREEMENT**

This Memorandum of Agreement is witness that Eureka Moly, LLC, a Delaware limited liability company, hereinafter referred to as EMLLC, of 1726 Cole Boulevard, Suite 115, Lakewood, Colorado, 80401 and Arizona Nevada Tower Corporation, a Nevada corporation, hereafter referred to as ANTC, of 6220 McLeod Drive, Suite 100, Las Vegas, Nevada, 89120, have entered into a Sub-Lease Agreement, subject to all conditions therein contained pertaining to the following described property, including access thereto, to-wit:

See Exhibit "1" consisting of 3 pages attached hereto and by this reference incorporated herein and made a part hereof.

EMLLC's address is:

Eureka Moly, LLC  
1726 Cole Boulevard, Suite 115  
Lakewood, CO 80401

Copy to: Michael K. Branstetter  
Hull & Branstetter Chartered  
P.O. Box 709  
Wallace, ID 83873

ANTC's address is:

Arizona Nevada Tower Corporation  
6220 McLeod Drive, Suite 100  
Las Vegas, Nevada, 89120



Duplicate originals of the Lease Agreement are held by both EMLLC and ANTC.

DATED this 21 day of June, 2011

Eureka Moly, LLC,  
a Delaware limited liability  
company

Arizona Nevada Tower Corporation  
Corporation, a Nevada corporation

By: Nevada Moly, LLC,  
a Delaware limited liability  
company, its manager

By: [Signature]  
Name: GEORGE PEEL  
Title: PRESIDENT

By: R Pennington  
Name: Robert I. Pennington  
Title: Vice President Engineering and  
Construction

STATE OF ~~NEVADA~~ ARIZONA  
County of ~~CLARK~~ PIMA ) ss.

On this 21~~st~~ day of June, 2011, before me, the undersigned, a Notary Public in and for the state aforesaid, personally appeared Robert I. Pennington, known or identified to me to be the Vice President of Engineering and Construction of EUREKA MOLY, LLC, and that he executed the foregoing instrument on behalf of said company, and acknowledged to me that such company executed the same.

IN WITNESS WHEREOF, I have hereunto set my hand and affixed my Notarial seal the day and year in this certificate first above written.

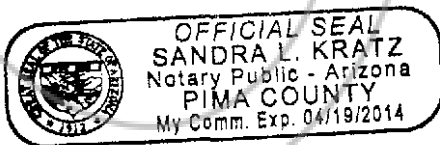

Sandra L. Kratz  
Notary Public in and for the State of ARIZONA  
Residing at: 313 E. SUFFOLK DR. TUCSON  
My Commission expires: 4-19-2014



STATE OF NEVADA )  
 ) ss.  
County of CLARK )

On this 21<sup>st</sup> day of JUNE, 2011, before me, the undersigned, a Notary Public in and for the state aforesaid, personally appeared GEORGE PEEL, known or identified to me to be the PRESIDENT of ARIZONA NEVADA TOWER CORPORATION, and that he executed the foregoing instrument on behalf of said corporation, and acknowledged to me that such corporation executed the same.

IN WITNESS WHEREOF, I have hereunto set my hand and affixed my Notarial seal the day and year in this certificate first above written.

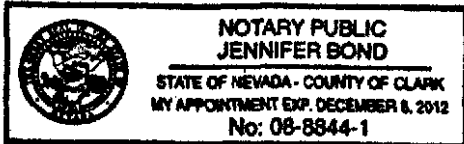

Jennifer Bond  
Notary Public in and for the State of NEVADA  
Residing at: 5202 Alhambra St. Las Vegas, NV 89120  
My Commission expires: 12/8/12

MEMORANDUM OF AGREEMENT - 3

TRIANGLE SURVEYING INC.  
5170 E. MANSE  
PAHRUMP, NEVADA 89061

ANTC  
1631 E. SUNSET ROAD STE. C114  
LAS VEGAS, NEVADA 89119-4961

FAA-1-A SURVEY CERTIFICATE

REF: MT. HOPE

PROPOSED TOWER SITE

Latitude: 39°47'28.18" N  
Longitude: 116°10'7.44" W  
Base Elevation: 7,355'

"THIS IS TO CERTIFY THAT THE ABOVE REFERENCED  
COORDINATES AND ELEVATIONS FOR THE PROPOSED  
TOWER INSTALLATION AT THE REFERENCED SITE  
MEET 1-A ACCURACY TOLERANCES" (20 feet horizontal  
and 3 feet vertical)

CONTROL DATUM

Latitude/Longitude NAD 83  
Ground Elevation NAVD 88



7 DEC 10

Exhibit "1"  
Page 1 of 3



0218342

Book 520 08/05/2011  
Page 13 Page 5 of 7

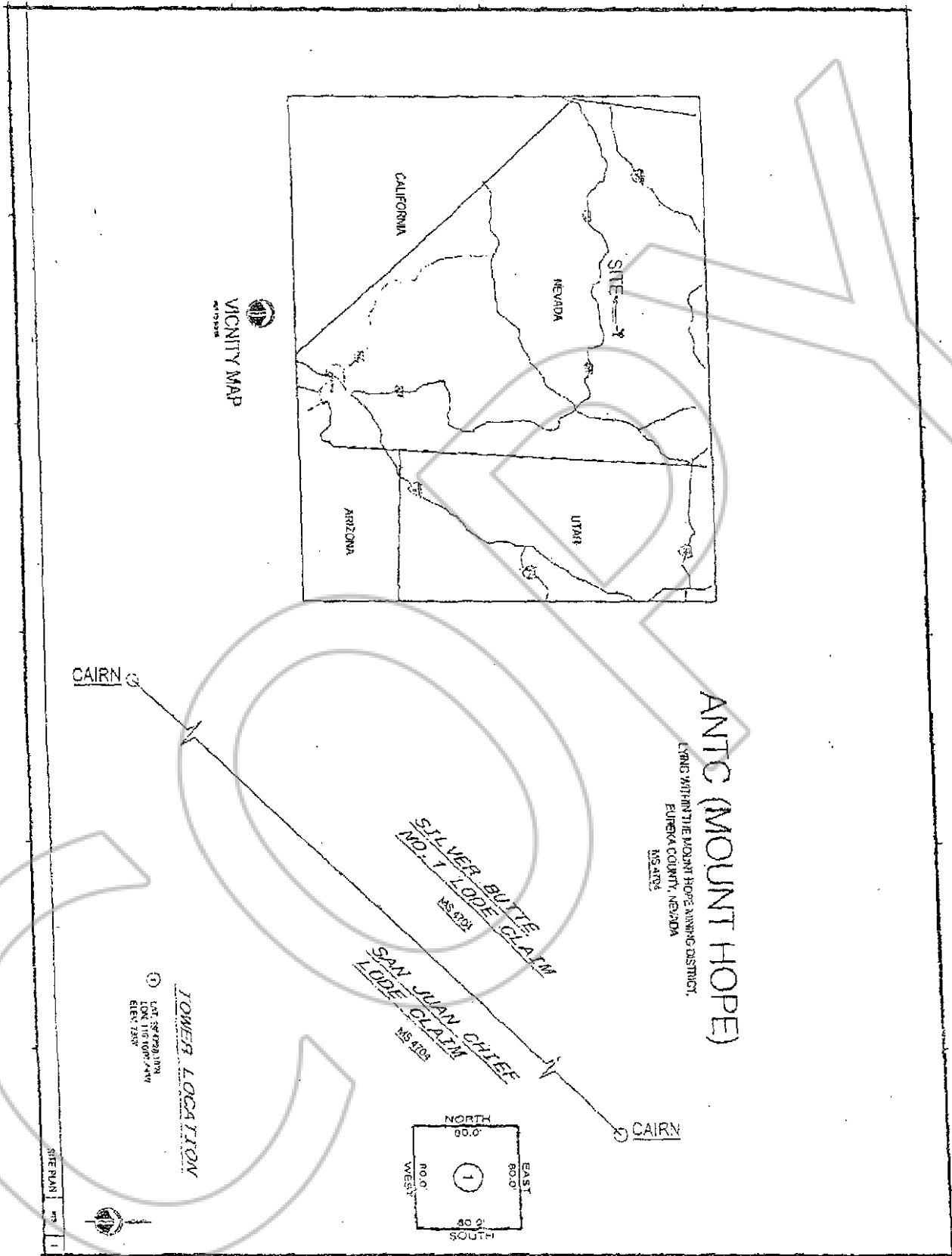

SHEET NO. 1 SITE PLAN	PROJECT NO. 1085 MOUNT HOPE EUREKA COUNTY, NEVADA	TOWER LOCATION VICINITY MAP	PROJECT Arizona Nevada Tower Corp.	DATE 08/05/2011
--------------------------	--	--------------------------------	---------------------------------------	--------------------

Exhibit "1" Page 2 of 3



*ap*

SUB-LEASE SITE DESCRIPTION

MT. HOPE III

05-23-11

The land referred to herein is situated in the State of Nevada, County of Eureka, described as follows:

That portion of the San Juan Chief Lode Mining Claim, designated by the Surveyor General as Survey No. 4704, embracing a portion of, approximately, Section 13, Township 22 North, Range 51 1/2 East, M.D.B.&M, and Sections 7 and 18, Township 22 North, Range 52 East, M.D.B. & M., in the Mt. Hope Mining District, as described in patent executed by the United States of America, recorded November 16, 1934 in Book 21, Page 217, Deed Records of Eureka County, Nevada being more particularly described as follows:

An eighty (80.00') foot square site, having sides bearing South, West, North and East, the center of which is approximately located at Latitude 39°47'28.18"North, Longitude 116°10'07.44" West, NAD83. Containing 6,400 square feet, more or less.

Exhibit "1"  
Page 3 of 3



0218342

Book 520  
Page 15

08/05/2011  
Page 7 of 7