

UNSURVEYED  
**30**

UNSURVEYED  
**29**

UNSURVEYED  
**28**

UNSURVEYED  
**31**

UNSURVEYED  
**32**

UNSURVEYED  
**33**

ALL SECTION LINES APPROX.

T27N R49E (UNSURVEYED)

ALL SECTION LINES APPROX.

T26N R49E

ALL SECTION LINES APPROX.

**6**

**5**

**4**

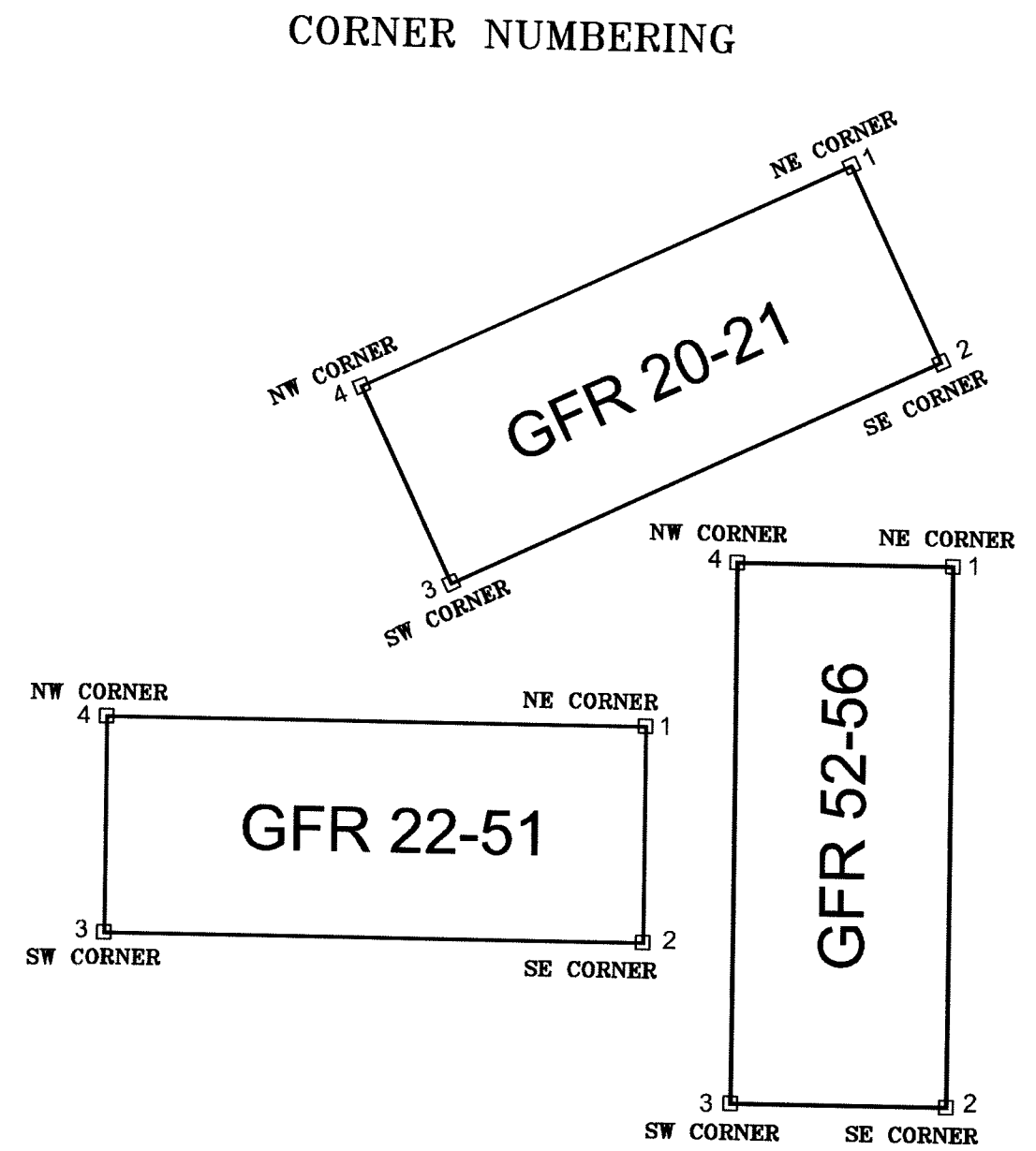

- LEGEND**
- Location Monument  
1.5"x 1.5"x 4' long wood post with vial/notice and scribed aluminum tag.  
10' FROM ENDLINE UNLESS OTHERWISE NOTED.
  - Claim Corner  
1.5"x 1.5"x 4' long wood post with scribed aluminum tag attached
- UNSURVEYED Govt. Surveys do not exist for Sections

**LOCATION DATES:**  
 10/06/2011 = GFR 20-36, 38, 39, 43, 46, 49, 52-56  
 10/07/2011 = GFR 37, 40-42, 44, 45, 47, 48, 50, 51

**LOCATOR:** BARRICK GOLD U.S. INC.  
**ADDRESS:**  
 136 E. SOUTH TEMPLE, SUITE 1800  
 SALT LAKE CITY, UT 84111

**DOC # 0219345**  
10/29/2011 11:00 AM  
**Official Record**  
 Recording requested by  
 BARRICK GOLD U.S. INC.  
 Eureka County - NV  
 Mike Rebaletti - Recorder  
 Fee \$559.00 Page 1 of  
 8/11 Recorded By: FES  
 Book- Page- 0000

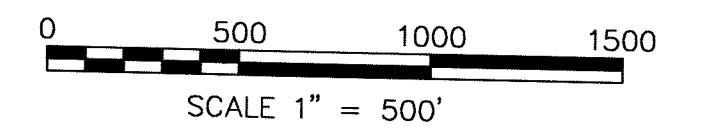

**MAP OF LODE CLAIMS  
 GFR 20 THROUGH 56**  
 WITHIN  
 SECTIONS 4 AND 5 T26N, R49E,  
 AND UNSURVEYED  
 SECTIONS 28, 29, 32, AND 33, 27N, R49E,  
 MDM, EUREKA COUNTY, NEVADA

**BARRICK GOLD U.S. INC.**

TIE POINT, FOUND NE (CC) COR. SEC. 1, T26N, R48E  
 BLM BRASS CAP STAMPED 1957

TIE TO SW COR. GFR 28  
 N62°34'16"E 11199'  
 BASIS OF BEARING NAD83

TIE TO NW COR. GFR 20  
 N67°10'37"E 9829'

N64°31'00"E 1500'  
 N25°39'00" W 500'  
 S54°31'00"E 600'  
 N43°59'00" W 600'  
 N43°59'00" W 600'  
 S64°31'00"E 1500'

**GFR 20**  
 300SW 1200NE  
 SIZE 500x1500

**GFR 21**  
 800SW 700NE

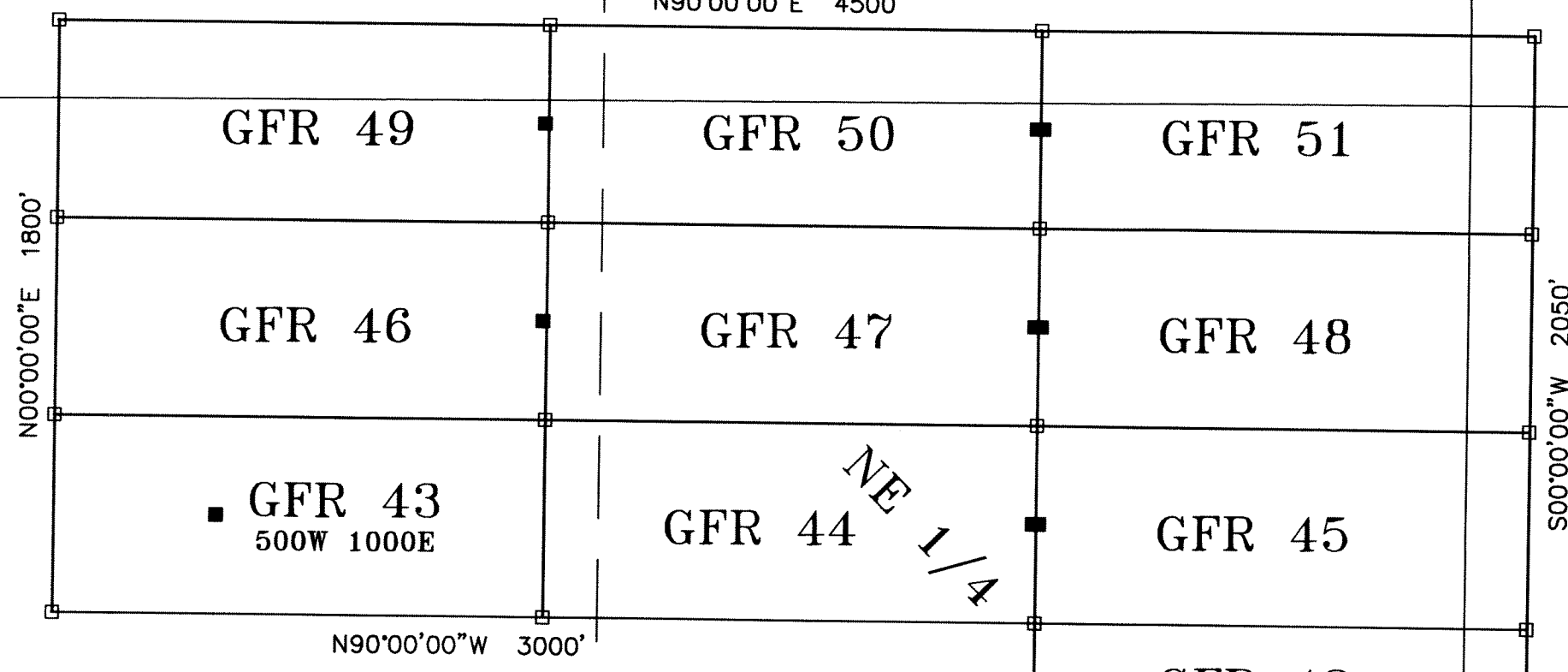

**GFR 42**  
 200W 1300E  
 SIZE 550x1500

**GFR 41**  
 200W 1300E

**GFR 40**  
 200W 1300E

**GFR 37**  
 200W 1300E

