

DOC # 0219497

02/03/2012 01:30 PM  
**Official Record**  
Recording requested by  
ARDEN LARSON

Eureka County - NV  
Mike Rebaletti - Recorder  
Fee: \$64.00 Page 1 of  
RPT: Recorded By: FES  
Book- Page- 0000

Map of  
K 9 - 12 Lode Mining Claims  
in Sections 27 and 28, T25N, R52E, MDB&M  
Eureka County, Nevada



0219497

**LOCATOR**  
Arden L. Larson  
P.O. Box 1893  
Grand Junction, Colorado 81502

21 22  
28 27

**NOTES**

All corners and location monuments are 2 x 2 x 4' wood posts with aluminum tags inscribed with the claim name and corner position.

All claims are 600' x 1500' with location monuments offset 10' from end-centers as shown.

The section lines shown are taken from the 1976 BLM protraction diagram No. 164

**LOCATION DATES**

K 9-12: November 10, 2011

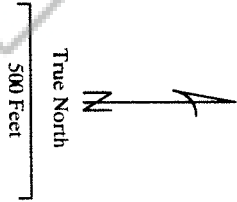

NW/4 NE/4  
28  
SW/4 SE/4

NW/4  
SW/4

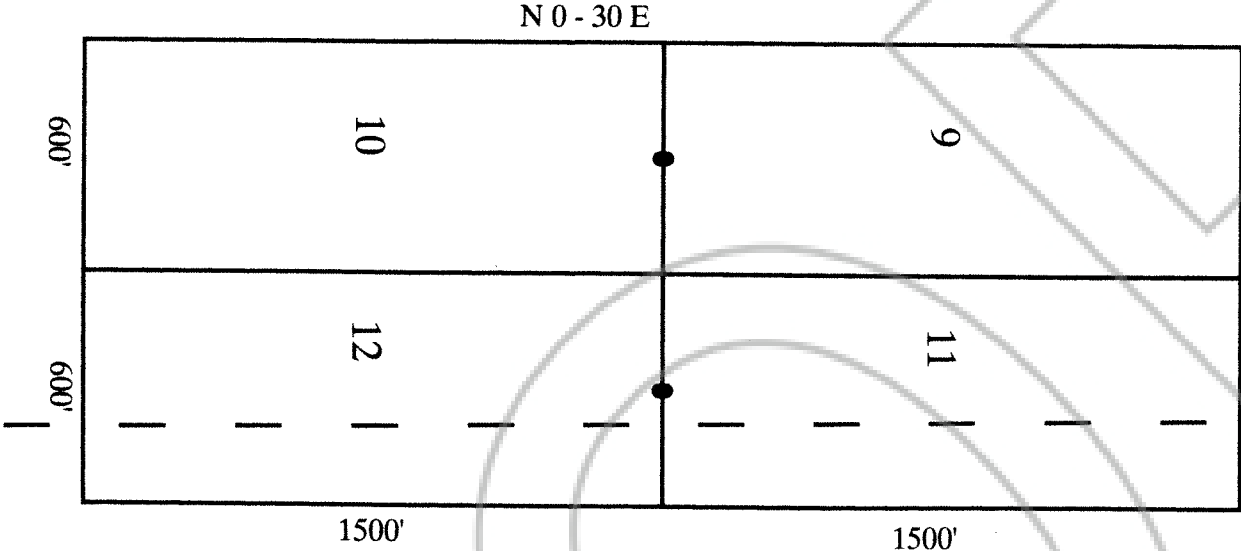

**CLAIM TIE**

All claims are tied to the SW corner of Section 31, T25N, R52E, MDB&M, which is also the township corner, being a rock cairn and t-post found at GPS Nad 27 LL coordinates of 39 deg 59' 48.92"N, 116 deg 09' 29.378"E, which is 4' N and 3' W of record position as shown on the 1976 BLM Protraction Diagram No. 164.

The NW corner of K 9 is 9,127' North and 14,872' East of the SW corner of Section 31 as described above.

T25N-R52E

28 27  
33 34