

DOC # 0220337

05/07/2012 02:14 PM

Official Record

Recording requested By
NEVADA NORTH RESOURCES (USA), INC

Eureka County - NV

Mike Rebaieati - Recorder

Fee \$19.00

Page 1 of

RPTT

Recorded By FES

Book-

Page- 0000



0220337

SEC5, T25N, R50E

SWC4, T25N, R50E

NEC8, T25N, R50E

NWC9, T25N, R50E

4

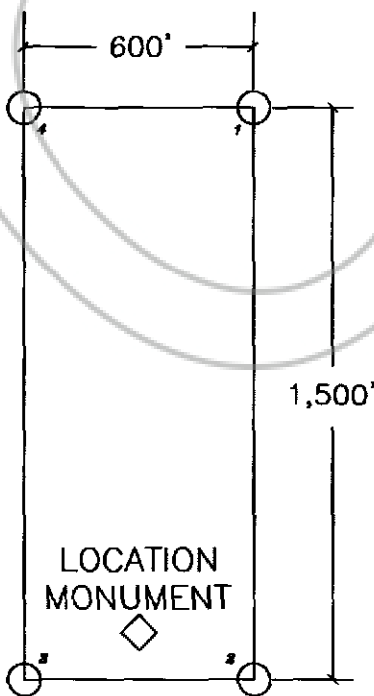

TYPICAL LODGE MINING CLAIM
ALL CLAIMS ARE 1500' x 600'

EXPLANATION

Claim Location Monument
4' 2x2 Wooden Post located
50' inside of claim from
midpoint between corners or
as otherwise noted.

Claim Corner Monument
4' 2x2 Wooden Post

Projected Section Line

Survey Corner Monument
Projected from USGS
Topographic Map

NOTES:

1. The Northwest corner of Claim 4 is located 120' North and 830' East of the Northwest corner of Section 9 T25N, R50E, MDBM.

Claim Location Dates:

ZERO Claim 4 was located on
March 1, 2012.

ZERO CLAIM

LOCATED WITHIN
Sections 4 & 9 of Township 25 North, Range 50 East, MDBM
Eureka County, Nevada

Nevada North Resources (U.S.A.), Inc.,
501 S. 1st Avenue, Suite N
Arcadia, CA 91006

Drawn by: OSG

Date: 27 April 2012

ZERO Claims.dwg

Survey & Map by:

NORTH AMERICAN EXPLORATION, INC.
447 North 300 West, Suite 3, Kayville, UT 84037
(801) 544-3421

