

**11**  
**R 49 E**

**12**

**15**

**14**

**13**

**22**

**23**

**24**

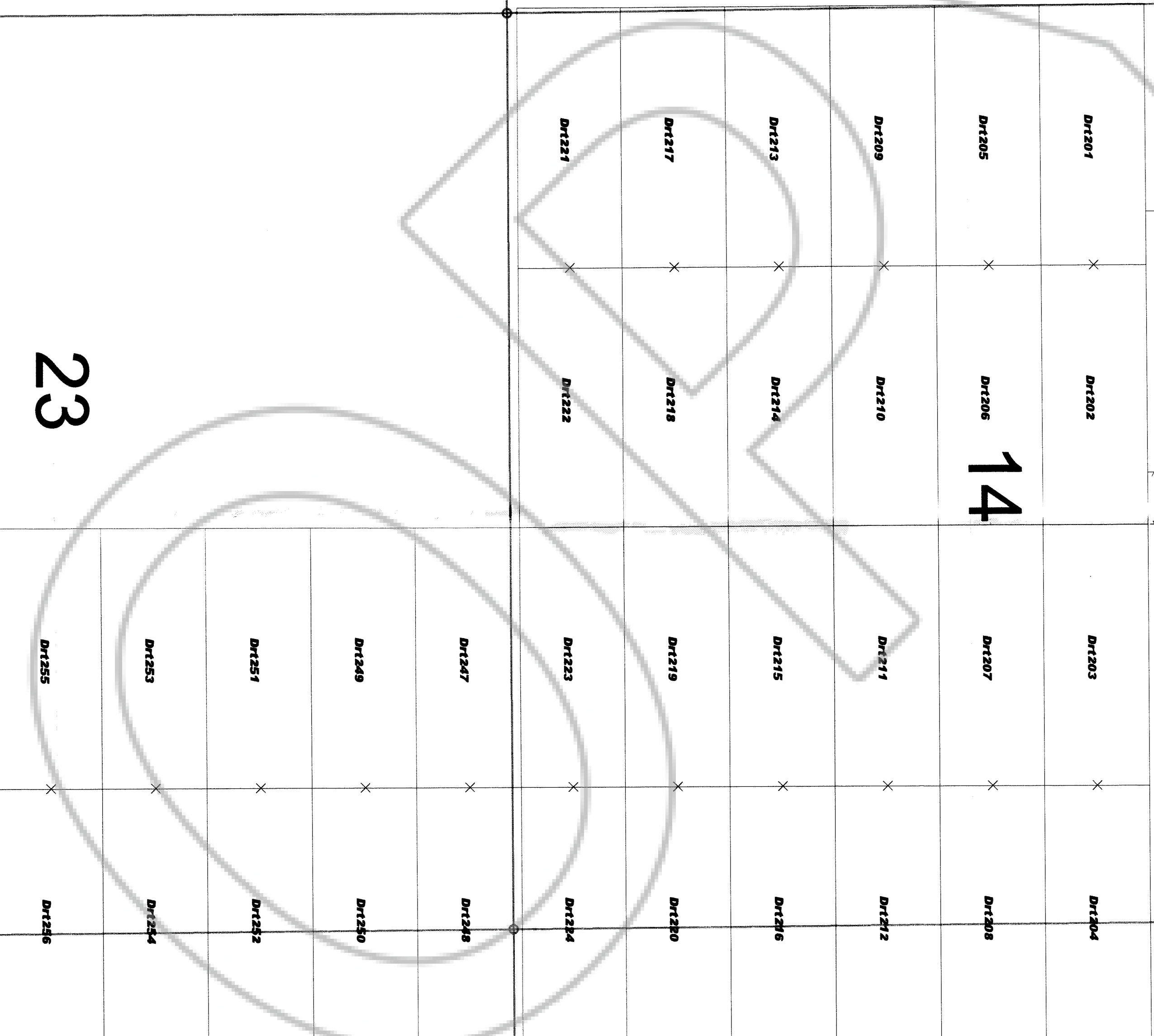
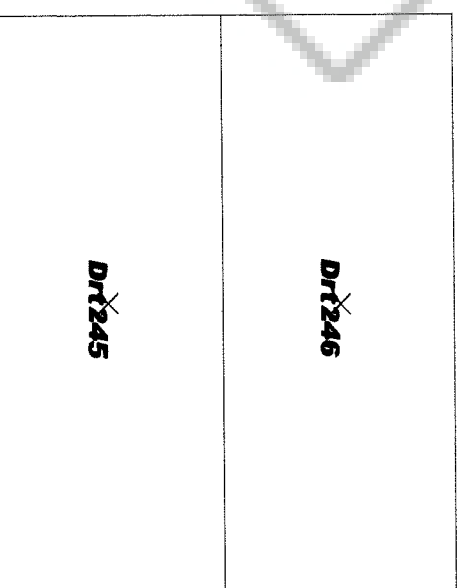

Control Pt. - SE cor. D12 255 is approx. 360 ft.  
M40W of road intersection at elev. 6795  
on Buckhorn Mine Quad.

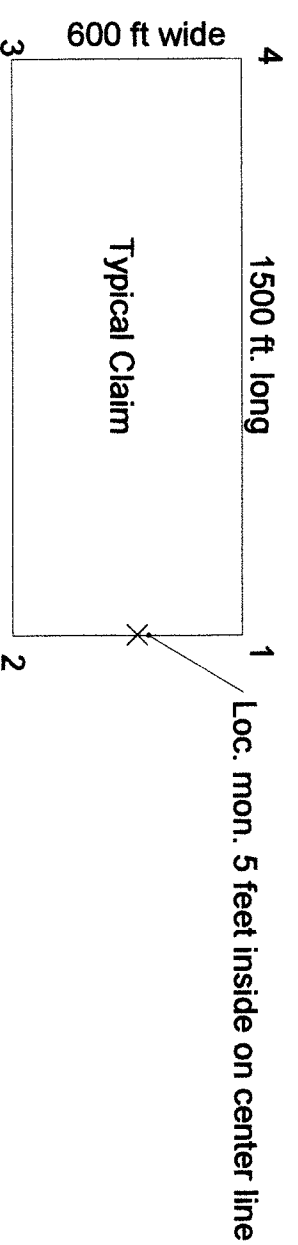
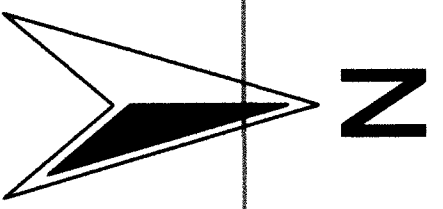

**Amendment to Drt Claim Block**  
**Scale 1 inch = 500 feet**  
**Located in Eureka County FBO**  
**Genesis Gold Corp.**  
**#3 Knob Hill Road**  
**Park City, UT 84098**

D12 201 to 212, and 215, 216, 219, 220, 223, 224, 245, 246 located October 10, 2012.  
D12 213, 214, 217, 218, 221, 222 located October 11, 2012.  
D12 247 to 256 located October 18, 2012.

**DOC # 0223322**

Recorded & Indexed by  
Eureka County - Recorder  
Mike Rehsaelli  
Fee: \$15.00  
Page: 0000 of 0000  
Book: 0223322

