

6

15

14

T 27 N, R 49 E

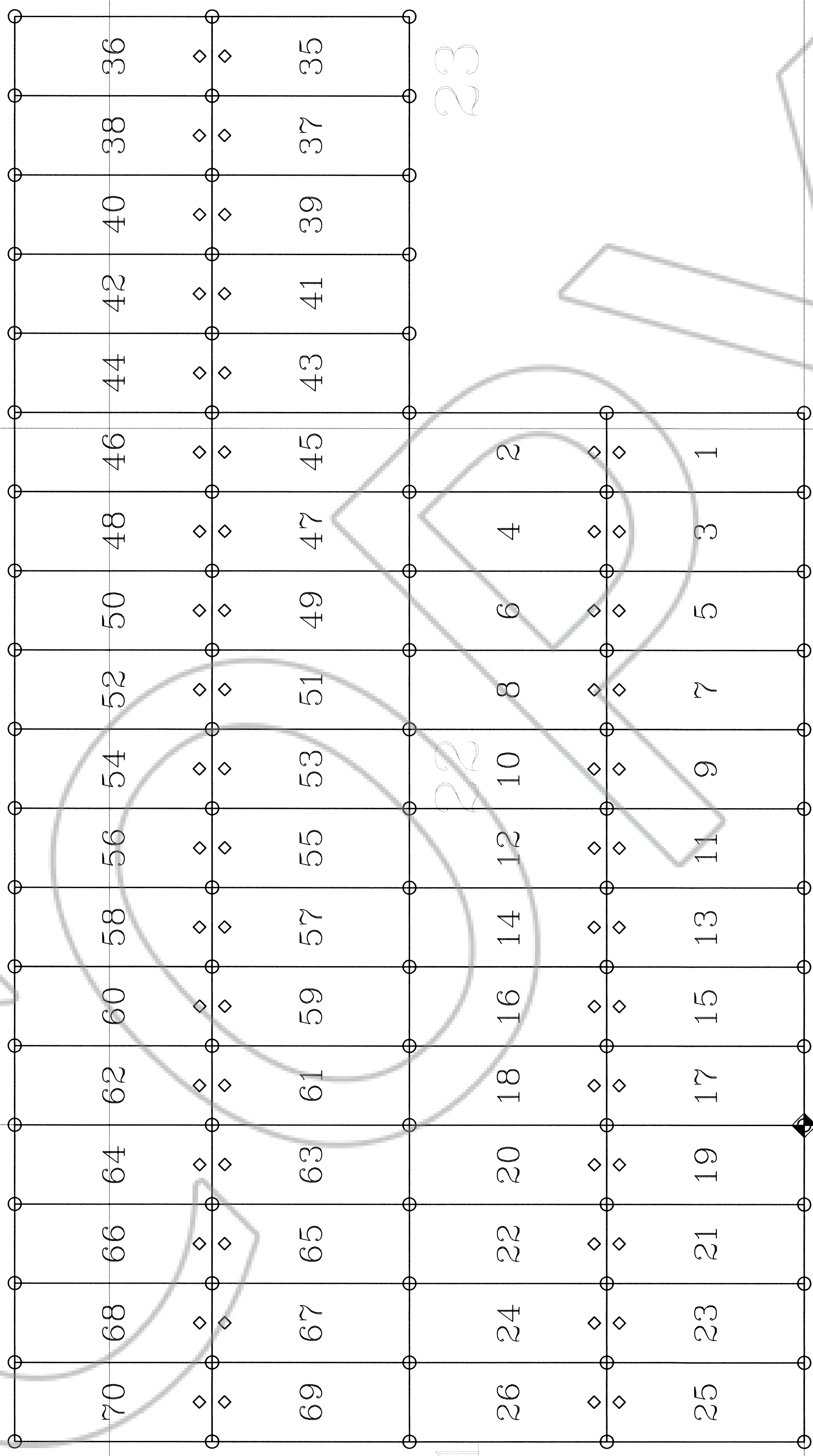

21

22

23

28

27

26

EXPLANATION

- ◊ Claim Location Monument
- 4" x 2x2" Wooden Post located at corner of claim.
- ◊ Claim Corner Monument
- 4" x 2x2" Wooden Post
- Section Line
- ◊ Survey Corner Monument Projected from USGS Topographic Map

NOTES:

- Claims are oriented North/South
- All Claims Located on November 11, 2012

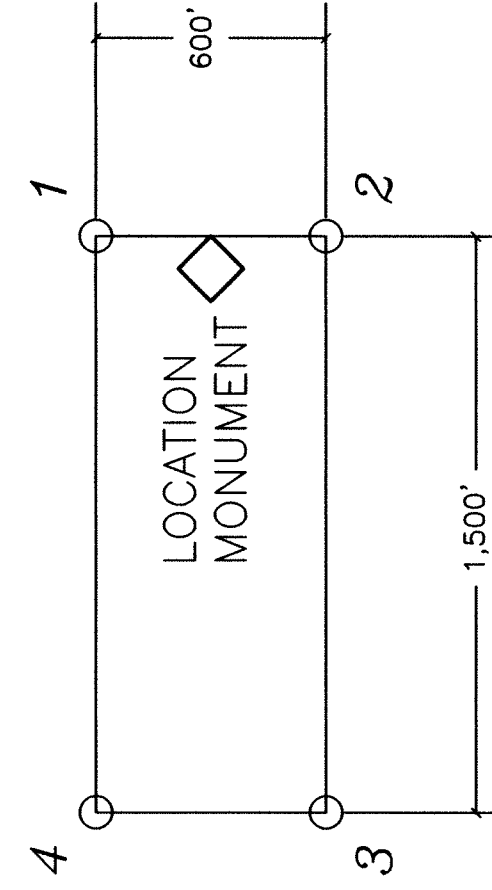

TYPICAL LOCATION MINING CLAIM
ALL CLAIMS ARE 1500' x 600' UNO

DOC # 0223390
12/18/2012 09:01 PM
Official Record
NEVADA TREND EXPLORATION

Mike Roberts, Nevada County Recorder
Fee: \$324.00
Book: 545 Page: 614
Recorded By: RES



0223390



Scale
1" = 6,000'
(1" = 2,000')



Agate Claims

NEVADA TREND EXPLORATION
PO BOX 999
DELTA, UT 84624

Located Within Sections 14, 15, 16, 21, 22, and 23 of
T27N, R49E, MDBM
Eureka County, Nevada

Drawn by: OSG Date: 13 December, 2012
AGATE Claims.dwg

Survey & Map by:
JUSTIN AMERICAN EXPLORATION, INC.
447 North 300 West, Suite 3, Kayville, UT 84037
(801) 544-3421

