

NEVADA

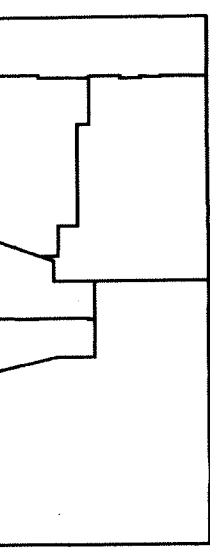

LOCATION DATES:
 Gold Ridge 5-16 Located September 4, 2015
 Gold Ridge 17-30 Located September 10, 2015

THE POINT: From the SE corner of T23N R48E Section 36, to the SW corner of Gold Ridge 26
 8,367 ft bearing 90.86 deg

DOC # 0229971
 Official Record

10/09/2015 03:10:59M
 REPRODUCED FROM THE ORIGINAL RECORD BY
 Sara Simmons - Recorder of Deeds
 Eureka County - NV
 2524, 00
 Book - Page -
 Record of Deeds



0229971

Drawn by: Felton Goodale Ltd
 (531) 305-8265
 zhenderson@earthlink.net
 www.feltongeo.com



TYPICAL CLAIM

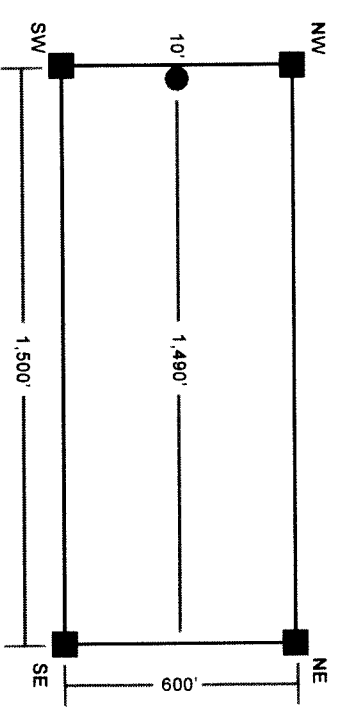

LEGEND:

- = CORNER
- = LOCATION MONUMENT

**GOLD RIDGE LODGE CLAIMS
 ANTELOPE
 MINING DISTRICT**

1 / 1

DATE:	SEPTEMBER 2015	FILE NAME:	Gold Ridge Ridge Map.pdf	REVISION NUMBER:	1
PROJECTION:	UTMZONE 11N, WGS84	PLOT SCALE:	1" = 400'	DRAWN BY:	ZSH
				MODIFIED BY:	ZSH

LOCATED BY:
 Zachary Henderson & Gerald W. Baughman
 AGENT FOR:
NEVADA EAGLE, LLC.
 PO Box 18127
 Reno, NV 89511
 EMAIL: jerrybaughman@ebgglobal.net
 PH: (775) 853-1913

TOWNSHIP 23N, RANGE 50E, SECTION(S) 4, 5
 TOWNSHIP 23N, RANGE 50E, SECTION(S) 32, 33
 EUREKA COUNTY, STATE OF NEVADA