

MAP 2

Diamond Point Lode Claims
 DP-53 through DP-102,
 DP-146 through DP-148
 in Sections 26, 27, and 35 in T26N, R54E
 and Sections 2, 3, 10, and 11 in T25N, R54E
 Mount Diablo Base & Meridian (MDB&M)
 Unknown Mining District
 Eureka County, Nevada
 1" = 500 feet
 UTM WGS84, Zone 11
 Renaissance Exploration, Inc.
 4750 Longley Lane, Suite 106
 Reno, NV 89502

Section 27

Map of the Diamond Point (DP) Lode Claim Group
 Section 26, 27, and 35, T26N, R54E
 and
 Section 2, 3, 10 and 11, T25N, R54E
 Eureka County, Nevada

DP-49 through DP-86 located on
 October 27, 2016 by Seth Saunders
 DP-121 through DP-148 located on
 October 27, 2016 by Dan Pace

DP-31 through DP-48 and DP-87 through DP-102
 located on October 28, 2016 by Seth Saunders
 DP-18, DP-19, DP-29, DP-30 and DP-116 through DP-120
 located on October 28, 2016 by Dan Pace

Dan Pace and Seth Saunders,
 agents for Renaissance Exploration, Inc.
 Renaissance Exploration, Inc.
 4750 Longley Ln, Suite 106
 Reno, NV 89502

DOC # 0232446

01/13/2017 02:57 PM
Official Record
 Recording Requested By
 RENAISSANCE, CO,LLP
 Eureka County - NV
 Lisa Hoehne - Recorder
 Fee: \$799.00 Page: 1 of 1
 SPTT Recorded By: GH
 Book- Page-



0232446

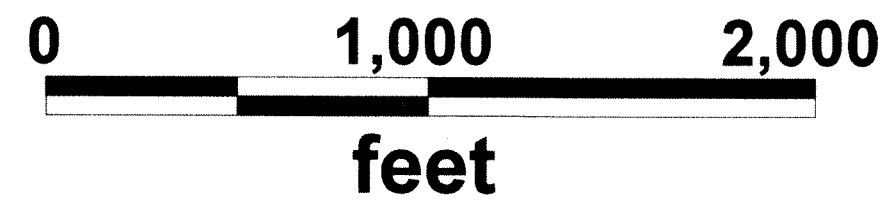

Township & section information
 from GCDB for Eureka County, NV

T26N R54E

T25N R54E

- Section line, based on NV GCDB
- Claim corner 2" by 2" wooden post
- Location monument 2" by 2" wooden post. Offset 20' from claim end line and 300' either side line.
- All claims 1500' long by 600' wide

Section 3

Section 10

Section 34

Tie point is approximately 1197'
 in a S57W direction from
 the common corner
 of Sections 2, 3, 10 11, T25N, R54E
 to the NW corner of claim DP-097

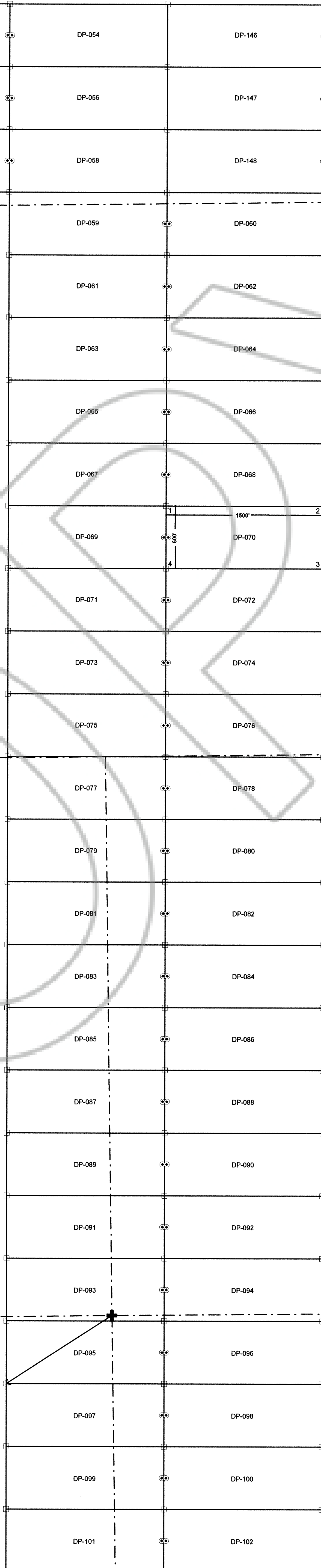

Section 26

Section 25

Section 35

Section 36

Section 2

Section 11