

DOC# 232993

05/18/2017

03:41PM

Official Record

Requested By
KINROSS GOLD USA

Eureka County - NV

Lisa Hoehne - Recorder

Page: 1 of 15 Fee: \$28.00

Recorded By LH RPTT: \$0.00

Book- 0601 Page- 0165



0232993

Recording Requested by and to be Returned to:
Kinross Gold U.S.A. Inc.
5075 S. Syracuse Street, Suite 800
Denver, CO 80237

This document contains no personal information as defined in NRS 603A.040.

MEMORANDUM OF EXPLORATION AGREEMENT WITH VENTURE OPTION

Notice is hereby given that under the terms of that certain Exploration Agreement with Venture Option ("Agreement") dated effective as of May 15, 2017 ("Effective Date"), by and between RENAISSANCE EXPLORATION INC., a Nevada corporation ("RENEX") the address of which is 4750 Longley Land, Suite 106, Reno, NV 89502, and KINROSS GOLD U.S.A., INC., a Nevada corporation ("Kinross") the address of which is 5075 South Syracuse Street, Suite 800, RENEX has leased and granted exclusively to Kinross all of RENEX's rights, title and interests in those properties described in Part 1 of Exhibit A, Part 1 of Exhibit B, and Part 1 of Exhibit C hereto ("Exploration Properties"), including RENEX's entire interest in all Minerals in, on, or under the Exploration Properties, together with all appurtenances, extralateral rights and water rights incident to the Exploration Properties, for purposes of conducting Mineral exploration and development work.

For purposes of the Agreement, "Minerals" means any and all metals, ores, minerals and mineral rights of whatever kind and nature in, under or upon the Exploration Properties or that may otherwise be developed as part of the Exploration Properties by any method now known or hereafter discovered, including, without limitation metals, precious metals, base metals, ores, industrial minerals, gems, diamonds and commercially valuable rock.

The Agreement also grants to Kinross the right to earn-in a seventy percent (70%) participating interest in one or more mining ventures that may be formed by the parties with respect to the Exploration Properties and Areas of Interest. For purposes of the Agreement, the "Areas of Interest" is defined as those areas described in Part 2 of Exhibit A, Part 2 of Exhibit B and Part 2 of Exhibit C hereto.

If RENEX acquires any additional interests in any lands, minerals or other real property within the Areas of Interest, RENEX shall promptly deliver to Kinross written notice of the acquisition, and Kinross may elect to have such acquired interests, included in the Exploration Properties that are subject to this Agreement. If Kinross desires to acquire any interest in land, minerals or other real property within the Area of Interest, including locating any additional unpatented mining claims, it shall notify RENEX in writing, and RENEX may elect to have such interests acquired in RENEX's name. If RENEX elects to have such interests acquired in its name, those acquired interests shall be included in the Exploration Properties that are subject to the Agreement.

Neither RENEX nor Kinross may transfer or encumber any of its interests in the Agreement or Exploration Properties, including any Minerals on or within the Exploration Properties, without the prior consent of the other party.

RENEX has also granted to Kinross a right of first refusal on any properties located within the Counties of Eureka, Elko or White Pine that are owned or acquired by RENEX or an RENEX affiliate. This right of first refusal will expire upon the earlier of: (i) the third anniversary of the Effective Date, or (ii) if the Agreement has previously been terminated as to all of the Exploration Properties, the date on which Kinross is not a party to any agreement with RENEX whereby Kinross holds a right or option to acquire an interest in any real property or mineral interests owned by RENEX.

Unless sooner terminated in the manner therein provided, the Agreement shall terminate 10 years from the Effective Date.

To the extent there is any inconsistency between this Memorandum of Exploration Agreement with Venture Option and the terms of the Agreement, the terms of the Agreement shall govern.

IN WITNESS WHEREOF, this Memorandum of Exploration Agreement with Venture Option is effective as of the date first set forth above.

RENAISSANCE EXPLORATION INC. KINROSS GOLD U.S.A., INC.

By: Ronald L. Parrott
Name: Ronald L. Parrott
Title: President CEO

By: Martin D. Litt
Name: MARTIN D. LITT
Title: VP, EC + SEC.



STATE OF Nevada)
) ss.
COUNTY OF Washoe)

This instrument was acknowledged before me on this 15th day of May, 2017, by Ronald L. Parrott, as President + CEO of RENAISSANCE EXPLORATION INC.

IN WITNESS WHEREOF, I have hereunto set my hand and affixed my Official Seal the day and year first above written.

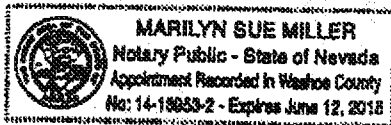

Marilyn Sue Miller
Notary Public
My commission expires: June 12, 2018

STATE OF Colorado)
) ss.
COUNTY OF Denver)

This instrument was acknowledged before me on this 15th day of May, 2017, by Martin D. Witt, as VP, Geol. Sec. of KINROSS GOLD U.S.A., INC.

IN WITNESS WHEREOF, I have hereunto set my hand and affixed my Official Seal the day and year first above written.

Peggy Faust O'Neill
Notary Public
My commission expires: 1/21/19

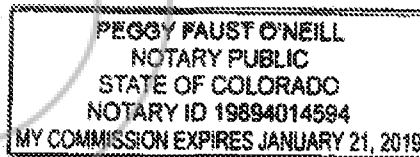

232993

Book: 601 05/18/2017
Page: 167 3 of 15

**EXHIBIT A
TO MEMORANDUM OF EXPLORATION AGREEMENT
WITH VENTURE OPTION**

SPRUCE EAST PROPERTY AND AREA OF INTEREST

Part 1 – Spruce East Property

The following 77 lode mining claims located in Elko County, Nevada:

Claim Name	BLM NMC#	Date Located	County Name	Document Number	Recorded Date
SE-1	1135949	9/26/2016	Elko	719638	12/15/2016
SE-2	1135950	10/20/2016	Elko	719639	12/15/2016
SE-3	1135951	9/26/2016	Elko	719640	12/15/2016
SE-4	1135952	10/20/2016	Elko	719641	12/15/2016
SE-5	1135953	9/26/2016	Elko	719642	12/15/2016
SE-6	1135954	10/20/2016	Elko	719643	12/15/2016
SE-7	1135955	9/26/2016	Elko	719644	12/15/2016
SE-8	1135956	10/20/2016	Elko	719645	12/15/2016
SE-9	1135957	9/26/2016	Elko	719646	12/15/2016
SE-10	1135958	10/20/2016	Elko	719647	12/15/2016
SE-11	1135959	9/26/2016	Elko	719648	12/15/2016
SE-12	1135960	10/20/2016	Elko	719649	12/15/2016
SE-13	1135961	9/26/2016	Elko	719650	12/15/2016
SE-14	1135962	10/20/2016	Elko	719651	12/15/2016
SE-15	1135963	9/26/2016	Elko	719670	12/15/2016
SE-16	1135964	10/20/2016	Elko	719671	12/15/2016
SE-17	1135965	9/26/2016	Elko	719672	12/15/2016
SE-18	1135966	10/20/2016	Elko	719673	12/15/2016
SE-19	1135967	9/26/2016	Elko	719674	12/15/2016
SE-20	1135968	10/20/2016	Elko	719675	12/15/2016
SE-21	1135969	9/26/2016	Elko	719676	12/15/2016
SE-22	1135970	10/20/2016	Elko	719677	12/15/2016
SE-23	1135971	9/26/2016	Elko	719678	12/15/2016
SE-24	1135972	10/20/20106	Elko	719679	12/15/2016
SE-25	1135973	9/27/2016	Elko	719680	12/15/2016
SE-26	1135974	9/27/2016	Elko	719681	12/15/2016
SE-27	1135975	9/27/2016	Elko	719682	12/15/2016

SE-28	1135976	9/27/2016	Elko	719683	12/15/2016
SE-29	1135977	9/27/2016	Elko	719684	12/15/2016
SE-30	1135978	9/27/2016	Elko	719685	12/15/2016
SE-31	1135979	9/27/2016	Elko	719686	12/15/2016
SE-32	1135980	9/27/2016	Elko	719687	12/15/2016
SE-33	1135981	10/21/2016	Elko	719652	12/15/2016
SE-34	1135982	10/21/2016	Elko	719653	12/15/2016
SE-35	1135983	10/21/2016	Elko	719654	12/15/2016
SE-36	1135984	10/21/2016	Elko	719655	12/15/2016
SE-37	1135985	9/26/2016	Elko	719656	12/15/2016
SE-38	1135986	9/26/2016	Elko	719657	12/15/2016
SE-39	1135987	9/26/2016	Elko	719658	12/15/2016
SE-40	1135988	9/26/2016	Elko	719659	12/15/2016
SE-41	1135989	9/26/2016	Elko	719660	12/15/2016
SE-42	1135990	9/26/2016	Elko	719661	12/15/2016
SE-43	1135991	9/26/2016	Elko	719662	12/15/2016
SE-44	1135992	9/26/2016	Elko	719663	12/15/2016
SE-45	1135993	9/26/2016	Elko	719664	12/15/2016
SE-46	1135994	9/26/2016	Elko	719665	12/15/2016
SE-47	1135995	9/26/2016	Elko	719688	12/15/2016
SE-48	1135996	9/26/2016	Elko	719689	12/15/2016
SE-49	1135997	10/21/2016	Elko	719690	12/15/2016
SE-50	1135998	10/21/2016	Elko	719691	12/15/2016
SE-51	1135999	10/21/2016	Elko	719692	12/15/2016
SE-52	1136000	10/21/2016	Elko	719693	12/15/2016
SE-53	1136001	10/21/2016	Elko	719694	12/15/2016
SE-54	1136002	10/21/2016	Elko	719695	12/15/2016
SE-55	1136003	10/21/2016	Elko	719696	12/15/2016
SE-56	1136004	10/21/2016	Elko	719697	12/15/2016
SE-57	1136005	10/21/2016	Elko	719698	12/15/2016
SE-58	1136006	10/21/2016	Elko	719699	12/15/2016
SE-60	1136007	10/21/2016	Elko	719700	12/15/2016
SE-62	1136008	10/21/2016	Elko	719701	12/15/2016
SE-64	1136009	10/21/2016	Elko	719702	12/15/2016
SE-66	1136010	10/21/2016	Elko	719703	12/15/2016
SE-68	1136011	10/21/2016	Elko	719704	12/15/2016
SE-70	1136012	10/21/2016	Elko	719705	12/15/2016
SE-71	1136013	10/19/2016	Elko	719706	12/15/2016
SE-72	1136014	10/19/2016	Elko	719707	12/15/2016



232993

SE-73	1136015	10/19/2016	Elko	719708	12/15/2016
SE-74	1136016	10/19/2016	Elko	719709	12/15/2016
SE-75	1136017	10/19/2016	Elko	719710	12/15/2016
SE-76	1136018	10/19/2016	Elko	719711	12/15/2016
SE-77	1136019	10/19/2016	Elko	719712	12/15/2016
SE-78	1136020	10/19/2016	Elko	719713	12/15/2016
SE-79	1136021	10/19/2016	Elko	719714	12/15/2016
SE-80	1136022	10/19/2016	Elko	719715	12/15/2016
SE-90	1136023	10/31/2016	Elko	719666	12/15/2016
SE-91	1136024	10/31/2016	Elko	719667	12/15/2016
SE-92	1136025	10/31/2016	Elko	719668	12/15/2016

COPY



232993

Book: 601 05/18/2017
Page: 170 6 of 15

Part 2 – Spruce East Area of Interest

SPRUCE EAST PROJECT

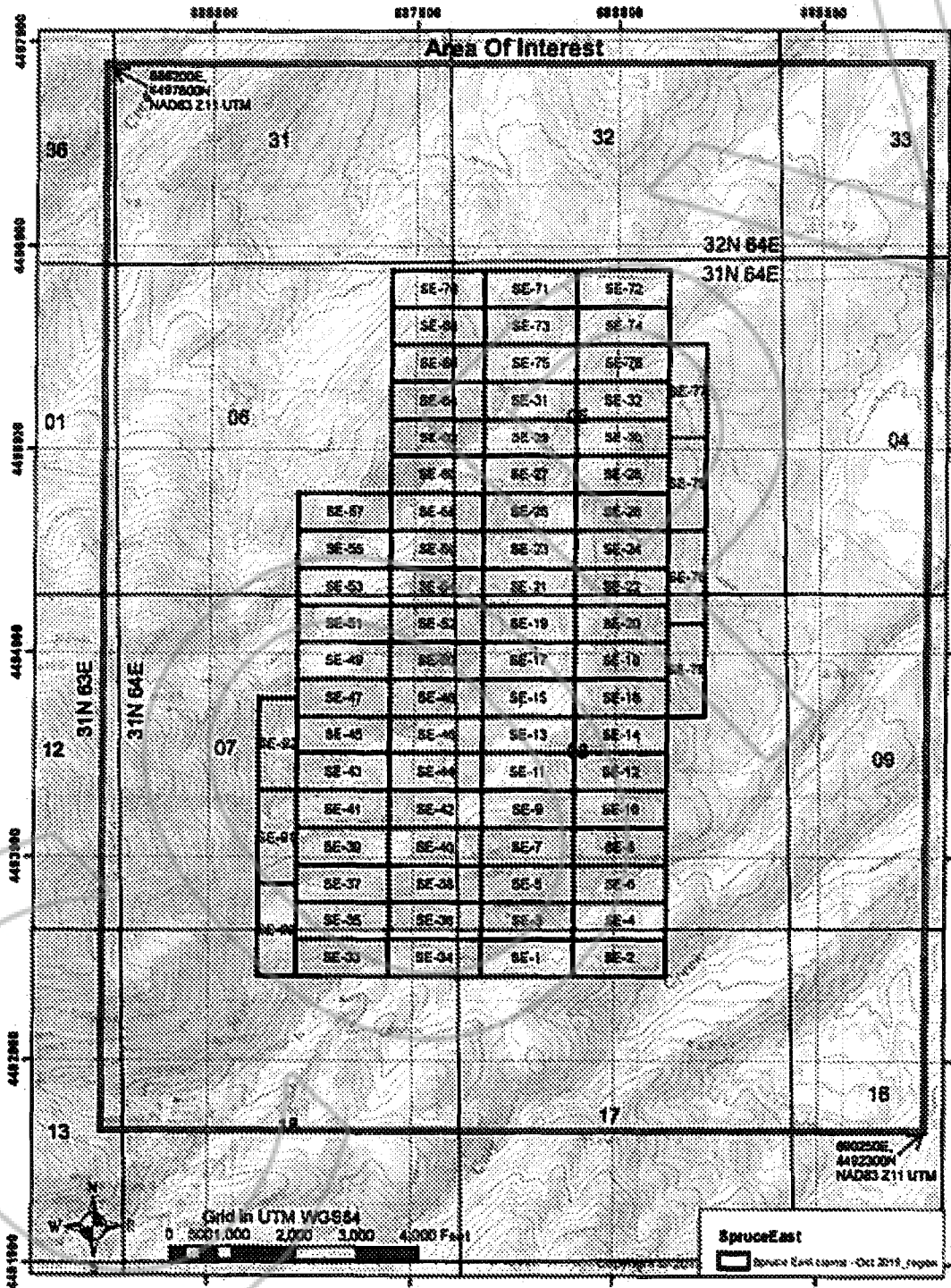

232993

Book: 601 05/18/2017
Page: 171 7 of 15

**EXHIBIT B
TO MEMORANDUM OF EXPLORATION AGREEMENT
WITH VENTURE OPTION**

DIAMOND POINT PROPERTY AND AREA OF INTEREST

Part 1 – Diamond Point Property

The following 109 lode mining claims located in Elko and Eureka Counties, Nevada:

Claim Name	BLM NMC#	Date Located	County Name	Document Number	Recorded Date
DP-018	1137292	10/28/2016	Elko	720587	1/10/2017
DP-019	1137293	10/28/2016	Elko	720588	1/10/2017
DP-029	1137294	10/28/2016	Eureka	232347	1/10/2017
DP-030	1137295	10/28/2016	Elko/Eureka	720589/232348	1/10/2017
DP-031	1137296	10/28/2016	Eureka	232349	1/10/2017
DP-032	1137297	10/28/2016	Elko/Eureka	720590/232350	1/10/2017
DP-033	1137298	10/28/2016	Eureka	232351	1/10/2017
DP-034	1137299	10/28/2016	Eureka	232352	1/10/2017
DP-035	1137300	10/28/2016	Eureka	232353	1/10/2017
DP-036	1137301	10/28/2016	Eureka	232354	1/10/2017
DP-037	1137302	10/28/2016	Eureka	232355	1/10/2017
DP-038	1137303	10/28/2016	Eureka	232356	1/10/2017
DP-039	1137304	10/28/2016	Eureka	232357	1/10/2017
DP-040	1137305	10/28/2016	Eureka	232358	1/10/2017
DP-041	1137306	10/28/2016	Eureka	232359	1/10/2017
DP-042	1137307	10/28/2016	Eureka	232360	1/10/2017
DP-043	1137308	10/28/2016	Eureka	232361	1/10/2017
DP-044	1137309	10/28/2016	Eureka	232362	1/10/2017
DP-045	1137310	10/28/2016	Eureka	232363	1/10/2017
DP-046	1137311	10/28/2016	Eureka	232364	1/10/2017
DP-047	1137312	10/28/2016	Eureka	232365	1/10/2017
DP-048	1137313	10/28/2016	Eureka	232366	1/10/2017
DP-049	1137314	10/27/2016	Eureka	232367	1/10/2017
DP-050	1137315	10/27/2016	Eureka	232368	1/10/2017
DP-051	1137316	10/27/2016	Eureka	232369	1/10/2017
DP-052	1137317	10/27/2016	Eureka	232370	1/10/2017

DP-053	1137318	10/27/2016	Eureka	232393	1/10/2017
DP-054	1137319	10/27/2016	Eureka	232394	1/10/2017
DP-055	1137320	10/27/2016	Eureka	232395	1/10/2017
DP-056	1137321	10/27/2016	Eureka	232396	1/10/2017
DP-057	1137322	10/27/2016	Eureka	232397	1/10/2017
DP-058	1137323	10/27/2016	Eureka	232398	1/10/2017
DP-059	1137324	10/27/2016	Eureka	232399	1/10/2017
DP-060	1137325	10/27/2016	Eureka	232400	1/10/2017
DP-061	1137326	10/27/2016	Eureka	232401	1/10/2017
DP-062	1137327	10/27/2016	Eureka	232402	1/10/2017
DP-063	1137328	10/27/2016	Eureka	232403	1/10/2017
DP-064	1137329	10/27/2016	Eureka	232404	1/10/2017
DP-065	1137330	10/27/2016	Eureka	232405	1/10/2017
DP-066	1137331	10/27/2016	Eureka	232406	1/10/2017
DP-067	1137332	10/27/2016	Eureka	232407	1/10/2017
DP-068	1137333	10/27/2016	Eureka	232408	1/10/2017
DP-069	1137334	10/27/2016	Eureka	232409	1/10/2017
DP-070	1137335	10/27/2016	Eureka	232410	1/10/2017
DP-071	1137336	10/27/2016	Eureka	232411	1/10/2017
DP-072	1137337	10/27/2016	Eureka	232412	1/10/2017
DP-073	1137338	10/27/2016	Eureka	232413	1/10/2017
DP-074	1137339	10/27/2016	Eureka	232414	1/10/2017
DP-075	1137340	10/27/2016	Eureka	232415	1/10/2017
DP-076	1137341	10/27/2016	Eureka	232416	1/10/2017
DP-077	1137342	10/27/2016	Eureka	232417	1/10/2017
DP-078	1137343	10/27/2016	Eureka	232418	1/10/2017
DP-079	1137344	10/27/2016	Eureka	232419	1/10/2017
DP-080	1137345	10/27/2016	Eureka	232420	1/10/2017
DP-081	1137346	10/27/2016	Eureka	232421	1/10/2017
DP-082	1137347	10/27/2016	Eureka	232422	1/10/2017
DP-083	1137348	10/27/2016	Eureka	232423	1/10/2017
DP-084	1137349	10/27/2016	Eureka	232424	1/10/2017
DP-085	1137350	10/27/2016	Eureka	232425	1/10/2017
DP-086	1137351	10/27/2016	Eureka	232426	1/10/2017
DP-087	1137352	10/28/2016	Eureka	232427	1/10/2017
DP-088	1137353	10/28/2016	Eureka	232428	1/10/2017
DP-089	1137354	10/28/2016	Eureka	232429	1/10/2017
DP-090	1137355	10/28/2016	Eureka	232430	1/10/2017
DP-091	1137356	10/28/2016	Eureka	232431	1/10/2017



DP-092	1137357	10/28/2016	Eureka	232432	1/10/2017
DP-093	1137358	10/28/2016	Eureka	232433	1/10/2017
DP-094	1137359	10/28/2016	Eureka	232434	1/10/2017
DP-095	1137360	10/28/2016	Eureka	232435	1/10/2017
DP-096	1137361	10/28/2016	Eureka	232436	1/10/2017
DP-097	1137362	10/28/2016	Eureka	232437	1/10/2017
DP-098	1137363	10/28/2016	Eureka	232438	1/10/2017
DP-099	1137364	10/28/2016	Eureka	232439	1/10/2017
DP-100	1137365	10/28/2016	Eureka	232440	1/10/2017
DP-101	1137366	10/28/2016	Eureka	232441	1/10/2017
DP-102	1137367	10/28/2016	Eureka	232442	1/10/2017
DP-116	1137368	10/28/2016	Elko	720591	1/10/2017
DP-117	1137369	10/28/2016	Elko	720592	1/10/2017
DP-118	1137370	10/28/2016	Elko	720593	1/10/2017
DP-119	1137371	10/28/2016	Elko	720594	1/10/2017
DP-120	1137372	10/28/2016	Elko	720595	1/10/2017
DP-121	1137373	10/27/2016	Elko	720596	1/10/2017
DP-122	1137374	10/27/2016	Elko	720597	1/10/2017
DP-123	1137375	10/27/2016	Elko	720598	1/10/2017
DP-124	1137376	10/27/2016	Elko	720599	1/10/2017
DP-125	1137377	10/27/2016	Elko/Eureka	720600/232371	1/10/2017
DP-126	1137378	10/27/2016	Elko/Eureka	720601/232372	1/10/2017
DP-127	1137379	10/27/2016	Eureka	232373	1/10/2017
DP-128	1137380	10/27/2016	Eureka	232374	1/10/2017
DP-129	1137381	10/27/2016	Eureka	232375	1/10/2017
DP-130	1137382	10/27/2016	Eureka	232376	1/10/2017
DP-131	1137383	10/27/2016	Eureka	232377	1/10/2017
DP-132	1137384	10/27/2016	Eureka	232378	1/10/2017
DP-133	1137385	10/27/2016	Eureka	232379	1/10/2017
DP-134	1137386	10/27/2016	Eureka	232380	1/10/2017
DP-135	1137387	10/27/2016	Eureka	232381	1/10/2017
DP-136	1137388	10/27/2016	Eureka	232382	1/10/2017
DP-137	1137389	10/27/2016	Eureka	232383	1/10/2017
DP-138	1137390	10/27/2016	Eureka	232384	1/10/2017
DP-139	1137391	10/27/2016	Eureka	232385	1/10/2017
DP-140	1137392	10/27/2016	Eureka	232386	1/10/2017
DP-141	1137393	10/27/2016	Eureka	232387	1/10/2017
DP-142	1137394	10/27/2016	Eureka	232388	1/10/2017
DP-143	1137395	10/27/2016	Eureka	232389	1/10/2017



DP-144	1137396	10/27/2016	Eureka	232390	1/10/2017
DP-145	1137397	10/27/2016	Eureka	232391	1/10/2017
DP-146	1137398	10/27/2016	Eureka	232443	1/10/2017
DP-147	1137399	10/27/2016	Eureka	232444	1/10/2017
DP-148	1137400	10/27/2016	Eureka	232445	1/10/2017

COPY



232993

Book: 601 05/18/2017
Page: 175 11 of 15

Part 2 – Diamond Point Area of Interest

DIAMOND POINT PROJECT

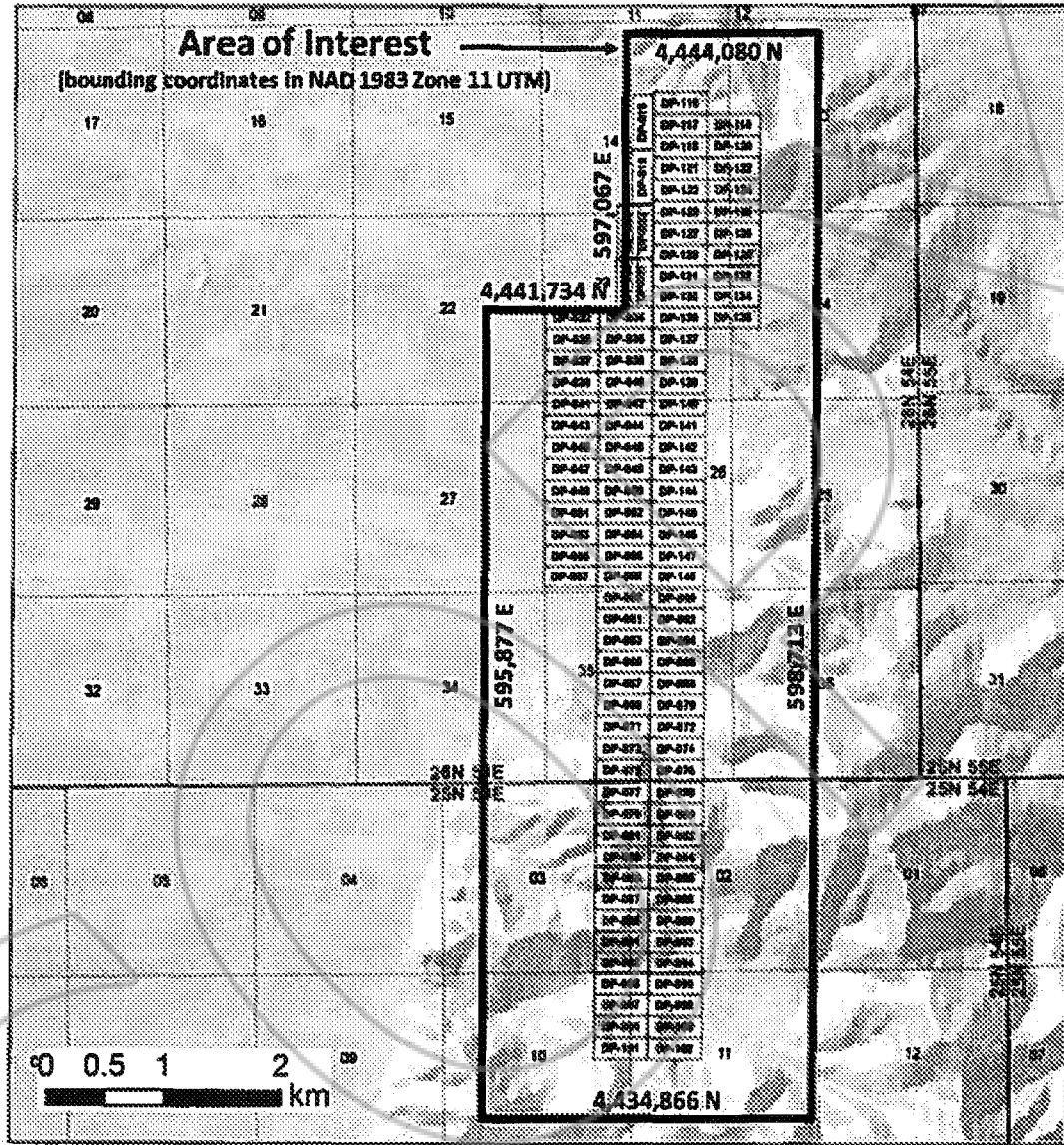

**EXHIBIT C
TO MEMORANDUM OF EXPLORATION AGREEMENT
WITH VENTURE OPTION**

BUFFALO CANYON PROPERTY AND AREA OF INTEREST

Part 1 – Buffalo Canyon Property

The following 65 lode mining claims located in Nye County, Nevada:

Claim Name	BLM NMC#	Date Located	County Name	Document Number	Recorded Date
BC-3	844718	12/16/2002	Nye	556987	3/13/2003
BC-4	844719	12/16/2002	Nye	556988	3/13/2003
BC-5	844720	12/16/2002	Nye	556989	3/13/2003
BC-6	844721	12/16/2002	Nye	556990	3/13/2003
BC-7	844722	12/16/2002	Nye	556991	3/13/2003
BC-8	844723	12/16/2002	Nye	556992	3/13/2003
BC-9	844724	12/16/2002	Nye	556993	3/13/2003
BC-10	844725	12/16/2002	Nye	556994	3/13/2003
BC-11	844726	12/16/2002	Nye	556995	3/13/2003
BC-12	844727	12/16/2002	Nye	556996	3/13/2003
BC-13	844728	12/16/2002	Nye	556997	3/13/2003
BC-14	844729	12/16/2002	Nye	556998	3/13/2003
BC-15	844730	12/16/2002	Nye	556999	3/13/2003
BC-16	844731	12/16/2002	Nye	557000	3/13/2003
BC-17	844732	12/16/2002	Nye	557001	3/13/2003
BC-18	844733	12/16/2002	Nye	557002	3/13/2003
BC-19	844734	12/16/2002	Nye	557003	3/13/2003
BC-20	844735	12/16/2002	Nye	557004	3/13/2003
BC-21	844736	12/16/2002	Nye	557005	3/13/2003
BC-22	844737	12/16/2002	Nye	557006	3/13/2003
BC-23	996238	6/5/2008	Nye	714469	8/22/2008
BC-24	996239	6/5/2008	Nye	714470	8/22/2008
BC-25	996240	6/5/2008	Nye	714471	8/22/2008
BC-26	996241	6/5/2008	Nye	714472	8/22/2008
BC-27	996242	6/5/2008	Nye	714473	8/22/2008
BC-28	996243	6/5/2008	Nye	714474	8/22/2008
BC-29	996244	6/5/2008	Nye	714475	8/22/2008



BC-30	996245	6/5/2008	Nye	714476	8/22/2008
BC-31	996246	6/5/2008	Nye	714477	8/22/2008
BC-32	996247	6/5/2008	Nye	714478	8/22/2008
BC-47	996262	6/4/2008	Nye	714493	8/22/2008
BC-48	996263	6/4/2008	Nye	714494	8/22/2008
BC-50	996265	6/6/2008	Nye	714496	8/22/2008
BC-52	996267	6/6/2008	Nye	714498	8/22/2008
BC-80	996295	6/11/2008	Nye	714526	8/22/2008
BC-82	996297	6/11/2008	Nye	714528	8/22/2008
BC-87	996302	6/13/2008	Nye	714533	8/22/2008
BC-88	996303	6/13/2008	Nye	714534	8/22/2008
BC-89	996304	6/13/2008	Nye	714535	8/22/2008
BC-90	996305	6/13/2008	Nye	714536	8/22/2008
BC-91	996306	6/13/2008	Nye	714537	8/22/2008
BC-93	996308	6/13/2008	Nye	714539	8/22/2008
BC-95	1005067	1/7/2009	Nye	725082	3/31/2009
BC-96	1005068	1/7/2009	Nye	725083	3/31/2009
BC-100	1005072	1/8/2009	Nye	725087	3/31/2009
BCW 6	1080145	9/4/2012	Nye	857615	11/9/2012
BCW 8	1080147	9/4/2012	Nye	857240	11/9/2012
BCW 10	1080149	9/4/2012	Nye	857241	11/9/2012
BCW 12	1080151	9/4/2012	Nye	857242	11/9/2012
BCW 14	1080153	9/4/2012	Nye	857243	11/9/2012
BCW 19	1080158	9/4/2012	Nye	857244	11/9/2012
BCW 20	1080159	9/4/2012	Nye	857245	11/9/2012
BCW 21	1080160	9/4/2012	Nye	857246	11/9/2012
BCW 22	1080161	9/4/2012	Nye	857247	11/9/2012
BCW 23	1080162	9/4/2012	Nye	857248	11/9/2012
BCW 24	1080163	9/4/2012	Nye	857249	11/9/2012
BCW 25	1080164	9/4/2012	Nye	857250	11/9/2012
BCW-19	1129884	6/15/2016	Nye	859725	9/8/2016
BCW-20	1129885	6/15/2016	Nye	859726	9/8/2016
BC-1	1129878	6/15/2016	Nye	859719	9/8/2016
BC-54	1129879	6/15/2016	Nye	859720	9/8/2016
BC-56	1129880	6/15/2016	Nye	859721	9/8/2016
BC-58	1129881	6/15/2016	Nye	859722	9/8/2016
BC-60	1129882	6/15/2016	Nye	859723	9/8/2016
BC-62	1129883	6/15/2016	Nye	859724	9/8/2016



Part 2 – Buffalo Canyon Area of Interest

BUFFALO CANYON PROJECT

T12N R39E

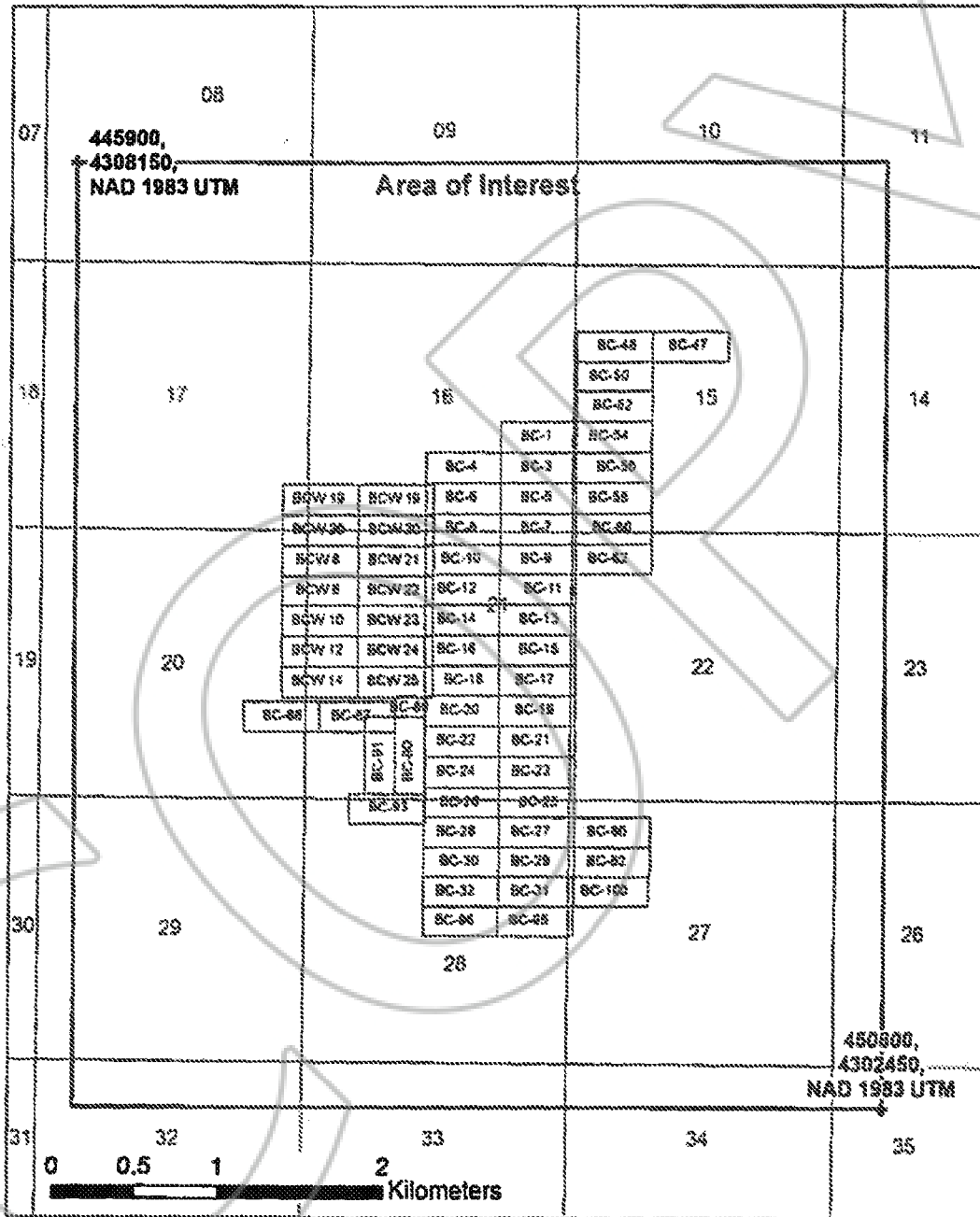

232993

Book: 601 05/18/2017
 Page: 179 15 of 15