

Map of the GCN-30 Lode Claim, Section 4, T22N, R50E, MDBM, Eureka County, Nevada, Antelope District

Tie: The NW corner of GCN-30 is 508 feet south and 12,734 feet east of the public survey monument marking the NE corner of section 1, T22N, R49E and the SE corner of section 36, T23N, R49E.

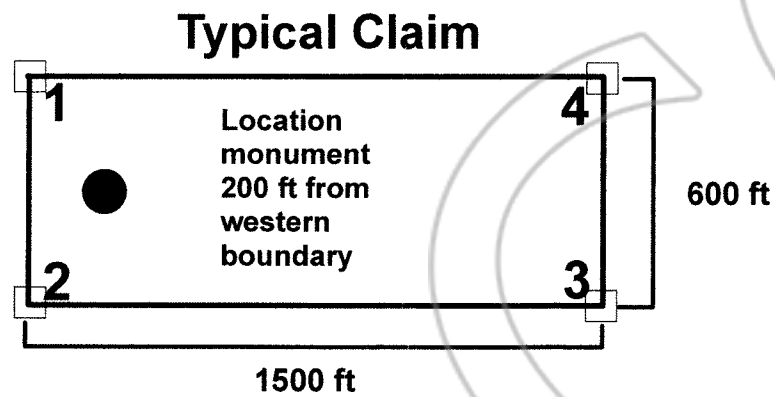
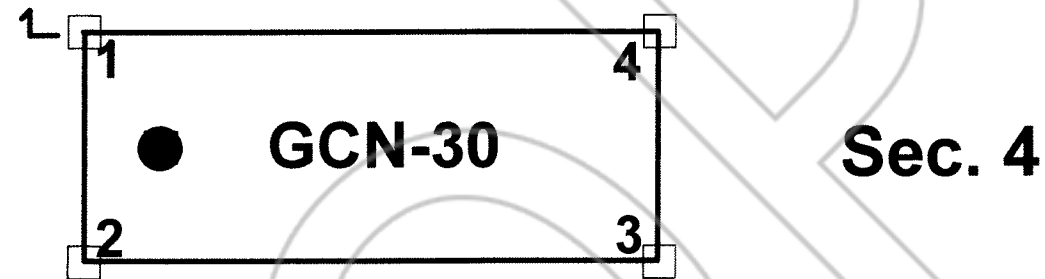

- 1 NW Corner
- 2 SW Corner
- 3 SE Corner
- 4 NE Corner

Located on April 19, 2018, by:
Nevada Select Royalty, Inc.
P.O. Box 18127
Reno, Nevada 89511

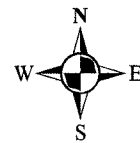

Scale: 1 inch = 500 feet

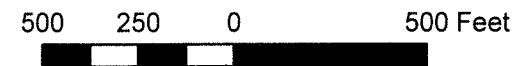

EUREKA COUNTY, NV 2018-235494
\$15.00 \$10.00
Total: \$25.00 06/18/2018 01:19 PM
NEVADA SELECT ROYALTY INC Pgs=1



LISA HOEHNE, RECORDER