

**CLAIM LOCATION DATES:**  
October 6, 2018: HR 85-93

**CLAIM TIES:**  
 The Location Monument of HR 85 is located approximately 6144 feet north and 16,194 feet east of the NW corner of Section 32, T22N, R50E, M.D.M.  
 The Location Monument of HR 86 is located approximately 6164 feet north and 16,194 feet east of the NW corner of Section 32, T22N, R50E, M.D.M.  
 The Location Monument of HR 87 is located approximately 7625 feet north and 16,753 feet east of the NW corner of Section 32, T22N, R50E, M.D.M.  
 The Location Monument of HR 89 is located approximately 7095 feet north and 10,377 feet east of the NW corner of Section 32, T22N, R50E, M.D.M.  
 The Location Monument of HR 90 is located approximately 8243 feet north and 9947 feet east of the NW corner of Section 32, T22N, R50E, M.D.M.  
 The Location Monument of HR 91 is located approximately 10,446 feet north and 11,715 feet east of the NW corner of Section 32, T22N, R50E, M.D.M.  
 The Location Monument of HR 92 is located approximately 9491 feet north and 8380 feet east of the NW corner of Section 32, T22N, R50E, M.D.M.  
 The Location Monument of HR 93 is located approximately 7629 feet north and 6765 feet east of the NW corner of Section 32, T22N, R50E, M.D.M.

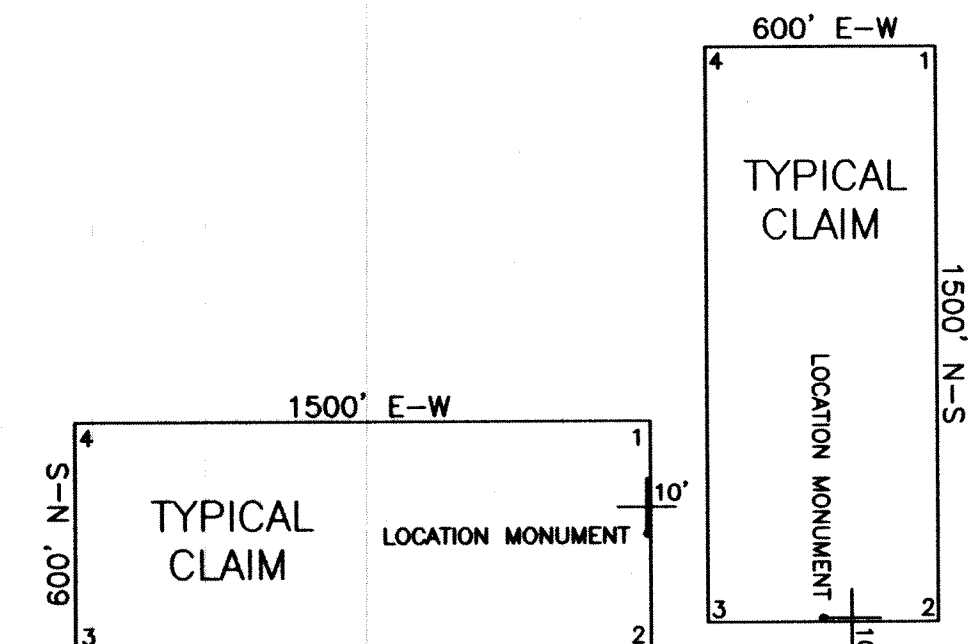
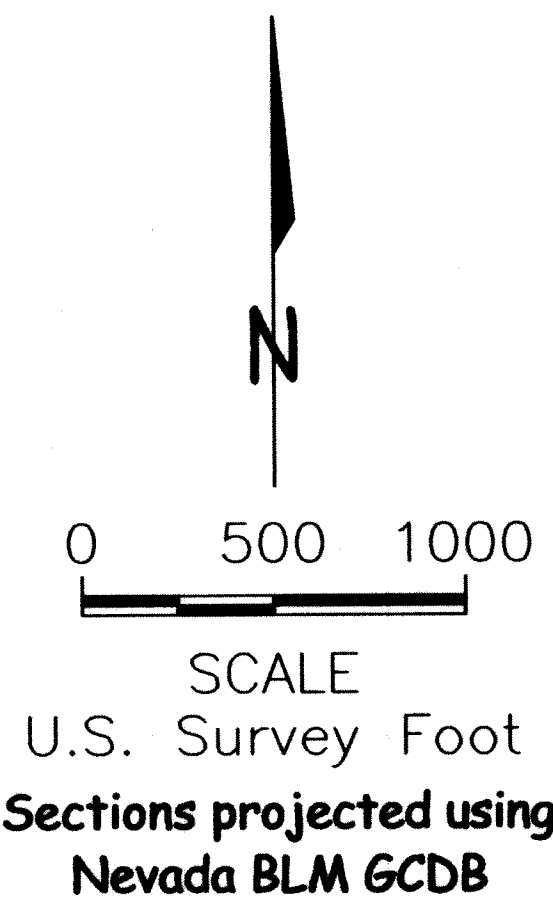

ALL CLAIMS ARE 1500' x 600' UNLESS OTHERWISE NOTED.  
 ALL MONUMENTS ARE 2' x 2' x 4' WOODEN POSTS.  
 LOCATION MONUMENTS ARE SET 10' INSIDE CLAIM BOUNDARY UNLESS OTHERWISE NOTED.

EUREKA COUNTY, NV 2018-236504  
 Rec \$145.00  
 Total \$145.00  
 MCEWEN MINING NEVADA INC  
 12/08/2018 01:07 PM  
 Pgs=1  
 00003085201802365040010019  
 LISA HOEHNE, RECORDER

<b>LODE MINING CLAIM MAP</b> <b>HR 85-93</b> T22N, R50E, M.D.M. EUREKA COUNTY, NEVADA		
Locator: <b>GOLDEN PICK LLC</b> 2215 N. 5th St. Elko, Nevada 89801		
Drawn By: <b>ARD</b>	November 2018	Sheet 1 of 1