

The following Document contains no Personal Information  
as defined by NRS 603A.040

EUREKA COUNTY, NV  
MINING-NIH  
\$12.00 \$24.00  
Total:\$36.00  
MONIE SMITH

2020-240846  
07/24/2020 01:29 PM  
Pgs=2



00008040202002408460020024

LISA HOEHNE, CLERK RECORDER

**AFFIDAVIT AND NOTICE OF INTENT TO HOLD  
MINING CLAIM(S) AND SITE(S)**

**TO ALL WHOM IT MAY CONCERN:**

The undersigned certifies that the owner or claimant intends to  
hold the mining claim(s) for the assessment year ending  
September 1, 2021 (insert assessment year).

**RECORDER'S STAMP**

The claim map showing said claim(s) is filed in the Eureka County records. Claims are  
generally located in Section(s): 3 Township: 26 N Range: 48 E

Name of claim(s) or site(s):  
MULE 1 and MULE 2 - Sec. 3 (North 1/2), T 26 N, R 48 E  
\_\_\_\_\_  
\_\_\_\_\_  
\_\_\_\_\_

BLM Serial No(s):  
NMC 857561 and NMC 857562  
\_\_\_\_\_  
\_\_\_\_\_  
\_\_\_\_\_

A total number of 2 claims is being filed with this document.

Name and mailing address of owner or claimant:  
Owners of Undivided 1/3 Shares: Aquarian Mining/  
Ric & Mike Mathews / Ed & Phuong Smith and  
Monie Smith & Michael Johnson  
c/o 559 East 300 South, Jerome, ID 83338

Dated this 24th day of July, 2020.

By Monie Smith  
Owner, Claimant, Agent, or Lessee Signature  
(circle one)

Aquarian Mining / Mathews / Smith, Owners  
Owner, Claimant, Agent, or Lessee Name  
(printed)

STATE OF Idaho  
COUNTY OF Twin Falls

Subscribed and sworn to by  
Monie Smith  
(Owner) Claimant, Agent, or Lessee)  
before me this  
24th day of July, 2020.

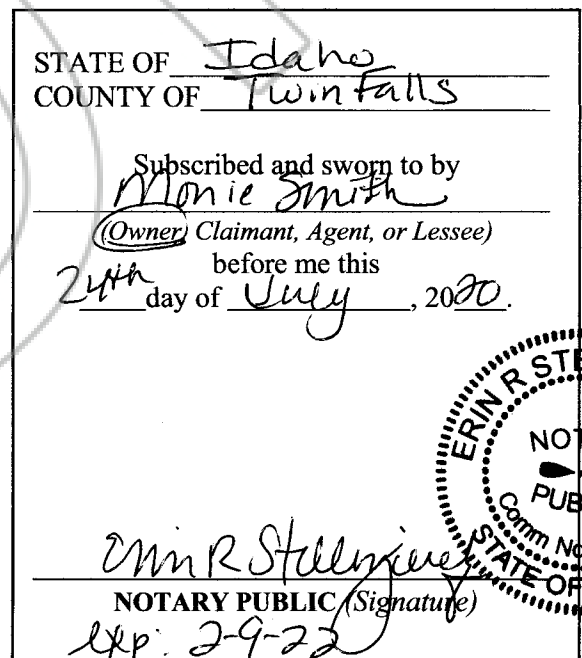

**Exhibit "M"**  
**MULE 1 and MULE 2 Claims**

**Owned in Undivided One-Third (1/3) Shares By:**  
**Aquarian Mining** (Todd Hopper, President, Molly Gerke and Dale Hopper);  
**Mathews** (Ric Mathews and Mike Mathews); and  
**Smith** (Ed and Phuong Smith; Monie Smith and Michael Johnson)

Two (2) contiguous unpatented lode mining claims situate in Section 3, North 1/2, Township 26 North, Range 48 East, MDB&M, in the County of Eureka, State of Nevada, and which claims are known as the Mule 1 and Mule 2 Claims, and are more specifically named and identified as follows:

COMMON NAME	BLM SERIAL NUMBER	COUNTY BOOK : PAGE
Mule #1	NMC 857561	275:286
Mule #2	NMC 857562	275:286