

**SURVEYOR'S CERTIFICATE**

1. ROBERT E. MORLEY, A PROFESSIONAL LAND SURVEYOR LICENSED IN THE STATE OF NEVADA, CERTIFY THAT:  
 1. THIS PLAT REPRESENTS THE RESULTS OF A SURVEY CONDUCTED UNDER MY DIRECT SUPERVISION AT THE INSTANCE OF LAMON NEWSON.  
 2. THE LANDS SURVEYED LIE WITHIN SECTION 1, T.29 N., R.48 E., M.D.B. & M., AND THE SURVEY WAS COMPLETED ON NOVEMBER 11, 2020.  
 3. THE MONUMENTS DEPICTED ON THE PLAT ARE OF THE CHARACTER SHOWN, AND OCCUPY THE POSITIONS INDICATED AND ARE OF SUFFICIENT NUMBER AND DURABILITY.

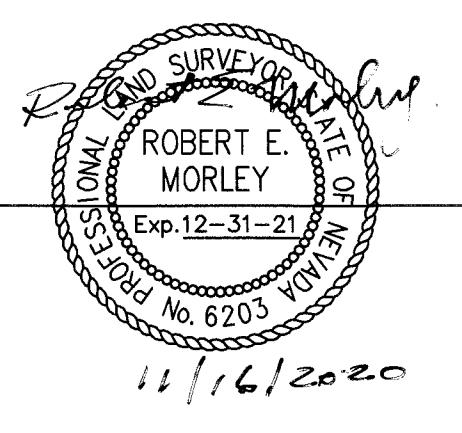

ROBERT E. MORLEY, P.L.S. 6203

**NOTES:**

- 1) THE TOTAL SURVEYED AREA OF THIS MAP EQUALS 17.055 ACRES.
- 2) BASIS OF BEARINGS: THE LINE BETWEEN THE FOUND NORTHWEST CORNER AND WEST 1/4 CORNER OF SECTION 1, T.29 N., R.48 E., M.D.B. & M., TAKEN AS S 01° 23' 05" W.

**LEGEND**

- ◇ = FOUND SECTION CORNER AS NOTED.
- ◆ = FOUND 1/4 CORNER AS NOTED.
- = SET 5/8" REBAR WITH CAP MARKED PLS 6203.
- = CALCULATED POINT, NOTHING FOUND, NOTHING SET.

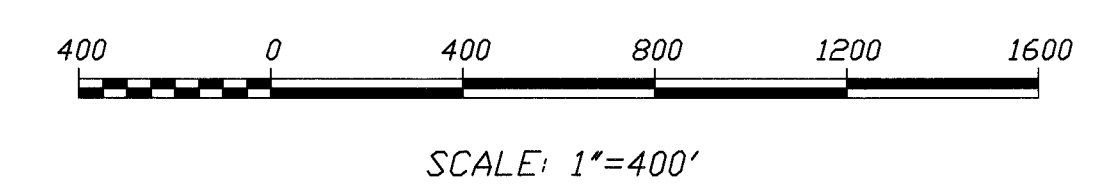

EUREKA COUNTY, NV 2020-242327  
 LINC-805 11/23/2020 13:35:748  
 04:33:08 FAHLS25:00  
 HIGH DESERT ENGINEERING LLC  
 WWWWZ 000944227091015  
 USA HOENNE OLERK RECORDER

**RECORD OF SURVEY**  
 FOR  
**LAMON NEWSON**  
 IN  
 SECTION 1, T.29 N., R.48 E., M.D.B. & M.  
 EUREKA COUNTY, NEVADA

**220076**

**HIGH DESERT ENGINEERING, LLC**  
 640 IDAHO STREET  
 ELKO, NEVADA 89801  
 (775) 738-4053