

**T 18 N -- R 52 E**  
**EUREKA COUNTY, NEVADA**

FROM BENCH MARK (JRH 54) SITUATED IN THE NW QUARTER OF SECTION 14, T18N, R52E,  
BEAR NORTH 52°48'26" WEST 3518 FEET TO CORNER #3 THE SE CORNER OF RX # 8.

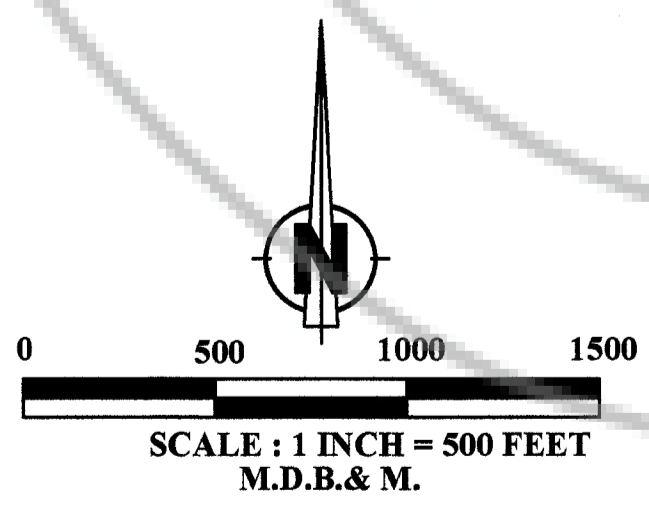

EUREKA COUNTY, NV 2021-244765  
MINING MAP Rev: 05/10/2021 11:54 AM  
Total \$237.00 Pgs: 1  
MKS INC  
00012882210247659010015  
USA - OEHNE, CLERK RECORDER

**LOCATION DATES:**  
**APRIL 9, 2021 -- RX 1-8.**  
**APRIL 10, 2021 -- RX 9-15.**

⊙ INDICATES A FOUND SECTION CORNER.

TYPICAL CLAIM & CORNER NUMBERS

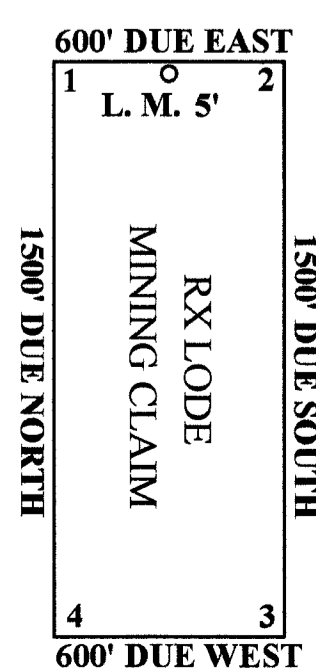

**TIE POINTS:**  
FROM BENCH MARK (JRH 54) SITUATED IN THE NW QUARTER OF SECTION 14, T18N, R52E,  
BEAR NORTH 52°48'26" WEST 3518 FEET TO CORNER #3 THE SE CORNER OF RX # 8.

UNSURVEYED TOWNSHIP SECTIONS ARE PROJECTED.  
BEARINGS BASED ON UTM NORTH COORDINATES.  
ALL CLAIM CORNERS AND LOCATION MONUMENTS ARE 1.5" X 1.5" X 4" WOOD POST.  
ALL CLAIM LOCATION MONUMENTS SET IN 5 FEET FROM CLAIM END CENTER UNLESS NOTED.  
ALL CLAIM ARE 600 FEET WIDE BY 1500 FEET LONG UNLESS NOTED ON MAP.

**DISCOVER, LOCATOR, AND CLAIMANT:**  
MINFOCUS EXPLORATION INC.  
440-755 BURRDARD STREET  
VANCOUVER, B.C., CANADA V3N4A2

RX LODE MINING CLAIMS  
NUMBERS 1 - 15  
SECTIONS  
9; 10; 15; & 16, T18N, R52E, M.D.B.&M.  
EUREKA COUNTY, NEVADA