

Assessor Parcel
No: Exempt - transfer of royalty interests
to a wholly-owned subsidiary

This document was prepared by
and after recording return to:

Debe Thomas
Bryan Cave Leighton Paisner
1700 Lincoln Street, Suite 4100
Denver, Colorado 80203

EUREKA COUNTY, NV	2021-247503
RPTT:\$0.00 Rec:\$37.00	
\$37.00 Pgs=22	12/03/2021 11:36 AM
FNTIC - NCS COLORADO DOWNTOWN	
LISA HOEHNE, CLERK RECORDER	E09

Statement of taxes should be sent to:

RSN, LLC
7309 E 21 St. N., Suite 120
Wichita, Kansas 67206

SPECIAL WARRANTY MINERAL DEED

THIS SPECIAL WARRANTY MINERAL DEED (this "Deed"), made this 19th day of December, 2021, is from Lincoln Minerals L.C., a Kansas limited liability company duly qualified to do business in Nevada, whose address for purposes hereof is 7309 E 21 St. N., Suite 120, Wichita, Kansas 67206 ("Grantor"), to RSN, LLC, a Nebraska limited liability company, whose address for purposes hereof is 7309 E 21 St. N., Suite 120, Wichita, Kansas 67206 ("Grantee").

For \$10.00 and other good and valuable consideration, the receipt and sufficiency of which are hereby acknowledged by Grantor, Grantor hereby grants, bargains, sells, conveys, transfers, assigns and delivers to Grantee all of Grantor's right, title and interest in and to the lands and unpatented mining claims described on Exhibit A attached hereto and incorporated herein, including without limitation all royalty interests, acquired by the Grantor pursuant to that certain Warranty Deed, dated February 21, 1995, from Lincoln Minerals, L.P., a Kansas limited partnership, to Grantor, recorded in the official records of Elko County, Nevada, on April 13, 1995, in Book 889 at Page 118, as document number 366676, in the official records of Eureka County, Nevada, on May 1, 1995, in Book 282 at Page 454, as document number 157877, in the official records of Humboldt County, Nevada, on May 15, 1995, in Book 342 at Page 738, as document number 356138, and in the official records of Lander County, Nevada, on June 23, 1995, in Book 418 at Page 6, as document number 193747.

EXCEPTING AND RESERVING to Grantor all of the Grantor's right, title and interest in and to (i) the barite in, on or under or that may be produced from the lands described on Exhibit B attached hereto and incorporated herein (the "Barite Property"), together with all rights incident or appurtenant thereto, including without limitation, all rights to use the surface in

EXHIBIT A

Property Description

That certain real property located in Elko, Lander, Humboldt and Eureka Counties, Nevada,
described in the attached document:

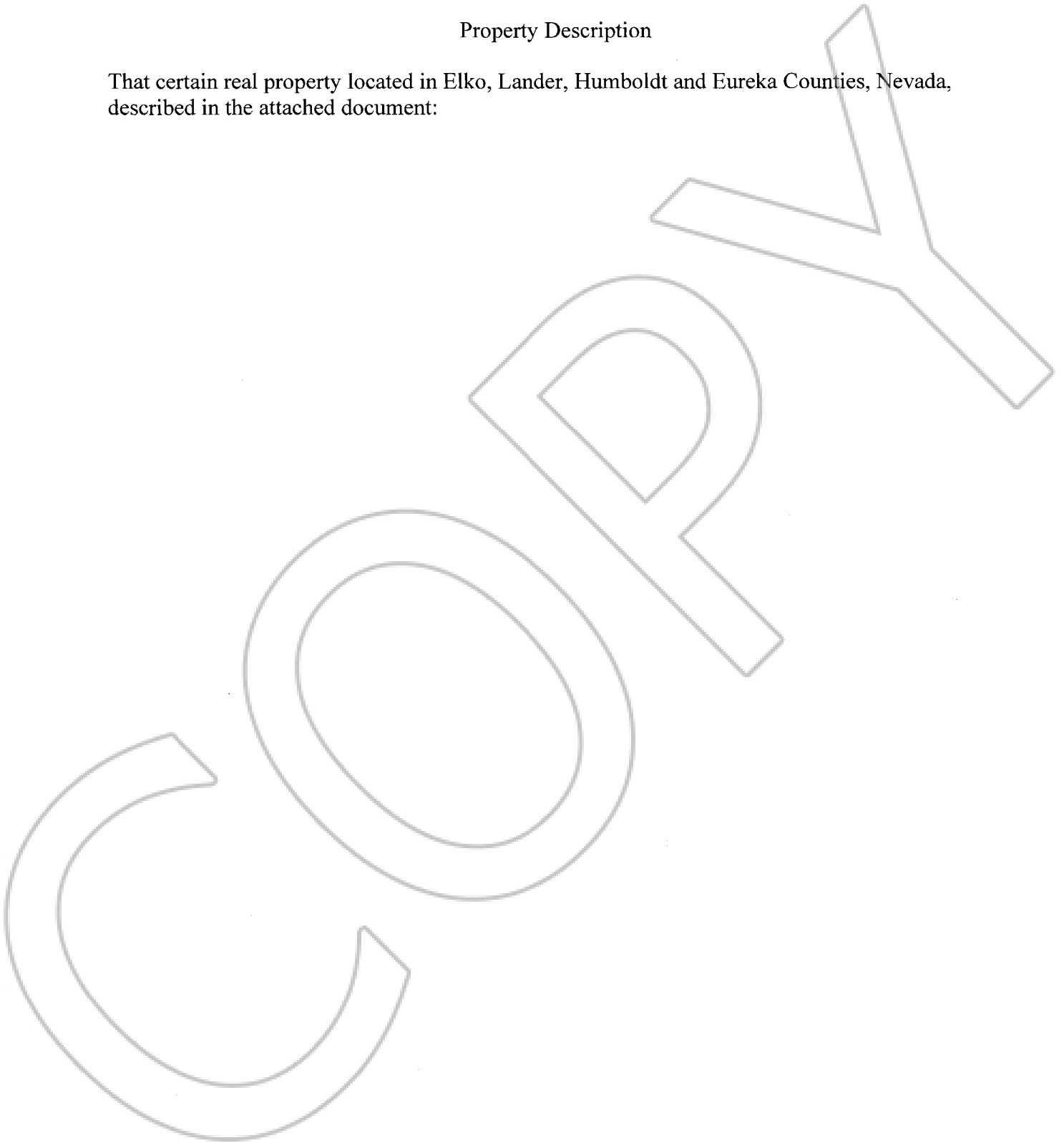

NEVADA LAND LEGAL DESCRIPTIONS

Legal				Number of Acres	Legal Descriptions
County	Twp. North	Range East	Sec#		
LANDER	32	45	1	639.38	ALL
			2	638.58	ALL
				<u>1,277.96</u>	
LANDER	32	46	6	77.18	LOT 6(NW4SW4); NE4SW4 LOTS 3&4(N2NW4)
			6	77.49	
				<u>154.67</u>	
HUMBOLDT	33	44	4	561.19	W2E2E2; W2E2; W2
			5	642.00	ALL
			8	80.00	N2NE4
			9	480.00	W2E2E2; W2E2; E2SW4; NW4
			16	320.00	W2E2E2; W2E2; E2NW4
			21	40.00	W2E2NE4
				<u>2,123.19</u>	
LANDER	33	44	3	280.41	W2NW4; SW4SE4; SW4
			4	80.19	E2E2E2
			9	80.00	E2E2E2
			10	640.00	ALL
			12	595.50	N2NE4; SW4NE4; W2; SE4 EXCEPTING THEREFROM 4.5 ACRES, MORE OR LESS, AS CONVEYED BY DEED DATED AUGUST 9, 1907, EXECUTED BY RUSSELL LAND AND CATTLE COMPANY TO WESTERN PACIFIC RAILWAY COMPANY, RECORDED IN BOOK 51, PAGE 183, DEED RECORDS OF LANDER COUNTY, NEVADA.
			14	440.00	NW4NW4; S2NW4; S2
			15	640.00	ALL
			16	80.00	E2E2E2
			21	40.00	E2E2NE4
			22	600.00	N2; SE4; N2SW4; SE4SW4
			23	640.00	ALL
			24	640.00	ALL
			25	640.00	ALL
			26	640.00	ALL
			36	610.00	ALL, EXCEPTING THEREFROM 30 ACRES, MORE OR LESS, AS CONVEYED BY DEED DATED APRIL 22, 1903, EXECUTED BY RUSSELL AND BRADLEY LAND AND CATTLE COMPANY TO CENTRAL PACIFIC RAILWAY COMPANY; RECORDED IN BOOK 49, PAGE 754, DEED RECORDS OF LANDER COUNTY, NEVADA.
				<u>6,646.10</u>	

NEVADA LAND LEGAL DESCRIPTIONS

Legal			
County	Twp. North	Range East	Sec#

Number of Acres

Legal Descriptions

			29	479.83
			33	323.14
				<u>8,438.91</u>

DEGREES 22 MINUTES EAST 572.30 FEET, MORE OR LESS, TO A POINT OF INTERSECTION WITH THE NORTH LINE OF THE SOUTHWEST QUARTER OF SAID SECTION 25.
 N2SW4; LOTS 1&2(S2SW4); N2 LOTS 1,2,7&8(NE4); LOTS 9,10,11&12(SW4)

LANDER	33	47	5	480.40
			7	467.40
			9	113.50

LOTS 1,2,3&4(N2N2); S2N2; SW4 LOTS 1,2,3&4(W2W2); NE4; E2W2
 ALL THAT PORTION OF THE NORTHEAST QUARTER LYING WESTERLY AND NORTHWESTERLY OF THE FOLLOWING DESCRIBED LINE; COMMENCING AT THE SOUTHWEST CORNER OF SAID SECTION 9; THENCE SOUTH 89 DEGREES 54 MINUTES EAST 518.00 FEET; THENCE NORTH 45 DEGREES 30 MINUTES EAST 3,759.10 FEET, MORE OR LESS, TO A POINT OF INTERSECTION WITH THE SOUTH LINE OF THE NORTHEAST QUARTER OF SAID SECTION 9 AND THE ACTUAL POINT OF BEGINNING OF THE LINE TO BE DESCRIBED; THENCE FROM SAID POINT CONTINUING NORTH 45 DEGREES 30 MINUTES EAST 2,894.20 FEET MORE OR LESS, TO A POINT OF INTERSECTION WITH THE EAST LINE OF SAID SECTION 9.
 ALL THAT PORTION LYING NORTHERLY AND NORTHWESTERLY OF THE FOLLOWING DESCRIBED LINE; BEGINNING AT A POINT ON THE EAST LINE OF SAID SECTION 17, THAT IS DISTANT SOUTHERLY THEREON, 667.50 FEET FROM THE NORTHEAST CORNER OF SAID SECTION 17; THENCE SOUTH 38 DEGREES 51 MINUTES WEST 1,400.00 FEET; THENCE SOUTH 63 DEGREES 15 MINUTES WEST 1,960.00 FEET MORE OR LESS, TO A POINT OF INTERSECTION WITH THE SOUTH LINE OF THE NORTHEAST QUARTER OF SAID SECTION 17.

<u>1,174.55</u>

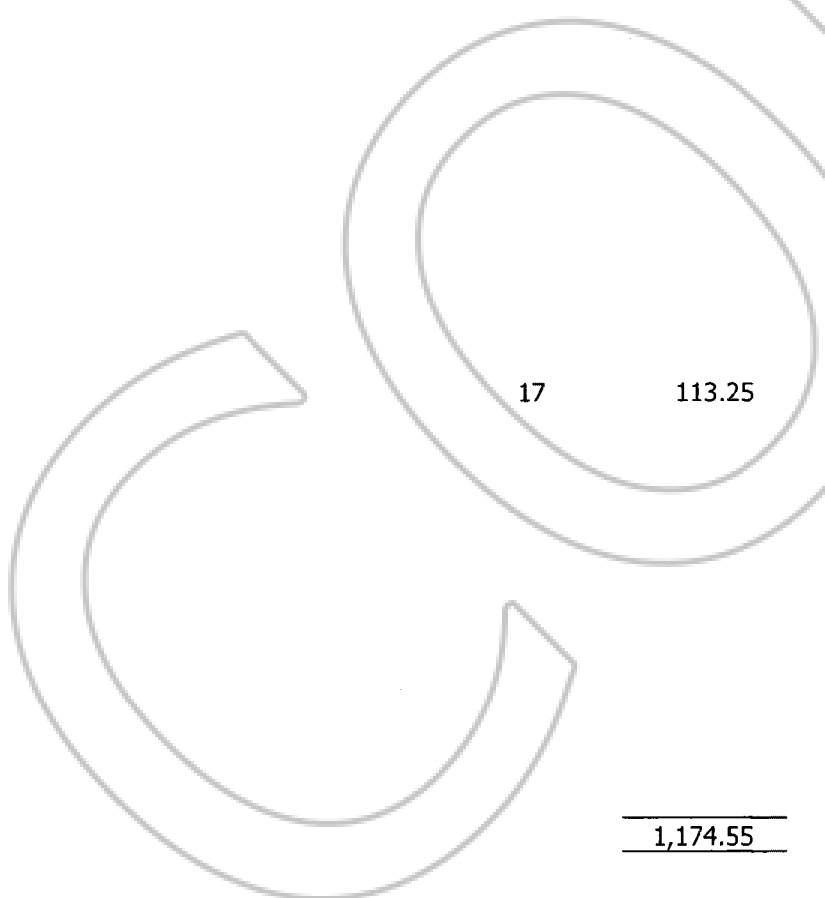

NEVADA LAND LEGAL DESCRIPTIONS

Legal				Number of Acres	Legal Descriptions
County	Twp. North	Range East	Sec#		
HUMBOLDT	34	44	31	626.30	ALL
			32	640.00	ALL
			33	560.00	W2E2; W2; W2E2E2
				<u>1,826.30</u>	
LANDER	34	44	26	280.00	NW4; N2SW4; SE4SW4
			33	80.00	E2E2E2
			36	160.00	SW4NW4; N2SW4; SE4SW4
			36	120.00	NW4SE4; E2SE4
				<u>640.00</u>	
LANDER	34	46	1	661.24	ALL
			3	664.16	ALL
			5	668.84	ALL
			7	583.96	ALL
			9	640.00	ALL
			11	640.00	ALL
			13	640.00	ALL
			15	640.00	ALL
			17	640.00	ALL
			19	584.28	ALL
			21	640.00	ALL
			23	640.00	ALL
			25	640.00	ALL
			27	640.00	ALL
			29	640.00	ALL
			31	584.44	ALL
			33	640.00	ALL
35	640.00	ALL			
				<u>11,426.92</u>	
LANDER	34	47	1	680.68	ALL
			3	640.00	ALL
			5	640.00	ALL
			7	640.00	ALL
			9	640.00	ALL
			11	640.00	ALL
			13	506.75	LOTS 1&2(E2NE4); W2NE4; W2
			15	640.00	ALL
			17	640.00	ALL
			19	640.00	ALL
			21	640.00	ALL
			23	479.4.6	LOTS 1&2(S2SW4); N2SW4; N2
			25	302.27	LOTS 1&2(N2NE4); LOTS 6&7(W2SW4); AND THAT PORTION OF THE SOUTH HALF OF NORTHEAST QUARTER LYING WESTERLY AND NORTHWESTERLY OF THE

NEVADA LAND LEGAL DESCRIPTIONS

Legal			
County	Twp. North	Range East	Sec#

Number of Acres

Legal Descriptions

27	480.12
29	640.00
31	652.40
33	676.56
35	306.09

FOLLOWING DESCRIBED LINE: BEGINNING AT A POINT ON THE EAST LINE OF SAID SECTION 25, THAT IS DISTANT SOUTHERLY THEREON 1,690.20 FEET FROM THE NORTHEAST CORNER OF SAID SECTION 25; THENCE SOUTH 44 DEGREES 00 MINUTES WEST 1,320.30 FEET, MORE OR LESS, TO A POINT OF INTERSECTION WITH THE SOUTH LINE OF THE NORTHEAST QUARTER OF SAID SECTION 25. AND THAT PORTION OF THE EAST HALF OF SOUTHWEST QUARTER LYING WESTERLY AND NORTHWESTERLY OF THE FOLLOWING DESCRIBED LINE: COMMENCING AT THE NORTHEAST CORNER OF SAID SECTION 25; THENCE SOUTHERLY ALONG THE EAST LINE OF SAID SECTION 25, A DISTANCE OF 1,690.20 FEET; THENCE SOUTH 44 DEGREES 00 MINUTES WEST 3,762.80 FEET, MORE OR LESS, TO A POINT OF INTERSECTION WITH THE EAST LINE OF THE SOUTHWEST QUARTER OF SAID SECTION 25 AND THE ACTUAL POINT OF BEGINNING OF THE LINE TO BE DESCRIBED; THENCE FROM SAID POINT, CONTINUING SOUTH 44 DEGREES 00 MINUTES WEST 1,253.00 FEET, MORE OR LESS, TO A POINT OF INTERSECTION WITH THE SOUTH LINE OF SAID SECTION 25. LOTS 1&2(E2NE4); LOTS 4&5(S2SW4); W2NE4; NW4; N2SW4 ALL

LOTS 1&2(N2NE4); LOTS 6&7(W2SW4); AND THAT PORTION OF THE S2 OF NE4 LYING WESTERLY AND NORTHWESTERLY OF THE FOLLOWING DESCRIBED LINE: COMMENCING AT THE SOUTHWEST CORNER OF SAID SECTION 35; THENCE EASTERLY ALONG THE SOUTH LINE OF SAID SECTION 35, A DISTANCE OF 1,801.80 FEET; THENCE NORTH 44 DEGREES 30 MINUTES EAST 3,758.80 FEET, MORE OR LESS TO A POINT OF INTERSECTION WITH THE SOUTH LINE OF

NEVADA LAND LEGAL DESCRIPTIONS

Legal			
County	Twp. North	Range East	Sec#

Number of Acres

Legal Descriptions

THE NORTHEAST QUARTER OF SAID SECTION 35, AND THE ACTUAL POINT OF BEGINNING OF THE LINE TO BE DESCRIBED; THENCE FROM SAID POINT CONTINUING NORTH 44 DEGREES 30 MINUTES EAST 1,255.40 FEET, MORE OR LESS TO A POINT OF INTERSECTION WITH THE EAST LINE OF SAID SECTION 35. AND THAT PORTION OF THE E2 OF SW4 LYING WESTERLY AND NORTHWESTERLY OF THE FOLLOWING DESCRIBED LINE; BEGINNING AT A POINT ON THE SOUTH LINE OF SAID SECTION 35, THAT IS DISTANT EASTERLY THEREON 1,801.80 FEET FROM THE SOUTHWEST CORNER OF SAID SECTION 35; THENCE NORTH 44 DEGREES 30 MINUTES EAST 1,251.60 FEET, MORE OR LESS, TO A POINT OF INTERSECTION WITH THE EAST LINE OF THE SOUTHWEST QUARTER OF SAID SECTION 35.

10,484.33

EUREKA	34	48	5	<u>480.40</u>	LOTS 1,2,3&4(N2N2); S2N2; SW4
				<u>480.40</u>	
LANDER	34	48	7	<u>459.36</u>	LOTS 1,2,3&4(W2W2); E2W2; NE4
				<u>459.36</u>	
LANDER	35	45	9	120.00	E2SE4; SW4SE4
			10	400.00	N2; W2SW4
			10	240.00	E2SW4; SE4
			16	280.00	N2NE4; SW4NE4; S2NW4; NW4SW4;
			20	120.00	NE4NW4
			<u>1,160.00</u>	NW4NE4; N2NW4	
ELKO	36	45	4	120.00	SE4NE4; E2SE4
			10	160.00	NW4NW4; SE4NW4; NE4SW4; SW4SW4
			16	40.00	NW4NE4
			<u>320.00</u>		
ELKO	36	46	1	79.96	LOT 1(NE4NE4); SE4NE4
			5	160.00	SW4SE4; NW4SW4; S2SW4
			6	240.19	LOTS 1,2,3,&4(N2N2); SE4NE4; NW4SE4
			6	40.00	NE4SE4
			7	160.00	N2SE4; SE4SE4; NE4SW4
			7	78.29	LOT 2(SW4NW4); LOT 3(NW4SW4)

NEVADA LAND LEGAL DESCRIPTIONS

Legal				Number of Acres	Legal Descriptions
County	Twp. North	Range East	Sec#		
			8	160.00	NW4NE4; S2NE4; NE4NW4
			9	40.00	SE4SW4
			17	160.00	SW4NE4; N2NW4; SE4NW4
			18	40.00	NE4NE4
				<u>1,158.44</u>	
LANDER	36	46	16	120.00	SW4SE4; N2SW4
			17	40.00	NE4SE4
				<u>160.00</u>	
ELKO	36	47	6	119.79	LOT 5(SW4NW4); W2SW4
			7	156.32	SW2W2
			10	40.00	SE4SE4
			11	240.00	N2SE4; SW4
			12	240.00	N2NE4; NE4NW4; S2NW4; NW4SW4
			15	240.00	N2NE4; SW4NE4; NE4NW4; S2NW4
			16	40.00	SE4NE4
			18	78.71	LOT 1(NW4NW4); LOT 2(SW4NW4)
				<u>1,154.82</u>	
LANDER	36	47	16	200.00	N2SE4; S2SW4; SW4SE4
			18	79.31	LOT 3(NW4SW4); LOT 4(SW4SW4)
			19	359.13	NW4; W2SE4; N2SW4; SE4SW4
			20	280.00	NE4NE4; S2NE4; NW4SE4; NE4SW4;
					S2SW4
			21	80.00	N2NW4
			29	40.00	NW4NW4
			30	200.00	NE4NE4; W2E2
			30	160.00	SE4NE4; SE4NW4; E2SW4
				<u>1,398.44</u>	
ELKO	36	48	5	198.42	LOT 2(NW4NE4); LOTS 3&4(N2NW4);
					S2NW4
			6	279.02	LOTS 6&7(W2SW4); SE4NE4; E2SW4;
					N2SE4
				<u>477.44</u>	
ELKO	36	51	5	80.00	NW4SW4; SE4SW4
			6	195.76	SE4NE4; SW4NW4; NE4SE4; W2SW4
			6	158.03	LOT 2(NW4NE4); LOTS 3&4(N2NW4);
					SW4NE4
			8	80.00	N2NW4
				<u>513.79</u>	
ELKO	37	45	26	40.00	NW4NW4
			36	80.00	SE4NE4; SW4SE4
				<u>120.00</u>	

NEVADA LAND LEGAL DESCRIPTIONS

Legal				Number of Acres	Legal Descriptions			
County	Twp. North	Range East	Sec#					
ELKO	37	46	13	40.00	SE4SE4			
			24	280.00	E2E2; SW4NE4; W2SE4			
			25	280.00	E2E2; W2NE4; SW4SE4			
			25	200.00	E2W2; NW4SE4			
			28	80.00	S2NW4			
			29	160.00	S2N2			
			30	120.00	NW4NE4; SE4NE4; NE4NW4			
			36	160.00	E2E2			
			36	80.00	NW4NE4; NE4NW4			
							<u>1,400.00</u>	
			ELKO	37	47	13	40.00	SE4NE4
ELKO	37	48	6	240.52	LOT 1(NE4NE4); S2NE4; E2SW4; NW4SE4			
			7	200.00	SW4NE4; E2NW4; W2SE4			
			17	80.00	N2SW4			
			18	237.71	LOT 2(SW4NW4); N2NE4; SE4NE4; SE4NW4; NE4SE4			
			20	40.00	NE4NE4			
			25	200.00	S2S2; NE4SE4			
			26	120.00	S2SE4; SE4SW4			
			28	120.00	W2SE4; SE4SW4			
			32	120.00	NE4SE4; S2SE4			
			33	320.00	NE4; E2NW4; N2SW4			
			34	160.00	N2N2			
			35	40.00	NW4NW4			
							<u>1,878.23</u>	
			ELKO	37	49	2	40.33	LOT 4(NW4NW4)
						3	161.10	LOTS 1,2,3&4(N2N2)
						4	281.22	LOTS 1&2(N2NE4); LOT 3(NE4NW4); S2NW4; W2SW4
5	280.63	LOT 2(NW4NE4); SW4NE4; NW4SE4; S2SE4; E2SW4						
6	75.37	LOT 4(NW4NW4); LOT 7(SW4SW4)						
7	37.91	LOT 4(SW4SW4)						
8	240.00	W2NE4; E2W2						
13	160.00	NE4SE4; S2SE4; SE4SW4						
16	80.00	N2NE4						
17	320.00	W2NE4; E2NW4; SE4						
18	37.18	LOT 4(SW4SW4)						
19	38.30	LOT 4(SW4SW4)						
20	320.00	E2						
24	200.00	NE4NW4; W2W2						
25	280.00	W2W2; S2SE4; SE4SW4						

NEVADA LAND LEGAL DESCRIPTIONS

Legal				Number of Acres	Legal Descriptions
County	Twp. North	Range East	Sec#		
			25	120.00	N2NE4; NE4NW4
			26	40.00	SE4SE4
			29	160.00	NW4NE4; N2NW4; SW4NW4
			30	276.80	NE4NE4; S2NE4; NW4SE4; NE4SW4; LOT 3(NW4SW4); LOT 4(SW4SW4)
			35	80.00	E2NE4
			36	80.00	N2NE4
			36	40.00	NW4NW4
				<u>3,348.84</u>	
ELKO	7	50	3	221.52	LOT 1(NE4NE4); LOT 3(NE4NW4); S2SW4; S2SE4
			6	39.94	LOT 2(NW4NE4)
			6	158.48	LOT 5(SW4NW4); SE4NW4; E2SW4
			7	200.00	E2NW4; NE4SW4; SE4SW4; SW4SE4
			8	80.00	NE4SE4; SW4SE4
			9	200.00	NE4NE4; S2NE4; N2SW4
			10	190.99	NE4NW4; S2NW4; NW4SE4; SE4SE4
			15	262.01	LOTS 1&2(E2NE4); SW4NE4; NE4SW4; S2SW4; NW4SE4
			16	40.00	SW4SE4
			17	240.00	E2NW4; SW4
			18	278.40	LOT 2(SW4NW4); LOT 3(NW4SW4); E2NW4; NE4SW4; N2SE4
			18	40.00	SW4SE4
			19	40.00	NE4NE4
			20	280.00	NE4NW4; N2NE4; SE4NE4; SE4NW4; E2SW4
			20	40.00	NW4NW4
			20	80.00	E2SE4
			21	400.00	W2NW4; N2NE4; NE4NW4; N2SW4; SE4SW4; S2SE4
			22	391.05	SW4SW4; LOT 2(SE4NE4); NW4NE4; N2NW4; N2SW4; SE4SW4; W2SE4
			27	200.00	E2SW4; W2NW4; NW4SW4
			28	160.00	SE4NW4; N2SW4; SW4SW4
			28	160.00	N2NW4; N2SE4
			29	160.00	SE4NW4; NE4SW4; W2SE4
			29	160.00	N2N2
			30	40.00	NE4NE4
			30	119.41	NW4NE4; N2NW4
			31	159.37	S2N2
			32	240.00	NW4NE4; NE4NE4; S2NE4; NE4SW4; NW4SE4
			32	160.00	NW4
			33	120.00	NW4NE4; N2NW4

NEVADA LAND LEGAL DESCRIPTIONS

Legal			
County	Twp. North	Range East	Sec#

Number of Acres

Legal Descriptions

County	Twp. North	Range East	Sec#	Number of Acres	Legal Descriptions
			34	223.41	LOTS 1&2(E2NE4); W2SE4; NW4NE4; NE4NW4
				<hr/>	
				5,084.58	

ELKO	37	51	1	599.36	LOTS 1,2,3&4(N2N2); S2NE4; SE4NW4; S2 LOT 1(NE4NE4); SW4NE4; SE4NW4; N2SW4; NW4SE4 W2W2 LOT 1 (NE4NE4) ; SW4NW4; S2 LOT 2(NW4NE4); SE4NE4 LOTS 1&2(W2NW4); LOT 3(NW4SW4); NW4NE4; NE4NW4; SW4SE4; S2SW4 NW4NE4; S2NE4; NE4NW4 S2SW4; S2NE4; SW4NW4; N2SW4; NW4SE4 ALL W2NE4; E2NW4 SW4SW4 S2NE4; NW4; NE4SW4; SE4 NW4SW4 SW4SW4; NW4NW4; E2SW4; N2SE4; SW4SE4 SW4SE4; N2SW4; SE4SW4; NW4SE4; SE4SE4; SW4NE4; E2NE4 SW4NE4; NW4NE4; SW4SE4; SE4SW4; LOT 4(SW4SW4) N2SE4 NE4SW4 SW4SW4; E2W2 NE4NW4; NW4SE4; S2SE4; SW4NE4; SE4NW4 SE4NE4; SE4NW4 N2; W2SE4 NW4NW4; SW4SW4 E2NE4; NE4SE4; S2S2 SW4NW4; SE4SE4; E2W2; W2E2 LOT 3(NW4SW4) NW4SE4; SE4NW4; E2SW4; NE4SE4 NE4NE4; W2NE4; N2S2; SE4SE4
			2	239.74	
			3	160.30	
			4	400.30	
			5	80.19	
			7	311.48	
			8	160.00	
			9	320.00	
			10	640.00	
			12	160.00	
			13	40.00	
			14	440.00	
			15	40.00	
			16	280.00	
			17	360.00	
			18	198.20	
			18	80.00	
			19	40.00	
			20	200.00	
			21	240.00	
			22	80.00	
24	400.00				
27	80.00				
28	280.00				
29	400.00				
30	38.57				
31	200.00				
32	320.00				
				<hr/>	
				6,788.14	

ELKO	37	52	2	281.15	LOT 2(NW4NE4); SW4NE4; SE4NW4; N2SW4; SW4SW4; NW4SE4
			3	240.00	SE4; N2SW4
			4	360.00	SW4NE4; S2NW4; SW4; N2SE4
			5	321.92	LOTS 1&2(N2NE4); S2NE4; SE4
			7	159.16	S2S2

NEVADA LAND LEGAL DESCRIPTIONS

Legal				Number of Acres	Legal Descriptions
County	Twp. North	Range East	Sec#		
			8	160.00	S2S2
			9	400.00	NW4; SE4; S2SW4
			10	400.00	E2NE4; S2
			11	200.00	NW4NW4; W2SW4; SW4NW4; NW4SE4
			18	160.00	W2E2
			19	398.05	W2NE4; S2NW4; N2SW4; SE4
				<u>3,080.28</u>	
ELKO	37	53	5	42.83	LOT 1(NE4NE4)
				<u>42.83</u>	
ELKO	38	47	12	160.00	NW4NW4; SE4NW4; W2SE4
			13	80.00	NE4NE4; NW4SW4
				<u>240.00</u>	
ELKO	38	48	1	80.00	SW4NE4; NW4SE4
			4	80.00	W2SW4
			12	120.00	SE4NW4; N2SW4
			16	80.00	SW4NW4; NW4SW4
			17	40.00	NW4NW4
			18	194.24	SW4NW4; N2SW4; S2SE4
			19	80.00	E2NE4
			20	80.00	W2NW4
				<u>754.24</u>	
ELKO	38	49	1	320.42	S2NE4; N2NW4; SE4NW4; N2SE4; SE4SE4
			2	40.29	NE4NE4
			7	40.00	SE4NE4
			8	160.00	S2N2
			9	80.00	W2SW4
			16	200.00	SW4SW4; W2NW4; E2SW4
			17	80.00	SE4SE4; SE4SW4
			19	77.81	LOT 4(SW4SW4); SE4SE4
			21	160.00	W2NW4; NW4SW4; SE4SW4
			22	120.00	NE4SE4; S2SE4
			23	200.00	NW4SE4; S2SE4; N2SW4
			24	40.00	SW4SW4
			25	280.00	SW4NW4; NE4; N2NW4
			26	120.00	SE4NE4; N2SW4
			27	240.00	W2NE4; SE4NW4; NE4SW4; S2SW4
			28	200.00	E2NW4; NW4SW4; S2SW4
			29	80.00	SE4SE4; NE4SW4
			30	40.00	NE4SE4
			31	38.11	LOT 1(NW4NW4)
			32	240.00	E2NE4; SE4NW4; S2SE4; NE4SW4
			33	120.00	NE4SE4; S2SE4
			34	280.00	W2W2; NE4SE4; S2SE4

NEVADA LAND LEGAL DESCRIPTIONS

Legal			
County	Twp. North	Range East	Sec#

Number of Acres
240.00
160.00
<u>3,556.63</u>

Legal Descriptions

			35	240.00	SW4NE4; N2S2; SW4SW4
			36	160.00	N2S2
				<u>3,556.63</u>	
ELKO	38	50	3	606.04	ALL
			4	638.76	ALL
			5	399.41	LOTS 1,2,3&4(N2N2); SE4NE4; SE4; SE4SW4
			6	37.71	SW4SW4
			7	317.73	N2NW4; SE4NW4; SE4; NE4SW4
			8	560.00	NE4; E2NW4; S2
			9	640.00	ALL
			10	605.37	ALL
			15	603.96	ALL
			16	640.00	ALL
			17	640.00	ALL
			18	320.00	E2
			19	400.00	E2; E2SW4
			20	640.00	ALL
			21	640.00	ALL
			22	603.32	ALL
			27	310.74	N2NE4; SW4NE4; NW4; NW4SW4
			28	520.00	N2; NW4SE4; SW4
			29	640.00	ALL
			30	632.72	ALL
			31	474.73	N2; N2S2
			32	480.00	N2; N2S2
				<u>11,350.49</u>	
ELKO	38	51	6	584.27	N2; SE4; N2SW4; SW4SW4
			7	472.32	N2NE4; SE4NE4; NW4; SE4SW4; SE4
			18	432.92	NE4; SE4NW4; E2SE4; SW4
			19	389.72	SE4SE4; E2NE4; SE4NW4; N2SE4; SE4SW4; LOTS 1&2(W2NW4); LOT 4(SW4SW4)
			20	160.00	S2S2
			21	80.00	S2SE4
			22	40.00	SW4SE4
			23	80.00	S2SW4
			25	640.00	N2; S2
			26	640.00	N2N2; S2N2; S2
			27	480.00	N2; N2S2
			28	400.00	NE4NE4; NW4NE4; S2NE4; NW4; N2SE4
			29	240.00	NE4; N2NW4
			30	427.52	W2; NE4NE4; W2NE4
			34	80.00	W2SW4
			35	640.00	ALL
			36	640.00	ALL

NEVADA LAND LEGAL DESCRIPTIONS

Legal			
County	Twp. North	Range East	Sec#

Number of Acres

Legal Descriptions

ELKO	38	52	1	200.03	LOT 1(NE4NE4); SE4NE4; N2SE4; SW4SE4			
			2	320.14	LOT 4(NW4NW4); SE4NW4; SW4; S2SE4			
			4	480.00	S2N2; S2			
			5	79.69	LOTS 1&2(N2NE4)			
			6	304.37	LOT 3(NE4NW4); LOTS 4,5,6&7(W2W2); SE4NW4; E2SW4			
			7	200.00	NE4; NE4NW4			
			8	200.00	SW4NW4; SW4			
			9	640.00	ALL			
			10	640.00	ALL			
			11	640.00	ALL			
			12	120.00	W2NE4; SW4SE4			
			13	440.00	NW4NE4; S2N2; N2S2; SE4SW4; SW4SE4			
			14	280.00	N2NE4; SE4NE4; SE4NW4; N2SW4; SW4SW4			
			15	400.00	NE4; SW4; E2NW4			
			15	240.00	SW2NW4; SE4			
			16	320.00	SW4NE4; N2NW4; SE4NW4; NE4SW4; S2SW4; NW4SE4			
			17	480.00	W2NE4; S2SE4; W2			
			18	40.00	SE4SE4			
			19	315.69	NW4NE4; SE4NW4; NE4SW4; LOT 4(SW4SW4); SE4			
			20	480.00	E2NW4; NW4SE4; SW4SE4; S2SW4; W2NW4; N2SW4; E2SE4			
			21	80.00	W2NW4			
			24	440.00	W2E2; E2W2; W2NW4; NW4SW4			
			25	360.00	SE4SE4; W2E2; E2W2			
			26	520.00	SW4NE4; NW4; S2			
			27	240.00	N2NW4; SE4NW4; SW4NE4; N2SE4			
			29	320.00	E2NW4; NE4SW4; SW4SW4; W2NW4; NW4SW4; SE4SW4			
			30	427.82	LOTS 1&2(W2NW4); LOT 4(SW4SW4); E2			
			31	396.91	N2SE4; W2NE4; N2SW4; S2S2			
			32	320.00	W2SE4; E2SE4; SW4			
			33	80.00	S2NW4			
			34	160.00	N2N2			
			35	520.00	N2; NE4SW4; SE4			
			36	520.00	N2NE4; SW4NE4; W2; N2SE4			
							<u>11,204.65</u>	
			ELKO	38	53	17	80.00	W2NW4
						32	80.00	NE4NE4; SW4NE4
33	400.00	SE4SW4; SW4SE4; N2NE4; NW4; N2SW4						
34	40.00	NW4NW4						

NEVADA LAND LEGAL DESCRIPTIONS

Legal				Number of Acres	Legal Descriptions
County	Twp. North	Range East	Sec#		
				600.00	
ELKO	39	49	8	40.00	SE4SE4
			9	160.00	S2S2
			10	160.00	S2S2
			11	160.00	S2S2
			12	80.00	S2SW4
			13	240.00	S2NE4; NW4
			14	240.00	NE4; E2NW4
			15	200.00	N2NE4; E2SE4; NE4SW4
			16	280.00	NW4NW4; SE4NW4; NW4SE4; S2SE4; NE4SW4; SW4SW4
			17	160.00	E2E2
			20	240.00	E2NE4; SE4
			21	400.00	S2NE4; NE4NW4; SW4NW4; W2SE4; SW4
			22	360.00	W2NW4; N2SE4; SE4SE4; SW4
			23	160.00	S2S2
			24	240.00	S2SE4; SW4
			25	640.00	ALL
			26	640.00	ALL
			27	640.00	ALL
			28	200.00	N2N2; SE4NE4
			29	160.00	NE4
			31	80.00	S2NE4
			34	160.00	N2NE4; SE4NE4; NE4NW4
			35	560.00	N2; SE4; N2SW4
			36	640.00	ALL
				<u>6,840.00</u>	
ELKO	39	50	7	156.83	S2S2
			10	110.90	LOT 3(NE4SE4); W2SE4
			15	302.41	SW4; W2SE4; LOTS 3&4(E2SE4)
			16	280.00	W2W2; N2SE4; NE4SW4
			17	640.00	ALL
			18	590.87	N2; SE4; NE4SW4; S2SW4
			19	508.36	N2; NW4SE4; SE4SE4; N2SW4; SW4SW4
			20	240.00	NW4NW4; SE4; SE4SW4
			21	640.00	E2SE4; N2; W2SE4; SW4
			22	542.67	N2NW4; W2NE4; S2NW4; SW4; W2SE4; LOTS 1&2(E2NE4)
			27	463.05	S2SW4; SW4SE4; NW4NE4; NW4; N2SW4; LOTS 3&4(E2SE4)
			28	640.00	NE4NE4; S2NE4; SE4NW4; N2SW4; SW4SW4; NW4SE4; NE4SE4; S2SE4; SE4SW4; NW4NE4; N2NW4; SW4NW4
			29	600.00	SE4SE4; NE4NE4; NE4SE4; W2E2; W2
			30	308.92	LOTS 1,2,3&4(W2W2); E2SW4; S2SE4

NEVADA LAND LEGAL DESCRIPTIONS

Legal				Number of Acres	Legal Descriptions
County	Twp. North	Range East	Sec#		
			31	589.76	N2; SE4; NW4SW4; S2SW4
			32	640.00	SW4NE4; SE4NW4; SE4NE4; SW4NW4; N2N2; S2
			33	640.00	NW4NE4; NW4NW4; E2NE4; NE4NW4; SW4NW4; SW4NE4; SE4NW4; S2
			34	606.50	S2NE4; E2NW4; S2; NW4NE4; NW4NW4; SW4NW4; LOT I (NE4NE4)
				<u>8,500.27</u>	
ELKO	39	51	36	160.00	E2E2
				<u>160.00</u>	
ELKO	39	52	21	40.00	SE4SE4
			22	480.00	E2NE4; SW4SW4; SE4SE4; E2W2; W2E2
			23	400.00	NW4NE4; S2NE4; NE4NW4; SW4NW4; N2SE4; SW4SE4; S2SW4
			24	160.00	S2S2
			25	120.00	NE4SW4; S2SW4
			26	160.00	NE4
			26	80.00	E2SE4
			28	240.00	NE4; NE4NW4; SE4SW4
			29	40.00	NE4SE4
			30	140.40	LOTS 1,2,3&4(W2W2)
			31	298.66	LOTS 1,2,3&4(W2W2); SW4NE4; SE4NW4; E2SW4
			32	240.00	SW4NE4; NW4SW4; S2S2
			33	240.00	NE4NE4; S2NE4; N2SE4; SW4SE4
			34	240.00	NW4; E2SE4
			34	80.00	W2SE4
			35	320.00	E2NE4; NW4; S2SW4
			35	160.00	N2S2
			36	640.00	ALL
				<u>4,079.06</u>	
ELKO	39	53	30	80.00	SW4NE4; NE4NW4
				<u>80.00</u>	
TOTALS	ALL TOWNSHIPS			<u>127,050.61</u>	

PROVIDED, HOWEVER, that with respect to the following, the Royalty Interests included in the lands described above, Grantor will convey the same without any representations or warranties of title whatsoever:

County Name	Twp. No.	Range East	Sec. No.	Acres	Legal Description
Lander	32	46	6	77.18	Lot 6 (NW4SW4); NE4SW4
			6	77.49	Lots 3&4(N2NW4)
Elko	36	46	18	40.00	NE4NE4
Lander	36	47	30	160.00	SE4NE4; SE4NW4; E2SW4
Elko	37	50	20	80.00	E2SE4
	37	51	18	80.00	N2SE4
	38	48	16	80.00	SW4NW4; NW4SW4
			18	194.24	SW4NW4; N2SW4' S2SE4
			19	80.00	E2NE4
			20	80.00	W2NW4

AND SUBJECT to the following:

- (1) Lease and Agreement dated January 1, 1987 between 25 Corp. and Samuel E. King
- (2) Exploration License and Option Agreement dated October 1, 1986 between 25 Corp. and Newmont Exploration Limited
- (3) Deed Granting Term Nonexecutive Interest – The 25 Ranch dated January 26, 1986 between 25 Corp. and Marvel Minerals
- (4) Deed Granting Term Royalty Interest – Lakes Mine dated January 26, 1986 between 25 Corp. and Richard T. Marvel, et al.
- (5) A 5/8 interest claimed by Newmont in the land more particularly described hereinafter
- (6) Amended Quitclaim Deed dated September 30, 1981 between 25 Corp. and Geo Drilling Fluids, Inc.
- (7) That certain unrecorded letter agreement dated May 13, 1985 between 25 Corp. and Willis Parker
- (8) Utility, highway, and railroad easements of record.

Unpatented Mining Claims

<u>Claim</u>	<u>Monumentation Date</u>	<u>BLM Claim No.</u>	<u>Eureka County Recorder No.</u>
Roger #2	September 7, 1985	NMC 351520	100592
Roger #4	September 7, 1985	NMC 351521	100593
Roger #6	September 7, 1985	NMC 351522	100594
Roger #8	September 7, 1985	NMC 351523	100595
Roger #10	September 7, 1985	NMC 351524	100596
Roger #12	September 8, 1985	NMC 351525	100597
Roger #14	September 8, 1985	NMC 351526	100598
Roger #16	September 8, 1985	NMC 351527	100599
Roger #18	September 8, 1985	NMC 351528	100600
Roger #25	September 12, 1985	NMC 351529	100601
Roger #26	September 12, 1985	NMC 351530	100602
Roger #27	September 12, 1985	NMC 351531	100603
Roger #28	September 12, 1985	NMC 351532	100604
Roger #29	September 12, 1985	NMC 351533	100605
Roger #30	September 12, 1985	NMC 351534	100606
Roger #31	September 13, 1985	NMC 351535	100607
Roger #32	September 13, 1985	NMC 351536	100608
Roger #33	September 13, 1985	NMC 351537	100609
Roger #34	September 13, 1985	NMC 351538	100610
Roger #35	September 13, 1985	NMC 351539	100611
Roger #36	September 13, 1985	NMC 351540	100612
Roger #37	September 13, 1985	NMC 351541	100613
Roger #38	September 13, 1985	NMC 351542	100614
Roger #39	September 13, 1985	NMC 351543	100615
Roger #40	September 13, 1985	NMC 351544	100616
Roger #41	September 13, 1985	NMC 351545	100617
Roger #42	September 13, 1985	NMC 351546	100618

<u>Claim</u>	<u>Monumentation Date</u>	<u>BLM Claim No.</u>	<u>Lander County Recorder No.</u>
Roger #1	September 16, 1985	NMC 352213	130439
Roger #3	September 17, 1985	NMC 352214	130440
Roger #9	September 16, 1985	NMC 352215	130441
Roger #11	September 8, 1985	NMC 352216	130442
Roger #13	September 8, 1985	NMC 352217	130443
Roger #15	September 8, 1985	NMC 352218	130444
Roger #17	September 8, 1985	NMC 352219	130445
Roger #19	September 10, 1985	NMC 352220	130447
Roger #20	September 10, 1985	NMC 352221	130448
Roger #21	September 10, 1985	NMC 352222	130449
Roger #22	September 11, 1985	NMC 352223	130450
Roger #23	September 11, 1985	NMC 352224	130451
Roger #24	September 11, 1985	NMC 352225	130452

AND SUBJECT to Newmont's claim of 5/8 interest in the minerals in the following described lands:

Township 37 North, Range 49 East, M.D.B. M.

Section 25: S1/2SE1/4; SE1/4SW1/4; N1/2NE1/4; NE1/4NW1/4

Section 35: E1/2NE1/4
Section 36: N1/2NE1/4; NW1/4NW1/4

Township 37 North, Range 50 East, M.D.B. M.

Section 18: SW1/4SE1/4
Section 19: NE1/4NE1/4
Section 20: NW1/4NW1/4
Section 28: N1/2SE1/4; N1/2NW1/4
Section 29: N1/2N1/2
Section 30: N1/2NW1/4; NW1/4/NE1/4
Section 31: S1/2N1/2
Section 32: NW1/4

Containing 1,320 acres, more or less

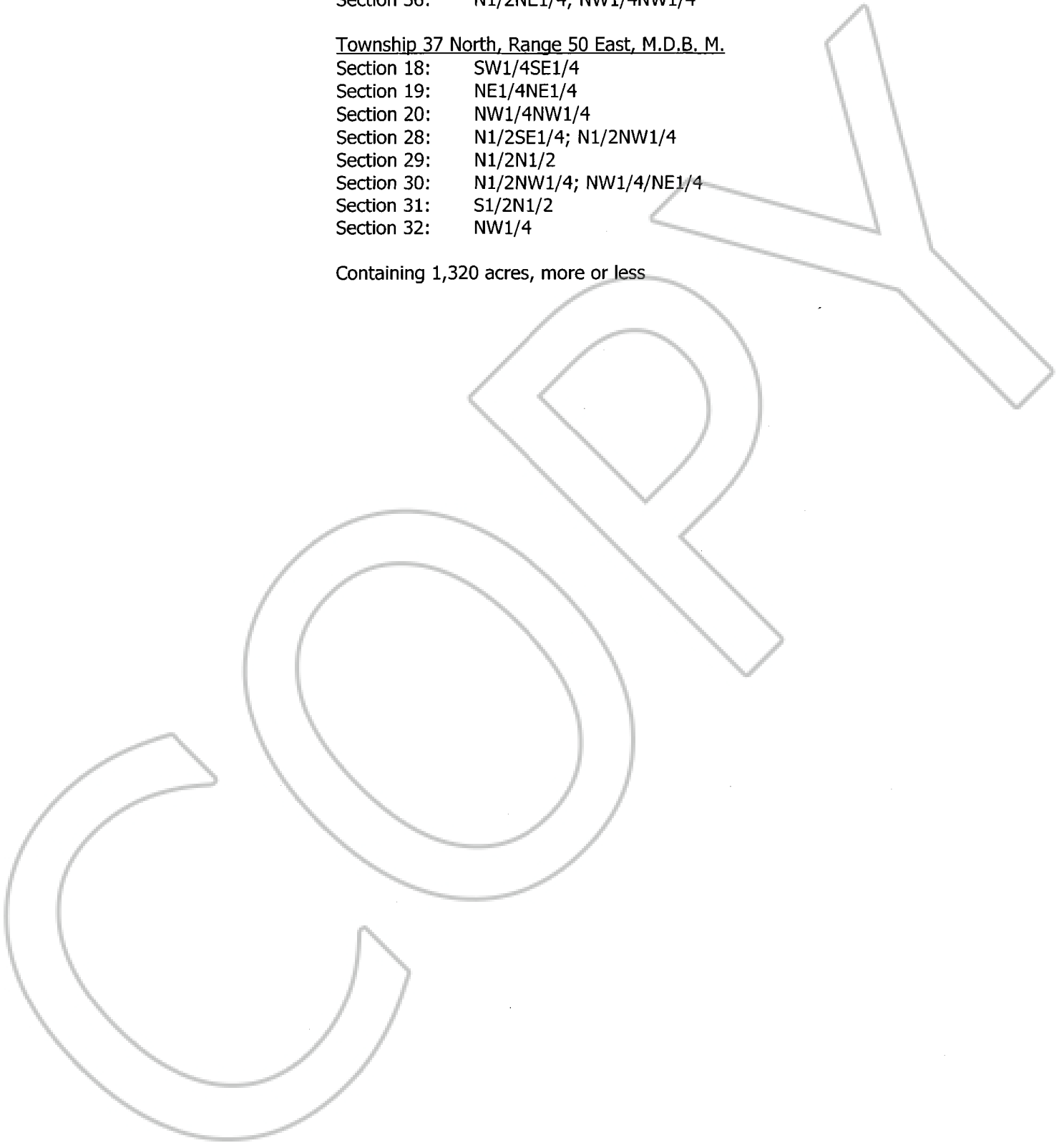

EXHIBIT B

The Barite Estate

The Barite Estate includes barite in the following described lands located in Elko County, Nevada, known as the "Lakes Mine":

T. 37 N., R. 51 E., M.D.B. & M.

Section 1: Lots 1, 2, 3 & 4 ($N\frac{1}{2}N\frac{1}{2}$); $S\frac{1}{2}NE\frac{1}{4}$; $SE\frac{1}{4}NW\frac{1}{4}$; $S\frac{1}{2}$

Section 2: Lot 1 ($NE\frac{1}{4}NE\frac{1}{4}$); $SW\frac{1}{4}NE\frac{1}{4}$; $SE\frac{1}{4}NW\frac{1}{4}$; $N\frac{1}{2}SW\frac{1}{4}$; $NW\frac{1}{4}SE\frac{1}{4}$

T. 38 N., R. 51 E., M.D.B. & M.

Section 25: All

Section 26: All

Section 35: All

Section 36: All

T. 38 N., R. 52 E., M.D.B. & M.

Section 30: Lots 1 & 2 ($W\frac{1}{2}NW\frac{1}{4}$); Lot 4 ($SW\frac{1}{4}SW\frac{1}{4}$); $E\frac{1}{2}$

Section 31: $N\frac{1}{2}SE\frac{1}{4}$; $W\frac{1}{2}NE\frac{1}{4}$; $N\frac{1}{2}SW\frac{1}{4}$; $S\frac{1}{2}S\frac{1}{2}$

Inclusive of the lands embraced by the void Lakes No. 1 Claim, situated in portions of Section 1, Township 37 North, Range 51 East, M.D.B. & M., and Section 36, Township 38 North, Range 51 East, M.D.B. & M.

And the barite in the following described lands located in Elko County, Nevada:

T. 37 N., R. 51 E., M.D.B. & M.

Section 3: $W\frac{1}{2}W\frac{1}{2}$

Section 4: Lot 1, $S\frac{1}{2}$, $SW\frac{1}{4}NW\frac{1}{4}$

T. 38 N., R. 51 E., M.D.B. & M.

Section 34: $W\frac{1}{2}SW\frac{1}{4}$

STATE OF NEVADA
DECLARATION OF VALUE

1. Assessor Parcel Number(s)

- a. N/A _____
- b. _____
- c. _____
- d. _____

2. Type of Property:

- a. Vacant Land
- b. Single Fam. Res.
- c. Condo/Twnhse
- d. 2-4 Plex
- e. Apt. Bldg
- f. Comm'l/Ind'l
- g. Agricultural
- h. Mobile Home
- Other Mineral-Royalty Interest

FOR RECORDERS OPTIONAL USE ONLY	
Book _____	Page: _____
Date of Recording: _____	
Notes: _____	

3.a. Total Value/Sales Price of Property \$ _____

b. Deed in Lieu of Foreclosure Only (value of property (_____))

c. Transfer Tax Value: \$ _____

d. Real Property Transfer Tax Due \$ _____

4. If Exemption Claimed:

a. Transfer Tax Exemption per NRS 375.090, Section 9 _____

b. Explain Reason for Exemption: _____

5. Partial Interest: Percentage being transferred: _____ %

The undersigned declares and acknowledges, under penalty of perjury, pursuant to NRS 375.060 and NRS 375.110, that the information provided is correct to the best of their information and belief, and can be supported by documentation if called upon to substantiate the information provided herein. Furthermore, the parties agree that disallowance of any claimed exemption, or other determination of additional tax due, may result in a penalty of 10% of the tax due plus interest at 1% per month. Pursuant to NRS 375.030, the Buyer and Seller shall be jointly and severally liable for any additional amount owed.

Grantor Signature: [Signature] Capacity: Manager

Grantee Signature: [Signature] Capacity: Manager of the Sole Member

SELLER (GRANTOR) INFORMATION (REQUIRED)

Print Name: Lincoln Minerals L.C.
Address: 7309 E. 21 St. N, Ste. 120
City: Wichita
State: KS Zip: 67206

BUYER (GRANTEE) INFORMATION (REQUIRED)

Print Name: RSN, LLC
Address: 7309 E. 21 St. N, Ste. 120
City: Wichita
State: KS Zip: 67206

COMPANY/PERSON REQUESTING RECORDING (Required if not seller or buyer)

Print Name: _____
Address: _____
City: _____

Escrow # _____
State: _____ Zip: _____

AS A PUBLIC RECORD THIS FORM MAY BE RECORDED/MICROFILMED