

LODE MINING CLAIM MAP

ELP 191-208

SECTIONS 5-8, 17-20, 29-30, T34N, R52E, M.D.M.

EUREKA & ELKO COUNTIES, NEVADA

Locator:

Nevada Gold Mines LLC
1655 Mountain City Highway
Elko, Nevada 89801

Drawn By: ARD

January 2022

Sheet 1 of 1

CLAIM TIES:
The SE corner of ELP 199 is located approximately 5273 feet north and 3945 feet west of the SW corner of Section 16, T34N, R52E, M.D.M.
The NE corner of ELP 200 is located approximately 61 feet north and 3798 feet west of the SW corner of Section 16, T34N, R52E, M.D.M.

CLAIM LOCATION DATE:
December 22, 2021: ELP 191-208

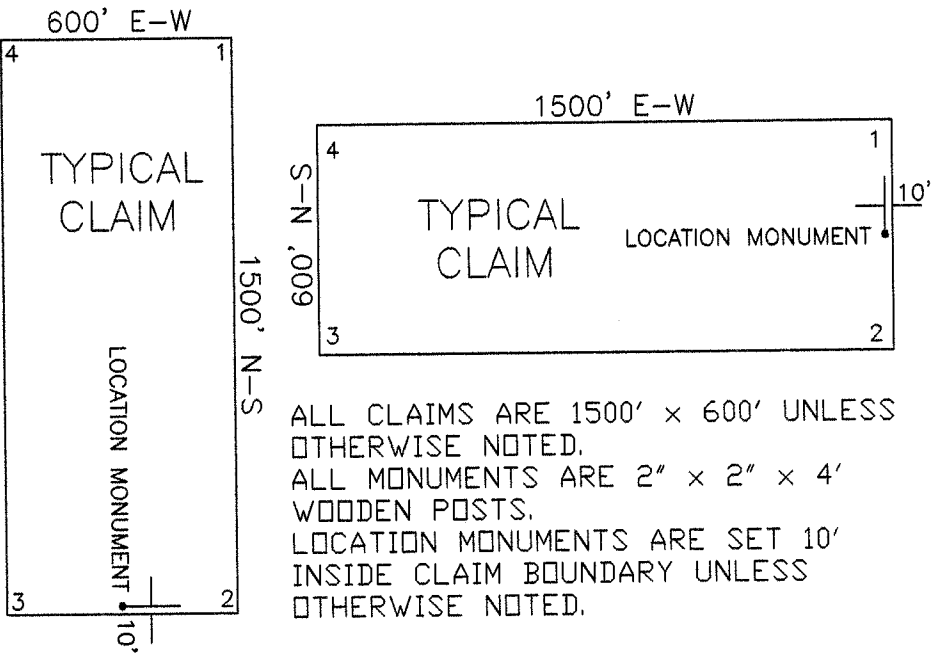

EUREKA COUNTY, NV
MINING-MAP
Fee: \$282.00
Total: \$282.00
NEVADA GOLD MINES LLC

2022-247907

03/16/2022 11:28 AM

Pgs:1



1500' E-W	
200'•	ELP 191
200'•	ELP 192
200'•	ELP 193
200'•	ELP 194
5400' NS	200'• ELP 195
200'•	ELP 196
200'•	ELP 197
200'•	ELP 198
200'•	ELP 199
1500' E-W	

EUREKA COUNTY
ELKO COUNTY

1500' E-W	
100'	ELP 200
100'	ELP 201
100'	ELP 202
100'	ELP 203
5400' NS	100' ELP 204
100'	ELP 205
100'	ELP 206
100'	ELP 207
100'	ELP 208
1500' E-W	

