

1"=300'

EUREKA COUNTY, NV 2022-248078  
 LAND BOOK 05/23/2022 03:22 PM  
 Rec 529.00  
 Total 529.00  
 BURGESS, BURGESS & KIM  
 00015781202202480780010015  
 KATHERINE J. BOWLING, CLERK RECORDER

**SURVEYOR'S CERTIFICATE**

I, ROBERT E. MORLEY, A PROFESSIONAL LAND SURVEYOR LICENSED IN THE STATE OF NEVADA, CERTIFY THAT:  
 1. THIS PLAT REPRESENTS THE RESULTS OF A SURVEY CONDUCTED UNDER MY DIRECT SUPERVISION AT THE INSTANCE OF LORIN BURGESS & CAROLANN BURGESS AND ALISHA KIM.  
 2. THE LANDS SURVEYED LIE WITHIN SECTION 33 T.30 N., R.48 E., M.D.B. & M., AND THE SURVEY WAS COMPLETED ON APRIL 28, 2022.  
 3. THE MONUMENTS DEPICTED ON THE PLAT ARE OF THE CHARACTER SHOWN, AND OCCUPY THE POSITIONS INDICATED AND ARE OF SUFFICIENT NUMBER AND DURABILITY.

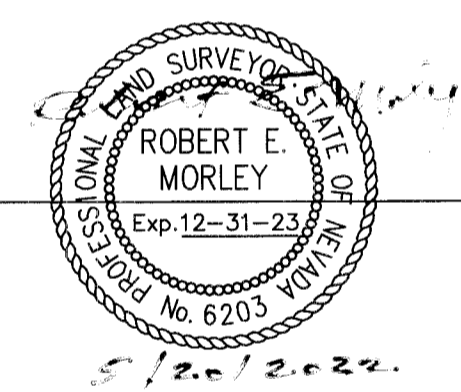

ROBERT E. MORLEY, P.L.S. 6203

**NOTES:**

- 1) THE TOTAL SURVEYED AREA OF THIS MAP EQUALS 46.709 ACRES.
- 2) BASIS OF BEARINGS: THE LINE BETWEEN THE FOUND NORTHWEST CORNER AND NORTH 1/4 CORNER OF SECTION 33, T.30 N., R.48 E., M.D.B. & M., TAKEN AS S 89° 56' 53" E.

**LEGEND**

- ◊ = FOUND SECTION CORNER AS NOTED.
- ◆ = FOUND 1/4 CORNER AS NOTED.
- = SET 5/8" REBAR WITH CAP MARKED PLS 6203.
- = FOUND 5/8" REBAR WITH CAP MARKED PLS 6203.
- = CALCULATED POINT, NOTHING FOUND, NOTHING SET.



SCALE: 1"=300'

**RECORD OF SURVEY**  
 FOR  
**LORIN BURGESS & CAROLANN BURGESS**  
 AND **ALISHA KIM**  
 IN  
 SECTION 33, T.30 N., R.48 E., M.D.B. & M.  
 EUREKA COUNTY, NEVADA

**HIGH DESERT ENGINEERING, LLC** 640 IDAHO STREET ELKO, NEVADA 89801 (775) 738-4053

222029