

T27N, R49E

NW corner of STX 117 is at approximately 4449802N 544752E (UTM NAD83 zone 11 meters)

3000' E-W

3600' N-S

3600' N-S

STX 117

STX 118

STX 119

STX 120

STX 121

STX 122

STX 123

STX 124

STX 125

STX 126

STX 127

STX 128

3000' E-W

32

33

EUREKA COUNTY, NV  
MINING-MAP  
Rec:\$192.00  
Total:\$192.00

2023-249804  
02/14/2023 02:10 PM  
Pgs=1

NEVADA GOLD MINES LLC



00017625202302498040010018  
KATHERINE J. BOWLING, CLERK RECORDER

1500' E-W

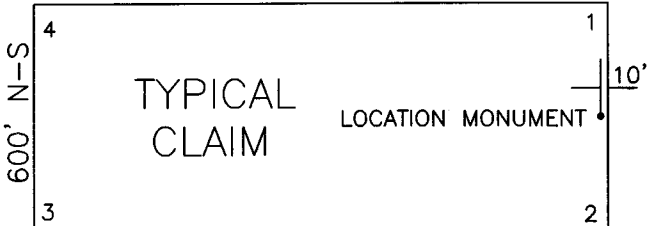

ALL CLAIMS ARE 1500' x 600' UNLESS OTHERWISE NOTED.  
ALL MONUMENTS ARE 2' x 2' x 4' WOODEN POSTS.  
LOCATION MONUMENTS ARE SET 10' INSIDE CLAIM BOUNDARY UNLESS OTHERWISE NOTED.

SCALE: 1inch=500feet  
U.S. Survey Foot  
Sections projected using Nevada BLM GCDB

CLAIM TIE:

The NW corner of STX 117 is located approximately 32,859 feet south and 1,950 feet east of the NW corner of Section 20, T28N, R49E, M.D.M.

CLAIM LOCATION DATE: November 27, 2022: STX 117-128

LODE MINING CLAIM MAP

STX 117-128

SECTIONS 28 & 29, T27N, R49E, M.D.M.  
EUREKA COUNTY, NEVADA

Locator:

Nevada Gold Mines LLC  
1655 Mountain City Highway  
Elko, Nevada 89801