

OWNERS CERTIFICATE

STATE OF NEVADA )  
COUNTY OF EUREKA )SS  
BEING FIRST DULY SWORN THE UNDERSIGNED, HOWARD HILL, SR. AND KATHY M. HILL TRUST AFFIRMS AND SAYS THAT IT IS THE SOLE OWNER OF THE LAND TO BE DIVIDED BY THIS MAP, AND IT CONSENTS TO THIS LAND DIVISION.  
HOWARD HILL, SR. 8-28-23  
KATHY M. HILL 8-28-23  
SUBMITTED AND SWORN TO BEFORE ME, A NOTARY PUBLIC IN AND FOR SAID STATE AND COUNTY THIS 28th DAY OF August, 2023.  
JOYCE J. JEPPESEN  
NOTARY PUBLIC

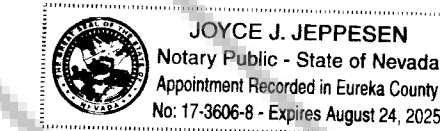

WATER RIGHTS DEDICATION

THIS IS TO CERTIFY THAT ON THE 28th DAY OF August, 2023, THE APPLICANT HAS COMPLIED WITH THE REQUIREMENTS OF EUREKA COUNTY CODE 8.150 REGARDING WATER RIGHTS DEDICATION.  
HOWARD HILL, SR. 8-28-23  
KATHY M. HILL 8-28-23  
APPLICANTS SIGNATURE DATE

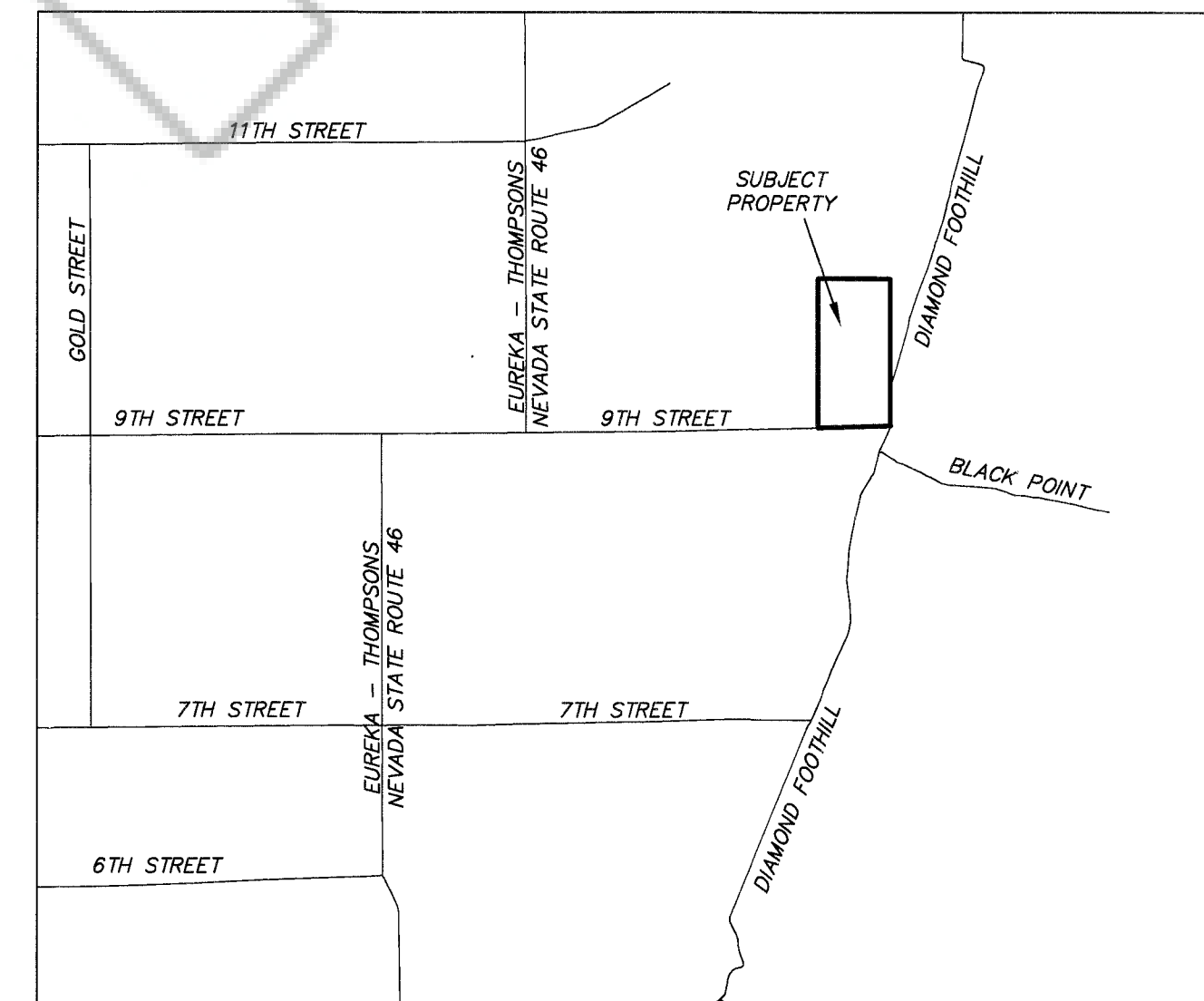

VICINITY MAP  
NOT TO SCALE

RECORDER'S CERTIFICATE

FILE NO. \_\_\_\_\_  
FILED AT THE REQUEST OF  
HIGH DESERT ENGINEERING.  
DATE \_\_\_\_\_, 2023  
TIME \_\_\_\_\_ M.  
EUREKA COUNTY RECORDER

LEGEND

- ◇ = SECTION CORNER AS NOTED.
- ◆ = 1/4 CORNER AS NOTED.
- = FOUND CORNER 1/2 STEEL POST AS NOTED.
- = SET 5/8" REBAR WITH CAP MARKED PLS 6203.

COUNTY COMMISSIONERS APPROVAL

AT A REGULAR MEETING OF THE EUREKA COUNTY COMMISSIONERS HELD ON 2023, THIS MAP, CONSISTING OF ONE SHEET WAS PRESENTED AS A PROPOSED PARCEL MAP LOCATED IN SECTION 16, T.21 N., R.54 E., M.D.B. & M.  
A. JURAT FOR PUBLIC ROADS:  
EUREKA COUNTY HEREBY ACCEPTS THE OFFER OF DEDICATION FOR PUBLIC PURPOSES OF THE STREET, ROAD AND PUBLIC UTILITY RIGHTS-OF-WAY SHOWN ON THIS MAP. STREET AND ROAD RIGHTS OF WAY ARE NOT ACCEPTED BY THE COUNTY FOR MAINTENANCE UNTIL THEY ARE IMPROVED TO COUNTY STANDARDS, APPROVED BY THE EUREKA COUNTY DEPARTMENT OF PUBLIC WORKS AND EXPRESSLY ACCEPTED BY RESOLUTION OF THE BOARD OF EUREKA COUNTY COMMISSIONERS.  
RICK MCKAY 9/5/23  
CHAIRMAN, EUREKA COUNTY COMMISSIONERS DATE  
KATHY BOWLING 9/5/2023  
EUREKA COUNTY CLERK DATE

B. JURAT FOR PRIVATE ROADS:  
EUREKA COUNTY HEREBY ACCEPTS THE OFFER OF DEDICATION FOR PUBLIC PURPOSES OF THE PUBLIC UTILITY RIGHTS OF WAY SHOWN ON THIS MAP. THE COUNTY ACCEPTS NO RESPONSIBILITY AND WILL PROVIDE NO SERVICES UPON THE PRIVATE ROAD(S) DESCRIBED, INCLUDING BUT NOT LIMITED TO SNOW REMOVAL.  
C. ACCEPTANCE OF THIS PARCEL MAP BY EUREKA COUNTY DOES NOT CONSTITUTE A GUARANTEE THAT EACH OR ANY LOT SHOWN THEREON CONTAINS A LAWFUL BUILDING SITE.  
D. FURTHER REPARCELING OF ANY PARCEL CREATED BY THIS MAP MAY BE SUBJECT TO THE PROVISIONS OF NEVADA REVISED STATUTE 278.462(3) AND EUREKA COUNTY CODE, TITLE 8, PERMITTING IMPOSITION OF REASONABLE IMPROVEMENT STANDARDS, BUT NOT MORE THAN WOULD BE REQUIRED IF THE SUBSEQUENT PARCEL WERE A SUBDIVISION.  
E. ALL REQUIREMENTS OF GOVERNMENTAL AGENCIES WITH PERMIT AUTHORITY MUST BE MET.  
F. EUREKA COUNTY EXPRESSLY DECLARES THE PRIOR USE OF ADJACENT OR NEARBY LAND FOR RANCHING, FARMING, AGRICULTURE, MINING, INDUSTRIAL OR COMMERCIAL PURPOSES, AND THE EXPANSION OR MODIFICATION OF SUCH USE SHALL NOT CONSTITUTE A NUISANCE TO AFTER-ESTABLISHED OR SUBSEQUENT IN TIME RESIDENTIAL USES PURSUANT TO NEVADA REVISED STATUTES (N.R.S.) 40.140, N.R.S. 202.450, AND EUREKA COUNTY CODE 8.120.070.

SURVEYOR'S CERTIFICATE

I, ROBERT E. MORLEY, A PROFESSIONAL LAND SURVEYOR LICENSED IN THE STATE OF NEVADA, CERTIFY THAT:  
1. THIS PLAT REPRESENTS THE RESULTS OF A SURVEY CONDUCTED UNDER MY DIRECT SUPERVISION AT THE INSTANCE OF HOWARD HILL, SR. AND KATHY M. HILL.  
2. THE LANDS SURVEYED LIE WITHIN SECTION 16, T.21 N., R.54 E., M.D.B. & M., AND THE SURVEY WAS COMPLETED ON JUNE 2, 2023.  
3. THIS PLAT COMPLIES WITH THE APPLICABLE STATE STATUTES AND ANY LOCAL ORDINANCES IN EFFECT ON THE DATE THAT THE GOVERNING BODY GAVE ITS FINAL APPROVAL.  
4. THE MONUMENTS DEPICTED ON THE PLAT ARE OF THE CHARACTER SHOWN, OCCUPY THE POSITIONS INDICATED AND ARE OF SUFFICIENT NUMBER AND DURABILITY.

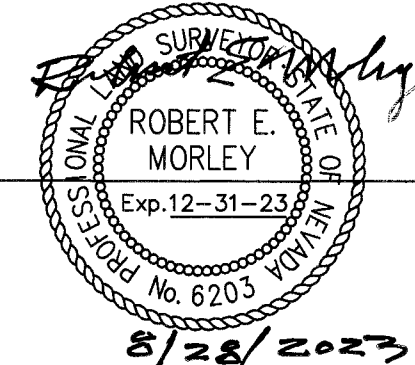

ROBERT E. MORLEY, P.L.S. 6203

EUREKA COUNTY PLANNING COMMISSION APPROVAL

AT A REGULAR MEETING OF THE EUREKA COUNTY PLANNING COMMISSION, EUREKA COUNTY, STATE OF NEVADA, HELD ON THE 28th DAY OF August, 2023, THIS MAP WAS APPROVED:  
Russell Conley  
CHAIRPERSON DATE

COUNTY TREASURER'S CERTIFICATE

THIS IS TO CERTIFY THAT PARCEL NO. 007-250-28 HAS NO DELINQUENCIES AND THAT TAXES ARE PAID THROUGH August 29, 2023.  
Bernice Johnson 8/29/23  
EUREKA COUNTY TREASURER DATE

FLOOD NOTE:

THE PARCELS SHOWN ON THIS MAP DO NOT LIE IN A FLOOD PLAIN PER FLOOD INSURANCE RATE MAP 32011C16250, EFFECTIVE MAY 16, 2012.



SCALE: 1"=300'

PARCEL MAP

FOR  
HOWARD HILL, SR AND KATHY M. HILL  
IN  
SECTION 16, T.21 N., R.54 E., M.D.B. & M.  
EUREKA COUNTY, NEVADA

HIGH DESERT  
ENGINEERING,  
LLC  
640 IDAHO STREET  
ELKO, NEVADA 89801  
(775) 738-4053

223036