

SURVEYOR'S CERTIFICATE

1. ROBERT THIBAUT, A PROFESSIONAL LAND SURVEYOR LICENSED IN THE STATE OF NEVADA, CERTIFY THAT:
1. THIS PLAT REPRESENTS THE RESULTS OF A SURVEY CONDUCTED UNDER MY DIRECT SUPERVISION AT THE INSTANCE OF PETER LOCASCIO JR. AND THRUDIE LOCASCIO.
2. THE LANDS SURVEYED LIE WITHIN SECTION 11 T.30 N., R.48 E., M.D.B. & M., AND THE SURVEY WAS COMPLETED ON JUNE 12, 2024.
3. THE MONUMENTS DEPICTED ON THE PLAT ARE OF THE CHARACTER SHOWN, AND OCCUPY THE POSITIONS INDICATED AND ARE OF SUFFICIENT NUMBER AND DURABILITY.

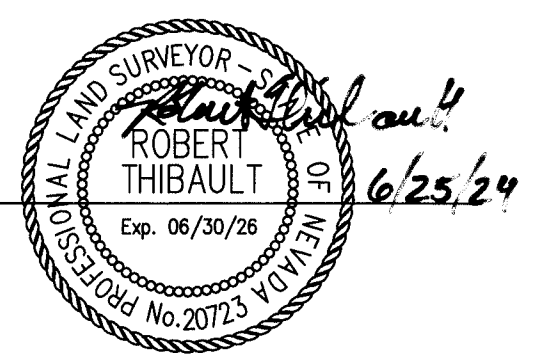

ROBERT THIBAUT, P.E., P.L.S. 20723

NOTES:

1. THE TOTAL SURVEYED AREA OF THIS MAP EQUALS 20.039 ACRES.
2. BASIS OF BEARINGS: THE FOUND PROPERTY CORNERS SHOWN HEREON AND AS SHOWN ON THE RECORD OF SURVEY FOR JUDITH LYNN ON FILE IN THE OFFICE OF THE EUREKA COUNTY RECORDER, EUREKA, NEVADA, AS FILE NO. 205915.

LEGEND

- ◊ = FOUND SECTION CORNER AS NOTED.
- ◆ = FOUND 1/4 CORNER AS NOTED.
- = SET 5/8" REBAR WITH CAP MARKED PLS 20723.
- = FOUND 5/8" REBAR WITH CAP MARKED PLS 8341 UNLESS OTHERWISE NOTED.
- = CALCULATED POINT NOTHING FOUND, NOTHING SET.

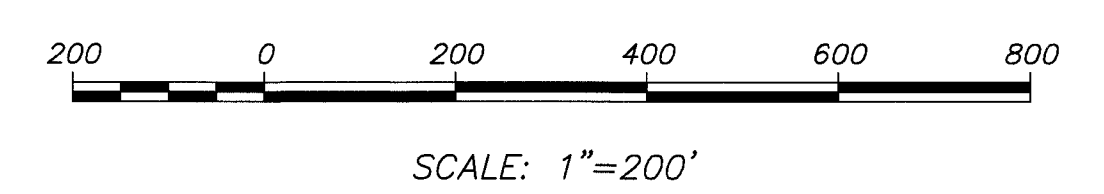

EUREKA COUNTY, NV
 LAND-ROS
 Rec: \$29.00
 Total: \$29.00
 HIGH DESERT ENGINEERING

2024-252681
 07/01/2024 02:28 PM
 Pgs=1

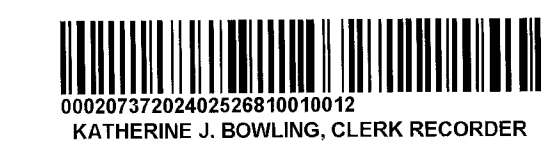

00020737202402526810010012
 KATHERINE J. BOWLING, CLERK RECORDER

FILING DATA

FILE NO. _____
 FILED AT THE REQUEST OF
 HIGH DESERT ENGINEERING.
 DATE _____, 2024
 TIME _____ .M.
 D. MIKE SMALES
 ELKO COUNTY RECORDER

RECORD OF SURVEY
 FOR
PETER LOCASCIO JR. AND THRUDIE LOCASCIO
 IN
SECTION 11, T.30 N., R.48 E., M.D.B. & M.
EUREKA COUNTY, NEVADA

HIGH DESERT ENGINEERING

640 IDAHO STREET
 ELKO, NEVADA 89601
 (775) 738-4053

224049