

SURVEYOR'S CERTIFICATE

I, ROBERT THIBAUT, A PROFESSIONAL LAND SURVEYOR LICENSED IN THE STATE OF NEVADA, CERTIFY THAT:

- THIS PLAT REPRESENTS THE RESULTS OF A SURVEY CONDUCTED UNDER MY DIRECT SUPERVISION AT THE INSTANCE OF JENNIFER LUEDER.
- THE LANDS SURVEYED LIE WITHIN SECTION 29 T.29 N., R.48 E., M.D.B. & M., AND THE SURVEY WAS COMPLETED ON JUNE 17, 2024.
- THE MONUMENTS DEPICTED ON THE PLAT ARE OF THE CHARACTER SHOWN, AND OCCUPY THE POSITIONS INDICATED AND ARE OF SUFFICIENT NUMBER AND DURABILITY.

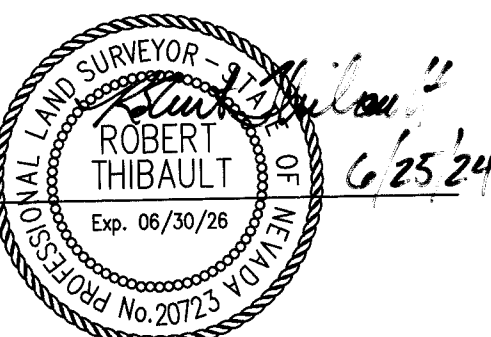

ROBERT THIBAUT, P.E., P.L.S. 20723

NOTES:

- THE TOTAL SURVEYED AREA OF THIS MAP EQUALS 20.269 ACRES.
- BASIS OF BEARINGS: THE LINE BETWEEN THE FOUND NORTHWEST CORNER AND WEST 1/4 CORNER OF SECTION 29, T.29 N., R.48 E., M.D.B. & M., TAKEN AS S 00° 04' 32" E.

LEGEND

- ◇ = FOUND SECTION CORNER AS NOTED.
- ◆ = FOUND 1/4 CORNER AS NOTED.
- = SET 5/8" REBAR WITH CAP MARKED PLS 20723.
- = CALCULATED POINT, NOTHING FOUND, NOTHING SET.
- (R) = RECORD DISTANCE.
- (M) = MEASURED DISTANCE.

REFERENCE DOCUMENTS

- THE B.L.M. CADASTRAL SURVEY PLAT FILED IN THE OFFICE OF THE STATE OF NEVADA ON JULY 31, 1980.
- THE RECORD OF SURVEY FOR CLYDE SCHELL, ON FILE IN THE OFFICE OF EUREKA COUNTY RECORDER, EUREKA, NEVADA, AS FILE NO. 178497.
- THE RECORD OF SURVEY FOR CRESCENT VALLEY RANCH & FARMS, INC., ON FILE IN THE OFFICE OF THE EUREKA COUNTY RECORDER, EUREKA, NEVADA, AS FILE NO. 34550.

EUREKA COUNTY, NV
LAND-RCS
Rec: \$25.00
Total: \$29.00
HIGH DESERT ENGINEERING

2024-252683
07/01/2024 02:29 PM
Pg#1

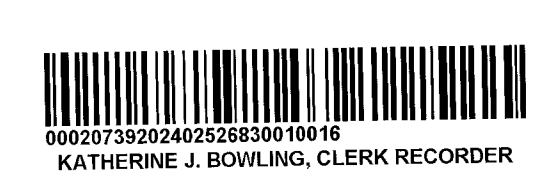

FOUND 1978 BLM BRASS CAP

29 28 S 89°57'21" E 5296.80' (M)
32 33 S 89°57'21" E 5296.12' (R)

CORNER ESTABLISHED PER RECORD OF SURVEY FOR CLYDE SCHELL
FILE NO. 178497
NOTHING FOUND, NOTHING SET

FOUND 1978 BLM BRASS CAP

32 33 S 89°57'21" E 5296.80' (M)
32 33 S 89°57'21" E 5296.12' (R)

FILING DATA

FILE NO. _____

FILED AT THE REQUEST OF HIGH DESERT ENGINEERING.

DATE _____, 2024

TIME _____ M.

EUREKA COUNTY RECORDER

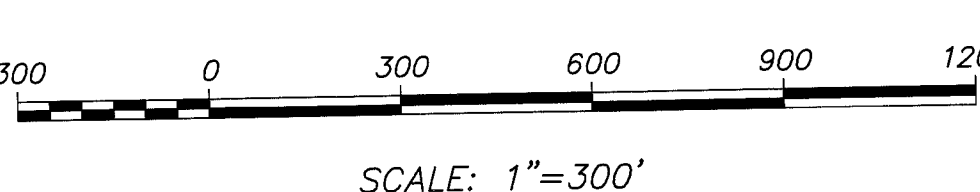

RECORD OF SURVEY

FOR
JENNIFER LUEDER

IN
**SECTION 29, T.29 N., R.48 E., M.D.B. & M.
EUREKA COUNTY, NEVADA**

	HIGH DESERT ENGINEERING	640 IDAHO STREET ELKO, NEVADA 89801 (775) 738-4053	224052