

**SURVEYOR'S CERTIFICATE**

I, ROBERT THIBAUT, A PROFESSIONAL LAND SURVEYOR LICENSED IN THE STATE OF NEVADA, CERTIFY THAT:

- THIS PLAT REPRESENTS THE RESULTS OF A SURVEY CONDUCTED UNDER MY DIRECT SUPERVISION AT THE INSTANCE OF JOHN MILNER.
- THE LANDS SURVEYED LIE WITHIN SECTION 5 T.30 N., R.50 E., M.D.B. & M., AND THE SURVEY WAS COMPLETED ON DECEMBER 12, 2024.
- THE MONUMENTS DEPICTED ON THE PLAT ARE OF THE CHARACTER SHOWN, AND OCCUPY THE POSITIONS INDICATED AND ARE OF SUFFICIENT NUMBER AND DURABILITY.

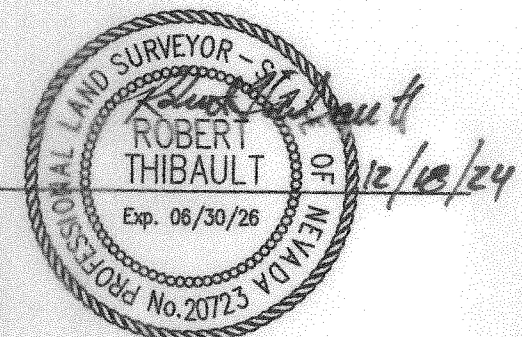

ROBERT THIBAUT, P.E., P.L.S. 20723

**NOTES:**

- THE TOTAL SURVEYED AREA OF THIS MAP EQUALS 40.254 ACRES.
- BASIS OF BEARINGS: THE LINE BETWEEN THE FOUND SOUTHWEST CORNER AND SOUTHEAST CORNER OF SECTION 5, T.30 N., R.50 E., M.D.B. & M., AS SHOWN HEREON, TAKEN AS S 46°47' E.

**LEGEND**

- ◊ = SECTION CORNER AS NOTED.
- ◆ = 1/4 CORNER AS NOTED
- △ = 1914 GLO BRASS CAP ANGLE POINT AS NOTED.
- = FOUND 5/8" REBAR WITH CAP MARKED PLS 20723 AS SHOWN ON RECORD OF SURVEY, FILE NO. 2024-253201.
- = SET 5/8" REBAR WITH CAP MARKED PLS 20723.
- = CALCULATED POINT, NOTHING FOUND, NOTHING SET.



SCALE: 1"=300'

EUREKA COUNTY, NV  
 LAND RECORDS  
 2024-254109  
 12/27/2024 01:03 PM  
 Total \$29.00 Pgs=1  
 JOHN MILNER  
 KATHERINE J. BOWLING, CLERK RECORDER

**RECORD OF SURVEY**  
 FOR  
**JOHN MILNER**  
 IN  
 SECTION 5, T.30 N., R.50 E., M.D.B. & M.  
 EUREKA COUNTY, NEVADA

**224131**

HIGH DESERT ENGINEERING 640 IDAHO STREET ELKO, NEVADA 89801 (775) 738-4053