

SURVEYOR'S CERTIFICATE

1. ROBERT THIBAUT, A PROFESSIONAL LAND SURVEYOR LICENSED IN THE STATE OF NEVADA, CERTIFY THAT:
1. THIS PLAT REPRESENTS THE RESULTS OF A SURVEY CONDUCTED UNDER MY DIRECT SUPERVISION AT THE INSTANCE OF THE TRAVIS MCFATE REVOCABLE LIVING TRUST.
2. THE LANDS SURVEYED LIE WITHIN SECTION 17, T.30 N., R.49 E., M.D.B. & M., AND THE SURVEY WAS COMPLETED ON JANUARY 15, 2025.
3. THE MONUMENTS DEPICTED ON THE PLAT ARE OF THE CHARACTER SHOWN, AND OCCUPY THE POSITIONS INDICATED AND ARE OF SUFFICIENT NUMBER AND DURABILITY.

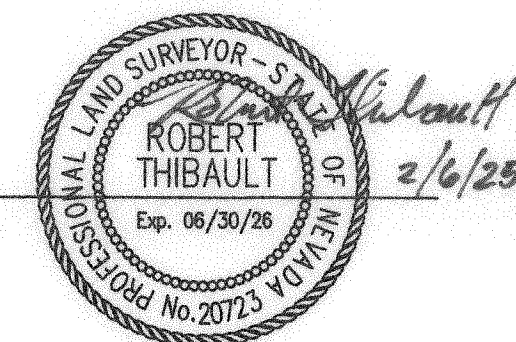

ROBERT THIBAUT, P.E., P.L.S. 20723

NOTES:

1. THE TOTAL SURVEYED AREA OF THIS MAP EQUALS 80.555 ACRES.
2. BASIS OF BEARINGS: THE LINE BETWEEN THE FOUND NORTHWEST CORNER AND WEST 1/4 CORNER OF SECTION 17, T.30 N., R.49 E., M.D.B. & M., TAKEN AS S 00°24'49\"/>

LEGEND

- ◆ = SECTION CORNER AS NOTED.
- ◆ = 1/4 CORNER AS NOTED
- = SET 5/8\"/>
- = CALCULATED POINT, NOTHING FOUND, NOTHING SET.

REFERENCE DOCUMENTS

1. THE MAP OF DIVISION INTO LARGE PARCELS FOR NEW NEVADA LANDS, LLC, ON IN THE OFFICE OF THE EUREKA COUNTY RECORDER, ELKO, NEVADA, AS FILE NO. 2023-251341.



SCALE: 1"=300'

EUREKA COUNTY, NV
LAND-RS
Rec: \$29.00
Total: \$29.00
HIGH DESERT ENGINEERING

2025-254193
02/12/2025 11:36 AM
Pg#1



00022361202502541930010014
KATHERINE J. BOWLING, CLERK RECORDER

RECORD OF SURVEY
FOR
THE TRAVIS MCFATE
REVOCABLE LIVING TRUST
IN
SECTION 17, T.30 N., R.49 E., M.D.B. & M.
EUREKA COUNTY, NEVADA

HIGH DESERT ENGINEERING 640 IDAHO STREET
ELKO, NEVADA 89801
(775) 738-4053

225002