

APN: 005-270-18

RECORDING REQUESTED BY:

Land of Land, Inc.

PO Box 66

Swedesboro, NJ 08085

MAIL TAX STATEMENTS AND DEED TO:

D&K Carpenter Properties, LLC

1479 Pine Top Rd

London, KY 40741

EUREKA COUNTY, NV

2025-254196

RPTT:\$325.65 Rec:\$37.00

\$362.65 Pgs=2

02/13/2025 09:14 AM

LAND OF LAND, INC.

KATHERINE J. BOWLING, CLERK RECORDER

FOR RECORDER'S USE ONLY

REAL ESTATE DEED

THIS INDENTURE WITNESSETH: That **Land of Land, Inc.**, whose address is **1479 Pine Top Rd, London, KY 40741**, for \$83,155.00 receipt of which is hereby acknowledged, do/does hereby convey to: **D&K Carpenter Properties, LLC**, whose address is **1479 Pine Top Rd, London, KY 40741** all that real property situated in the County of Eureka, State of Nevada, described as follows:

Parcel Number & Legal Description:

"Exhibit A"

SUBJECT TO: Any Existing taxes, assessments, liens, encumbrances, easements of record, rights of way, covenants, conditions, mineral deed reservations, and restrictions. Together with all and singular the tenements, hereditaments and appurtenances thereunto, belonging or in anywise appertaining, and any reversions, remainders, rents, issues or profits thereof. Property sold "AS IS."

Land of Land, Inc.

[Signature]
Jacqueline Palumbo, Manager of Land of Land, Inc.

2/7/25
Date

STATE OF New Jersey

COUNTY OF Gloucester

)
SS

This instrument was acknowledged before me on February 7, 2025, by Jacqueline Palumbo.

[Signature]
Notary Public

GIANNA B MCMASTER
NOTARY PUBLIC
STATE OF NEW JERSEY
ID # 50194024
MY COMMISSION EXPIRES MAY 09, 2027

Exhibit A

The land referred to herein is described as follows:

All that certain real property situate in the County of Eureka, State of Nevada, described as follows:

TOWNSHIP 30 NORTH, RANGE 48 EAST, MDB&M
SECTION 35: NE4 SEC. 35 T30N, R48E

PARCEL NUMBER - 005-270-18

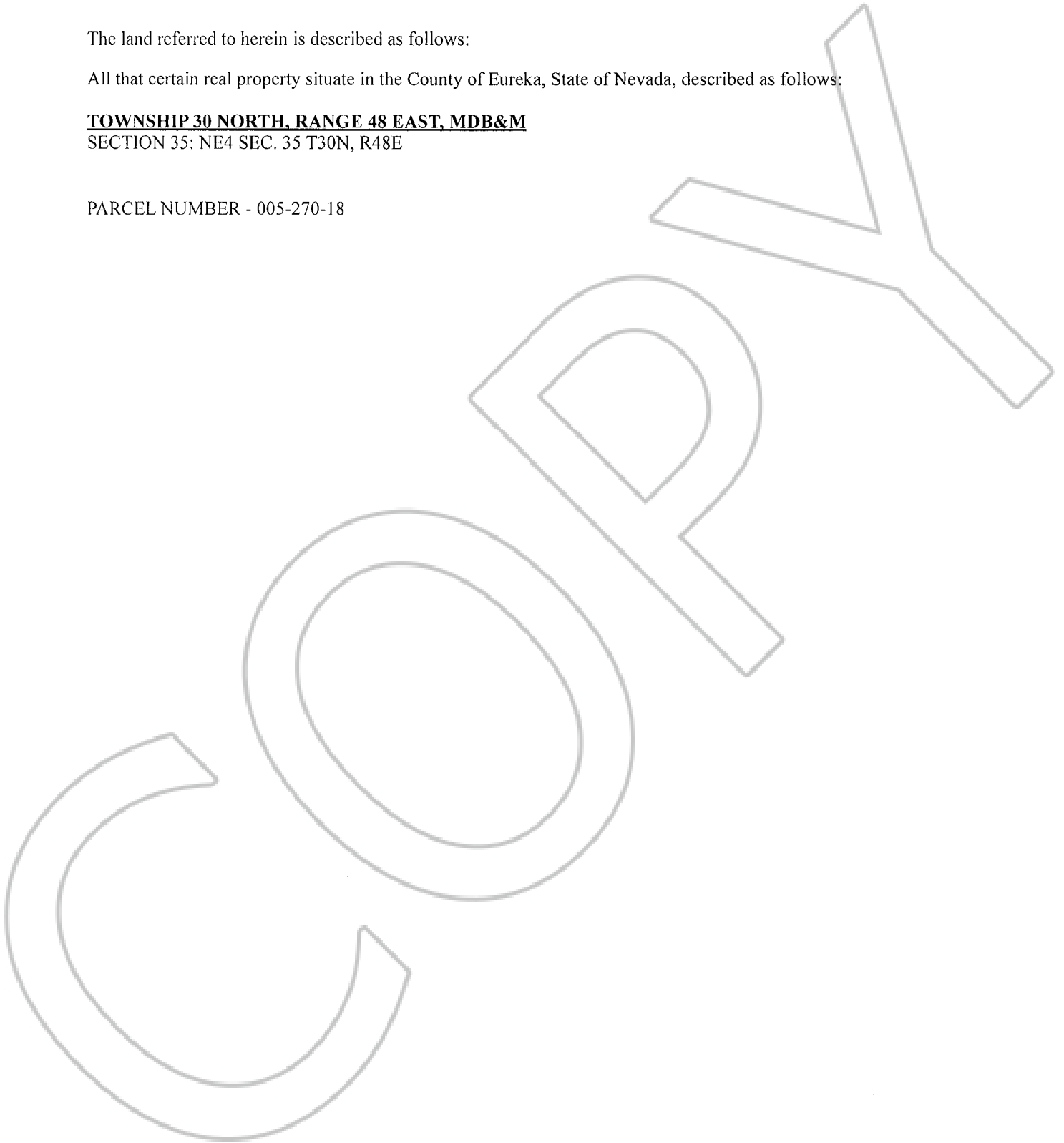

STATE OF NEVADA
DECLARATION OF VALUE

1. Assessor Parcel Number(s)

- a. 005-270-18
b. _____
c. _____
d. _____

2. Type of Property:

- a. ☒ Vacant Land b. ☐ Single Fam. Res.
c. ☐ Condo/Twnhse d. ☐ 2-4 Plex
e. ☐ Apt. Bldg f. ☐ Comm'l/Ind'l
g. ☐ Agricultural h. ☐ Mobile Home
☐ Other

FOR RECORDERS OPTIONAL USE ONLY

Book _____ Page: _____

Date of Recording: _____

Notes: _____

3.a. Total Value/Sales Price of Property

\$ 83,155.00

b. Deed in Lieu of Foreclosure Only (value of property (_____)

c. Transfer Tax Value: \$ _____

d. Real Property Transfer Tax Due \$ 325.65

4. **If Exemption Claimed:**

a. Transfer Tax Exemption per NRS 375.090, Section _____

b. Explain Reason for Exemption: _____

5. Partial Interest: Percentage being transferred: _____ %

The undersigned declares and acknowledges, under penalty of perjury, pursuant to NRS 375.060 and NRS 375.110, that the information provided is correct to the best of their information and belief, and can be supported by documentation if called upon to substantiate the information provided herein. Furthermore, the parties agree that disallowance of any claimed exemption, or other determination of additional tax due, may result in a penalty of 10% of the tax due plus interest at 1% per month. Pursuant to NRS 375.030, the Buyer and Seller shall be jointly and severally liable for any additional amount owed.

Signature [Signature] Capacity: SELLER

Signature [Signature] Capacity: BUYER Agent

SELLER (GRANTOR) INFORMATION

(REQUIRED)

Print Name: Land of Land, Inc.

Address: PO Box 66

City: Swedesboro

State: New Jersey Zip: 08085

BUYER (GRANTEE) INFORMATION

(REQUIRED)

Print Name: D&K Carpenter Properties, LLC

Address: 1479 Pine Top Rd

City: London

State: Kentucky Zip: 40741

COMPANY/PERSON REQUESTING RECORDING (Required if not seller or buyer)

Print Name: _____

Escrow # _____

Address: _____

City: _____

State: _____ Zip: _____

AS A PUBLIC RECORD THIS FORM MAY BE RECORDED/MICROFILMED