

APN: 005-270-18

RECORDING REQUESTED BY:
Land of Land, Inc.
PO Box 66
Swedesboro, NJ 08085

MAIL TAX STATEMENTS AND DEED TO:
D&K Carpenter Properties, LLC
1479 Pine Top Rd
London, KY 40741

EUREKA COUNTY, NV
RPTT:\$0.00 Rec:\$37.00
\$37.00 Pgs=2
LAND OF LAND, INC.

2025-254303

03/14/2025 08:24 AM

KATHERINE J. BOWLING, CLERK RECORDER E01

FOR RECORDER'S USE ONLY

CORRECTIVE REAL ESTATE DEED

THIS INDENTURE WITNESSETH: That **Land of Land, Inc.**, whose address is **1479 Pine Top Rd, London, KY 40741**, for \$83,155.00 receipt of which is hereby acknowledged, do/does hereby convey to: **D&K Carpenter Properties, LLC**, whose address is **1479 Pine Top Rd, London, KY 40741** all that real property situated in the County of Eureka, State of Nevada, described as follows:

Parcel Number & Legal Description:

"Exhibit A"

SUBJECT TO: Any Existing taxes, assessments, liens, encumbrances, easements of record, rights of way, covenants, conditions, mineral deed reservations, and restrictions. Together with all and singular the tenements, hereditaments and appurtenances thereto, belonging or in anywise appertaining, and any reversions, remainders, rents, issues or profits thereof. Property sold "AS IS."

Land of Land, Inc.

[Signature]
BY: *Jacqueline Palumbo*
Jacqueline Palumbo, Manager of Land of Land, Inc.
MAN DO W

3/5/25
Date

STATE OF New Jersey)
COUNTY OF Gloucester) SS

This instrument was acknowledged before me on March 5, 2025, by Jacqueline Palumbo

[Signature]
Notary Public

GIANNA B MCMASTER
NOTARY PUBLIC
STATE OF NEW JERSEY
ID # 50194024
MY COMMISSION EXPIRES MAY 09, 2027

Exhibit A

The land referred to herein is described as follows:

All that certain real property situate in the County of Eureka, State of Nevada, described as follows:

TOWNSHIP 30 NORTH, RANGE 48 EAST, MDB&M
SECTION 35: NW4 SEC. 35 T30N, R48E

PARCEL NUMBER - 005-270-18

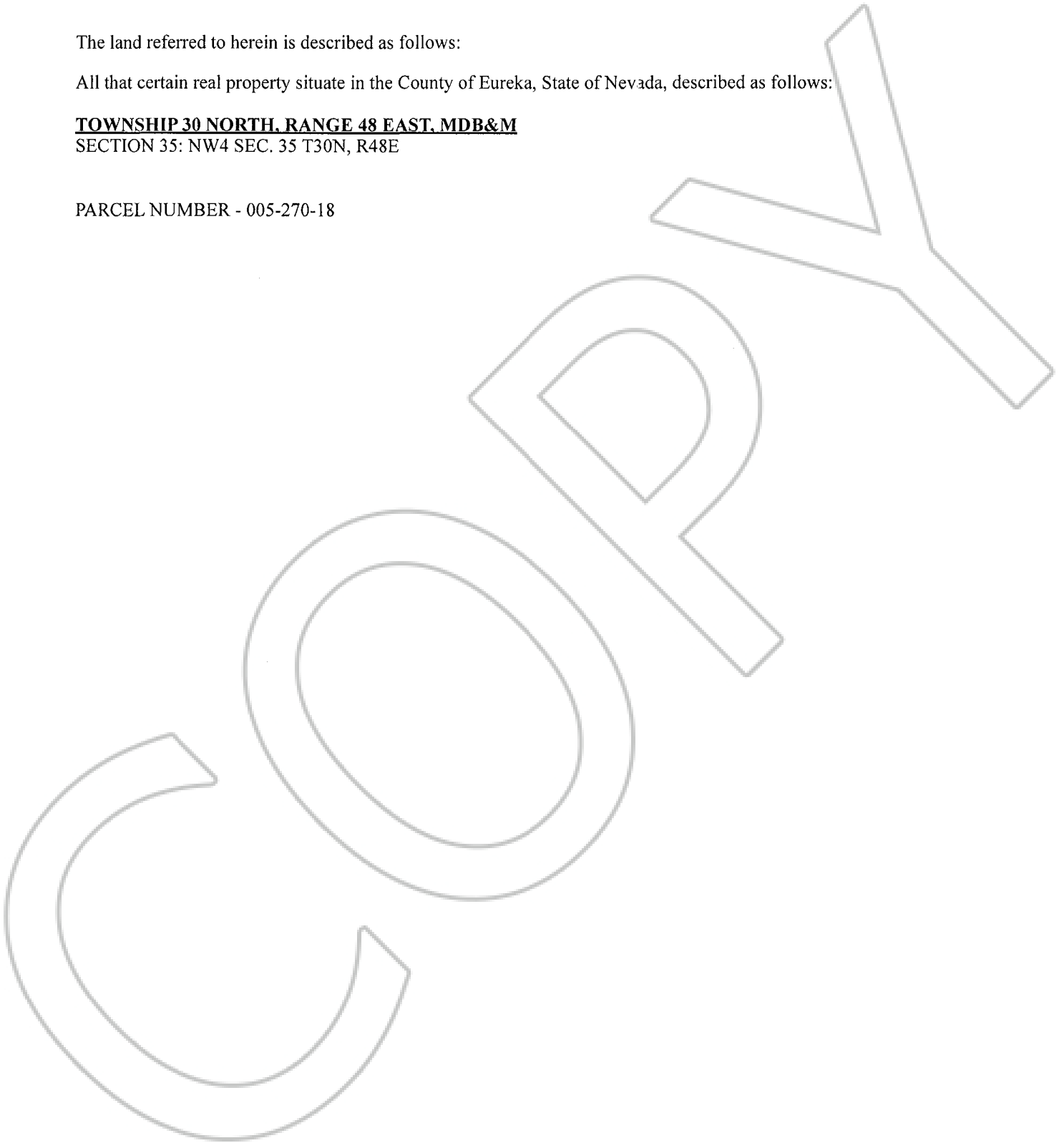

STATE OF NEVADA DECLARATION OF VALUE

1. Assessor Parcel Number (s)

- a) 005-270-18
b) _____
c) _____
d) _____

FOR RECORDERS OPTIONAL USE ONLY

Document/Instrument#:	_____
Book:	_____ Page: _____
Date of Recording:	_____
Notes:	_____

2. Type of Property:

- | | | | |
|--|--------------|-----------------------------|-----------------|
| a) <input checked="" type="checkbox"/> | Vacant Land | b) <input type="checkbox"/> | Single Fam Res. |
| c) <input type="checkbox"/> | Condo/Twnhse | d) <input type="checkbox"/> | 2-4 Plex |
| e) <input type="checkbox"/> | Apt. Bldg. | f) <input type="checkbox"/> | Comm'l/Ind'l |
| g) <input type="checkbox"/> | Agricultural | h) <input type="checkbox"/> | Mobile Home |
| i) <input type="checkbox"/> | Other | | |

3. Total Value/Sales Price of Property:

Deed in Lieu of Foreclosure Only (value of property) \$ _____
Transfer Tax Value: \$ _____
Real Property Transfer Tax Due: \$ _____

4. If Exemption Claimed:

- a. Transfer Tax Exemption, per NRS 375.090, Section: NRS 375.090(1)(i)
b. Explain Reason for Exemption: Corrective Deed

5. Partial Interest: Percentage being transferred: _____ %

The undersigned declares and acknowledges, under penalty of perjury, pursuant to NRS 375.060 and NRS 375.110, that the information provided is correct to the best of their information and belief, and can be supported by documentation if called upon to substantiate the information provided herein. Furthermore, the disallowance of any claimed exemption, or other determination of additional tax due, may result in a penalty of 10% of the tax due plus interest at 1% per month.

Pursuant to NRS 375.030, the Buyer and Seller shall be jointly and severally liable for any additional amount owed.

Signature [Signature] Capacity Buyer Agent

Signature [Signature] Capacity Seller

SELLER (GRANTOR) INFORMATION

(REQUIRED)

Print Name: Land of Land, Inc
Address: PO Box 66
City: Swedesboro
State: NJ Zip: 08085

BUYER (GRANTEE) INFORMATION

(REQUIRED)

Print Name: D&K Carpenter Properties, LLC
Address: 1479 Pine Top Rd
City: London
State: NV Zip: 40741

COMPANY/PERSON REQUESTING RECORDING

(REQUIRED IF NOT THE SELLER OR BUYER)

Print Name: _____ Escrow # _____
Address: _____
City: _____ State: _____ Zip: _____

(AS A PUBLIC RECORD THIS FORM MAY BE RECORDED)