



00023046202502548060060066

**KATHERINE J. BOWLING, CLERK RECORDER**

**TO ALL WHOM IT MAY CONCERN:**

Name and mailing address of locator:  
John and Tom Wear And Robert Reaksecker (Partnership)  
HCB6, Box 4-11 715 Pleasant Hill Dr.  
Beowawe, NV 89821 Battle Mtn, NV 89820

**RECORDER'S STAMP**

located the Black Dog #1-4 Lode Mining Claim in the following quarter section(s):

<u>1/4</u>	<u>Section</u>	<u>Township</u>	<u>Range</u>	<u>Meridian</u>
NWSE	12	32 N	48 E	MDB&M
NWSE	12	32 N	48 E	MDB&M
NWSE	12	32 N	48 E	MDB&M
NWSE	12	32 N	48 E	MDB&M

in Eureka County, Nevada, on the 24<sup>th</sup> day of May, 2025

The Claim is approximately 1500 feet long and 600 feet wide, such that 1500 feet are claimed in a NORTH direction and 300 feet in a EAST WEST direction from the point of discovery (monument of location), at which the Notice of Location was posted, together with 300 feet on each side of the monument of location and center line of the Claim. The general course of the lode or vein is from the NORTH to the SOUTH direction.

The number, location and markings on each corner monument are as follows:

No.	Location	Markings	Description
No. 1:	SEL 12, 32N 48E	NW, NE, SE, SW COR	BLACK DOG 1 TB 4
No. 2:			
No. 3:			
No. 4:			

As erected on the ground each corner monument is marked by METAL TAGS & FLAGGING  
(metal tags, paint, etc.)

The undersigned certifies that work of location included making a claim map as provided in NRS 517.040.

Dated this 24 day of MAY, 20 25.

By [Signature]  
Locator or Agent Signature  
(circle one)

John Wear  
Locator or Agent Name (printed)

John and Tom Wear (775) 340-7497  
HC66, Box 4-11  
Beowawe, NV 89821

BLACK DOG CLAIMS ARE LOCATED  
IN THE MOUNT DIAULO MERICAN STATE OF  
NEVADA, TOWNSHIP 32N, RANGE 48E  
SECTION 12 NWSE. LOCATION MONUMENTS  
HAVE BEEN PLACED ON THE CENTER  
LINE OF EACH OF THE 4 CLAIMS.

NO SURFACE DISTURBANCE HAS BEEN  
CAUSED AT THIS TIME. PREVIOUS  
DISTURBANCE IS EVIDENCE ON CLAIM  
NUMBER ONE AND CONSISTS OF APPROX-  
IMATELY 150' OF EXPLORATION ROAD  
AND A EXPLORATION TRENCH RUNNING  
NORTH, SOUTH, OF A DEPTH OF 12 TO 14  
FEET, 60 FEET LONG AND 30 FEET WIDE.  
I WOULD ESTAMATE THIS DISTURBANCE  
TO BE OVER 20 YEARS OLD.

THE CAUSE FOR OUR INTEREST IN THESE  
CLAIMS IS STRONG EVIDANCE OF  
BARIUM SULFATE,  $\text{BaSO}_4$  AND ANY  
OTHER MINERALS.

RESPECTFULLY YOURS

JOHN & TOM WEAR  
ROBERT REARSECKER.

P.S. ~~ASSE~~

DIRECTION TO THE BLACK DOG CLAIMS  
IS BEST EXPLAINED WITH THE ENCLOSED  
MAP.

GPS: 40° 39' 29N 116° 30' 31W

mt. diablo meridian district

Black dog #1

**NOTICE OF LOCATION - LODE CLAIM**

Notice is hereby given that the undersigned locates and claims the following described piece of mineral bearing ground as the

BLACK DOG #1 lode mining claim. From this discovery (location) monument 1500 feet in a NORTH direction, and 600 feet in a EAST, WEST direction, together with 300 feet on either side of the middle of the claim.

The claim is situated in SEC 12 mining district, MT DIABLO MER. NV County, Nevada. The general course of the vein is NORTH SOUTH and EAST WEST. The size of the claim is 1500 feet long by 600 feet wide.

Located this 12 day of MAY 2025.

By: DEAN & TOM WEAR AND BOB BEARSELKER

Address: HG 66 Box 4-11 19821 BEDWAE NV AND 215 PLEASANT HILL DRIVE BATTLE MOUNTAIN NV

Witness: [Signature]

Black dog #2

**NOTICE OF LOCATION - LODE CLAIM**

Notice is hereby given that the undersigned locates and claims the following described piece of mineral bearing ground as the

BLACK DOG #2 lode mining claim. From this discovery (location) monument 1500 feet in a NORTH direction, and 600 feet in a EAST WEST direction, together with 300 feet on either side of the middle of the claim.

The claim is situated in MT DIABLO mining district, VERN IN FURK County, Nevada. The general course of the vein is NORTH SOUTH and EAST WEST. The size of the claim is 1500 feet long by 600 feet wide.

Located this 12 day of MAY 2025.

By: DEAN & TOM WEAR AND BOB BEARSELKER

Address: HG 66 Box 4-11 19821 BEDWAE NV AND 215 PLEASANT HILL DRIVE BATTLE MOUNTAIN NV

Witness: [Signature]



Carlin Trend Mining Services  
369 5th Street  
Elko, Nevada 89801-3705  
Phone: (775) 778-0668



Carlin Trend Mining Services  
369 5th Street  
Elko, Nevada 89801-3705  
Phone: (775) 778-0668

GPS: 40° 39' 29N 116° 30' 31W  
mt. diablo meridian district

Black dog #3

**NOTICE OF LOCATION - LODE CLAIM**

Notice is hereby given that the undersigned locates and claims the following described piece of mineral bearing ground as the

BLACK DOG #3 lode mining claim. From this discovery (location) monument 1500 feet in a NORTH direction, and 600 feet in a EAST WEST direction, together with 300 feet on either side of the middle of the claim. The claim is situated in ELUREKA CO mining district, SEC 12 MT DIABLO County, Nevada. The general course of the vein is NORTH SOUTH and EAST WEST. The size of the claim is 1500 feet long by 600 feet wide.

Located this 12 day of MAY, 2025.

By: JOHN & TOM WEAR AND

BOB BEARSECKED

Address: H566 Box 4-11 19821

BEAUREND RD

215 PLEASANT HILL

BATTLE MOUNT NV

Witness: John Wear

Blackdog #4

**NOTICE OF LOCATION - LODE CLAIM**

Notice is hereby given that the undersigned locates and claims the following described piece of mineral bearing ground as the

BLACK DOG #4 lode mining claim. From this discovery (location) monument 1500 feet in a NORTH direction, and 600 feet in a EAST WEST direction, together with 300 feet on either side of the middle of the claim.

The claim is situated in MT DIABLO MND mining district, SEC 12 ELUREKA County, Nevada. The general course of the vein is NORTH SOUTH and EAST WEST. The size of the claim is 1500 feet long by 600 feet wide.

Located this 12 day of MAY, 2025.

By: JOHN & TOM WEAR AND

BOB BEARSECKED

Address: H566 Box 4-11 19821

BEAUREND RD

215 PLEASANT HILL

BATTLE MOUNT NV

Witness: John Wear



MOUNT DIABLO VERIDAN, NEVADA  
TOWNSHIP 32N RANGE 48E  
SECTION 12

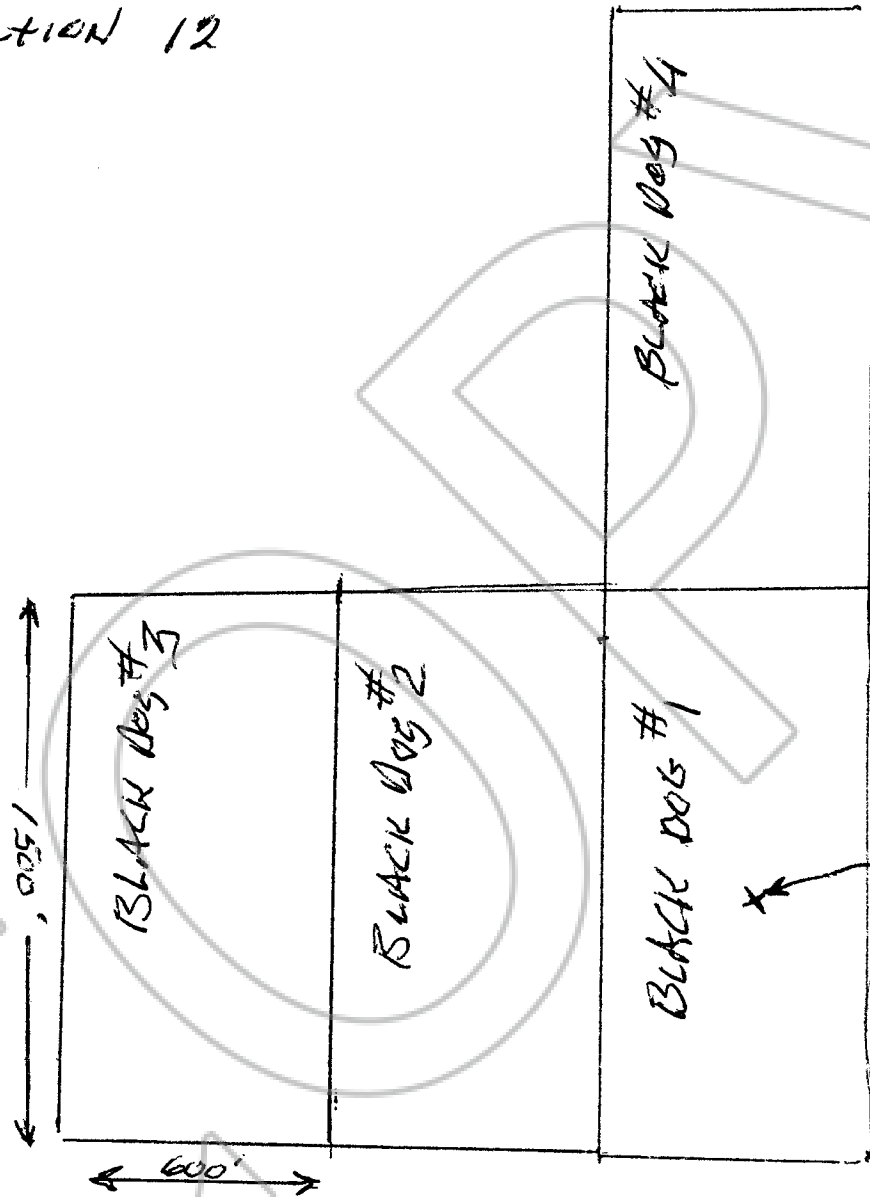

BLM MONUMENT  
MAHONEY WELL  
NE 1/4, SE 1/4 SEC 12



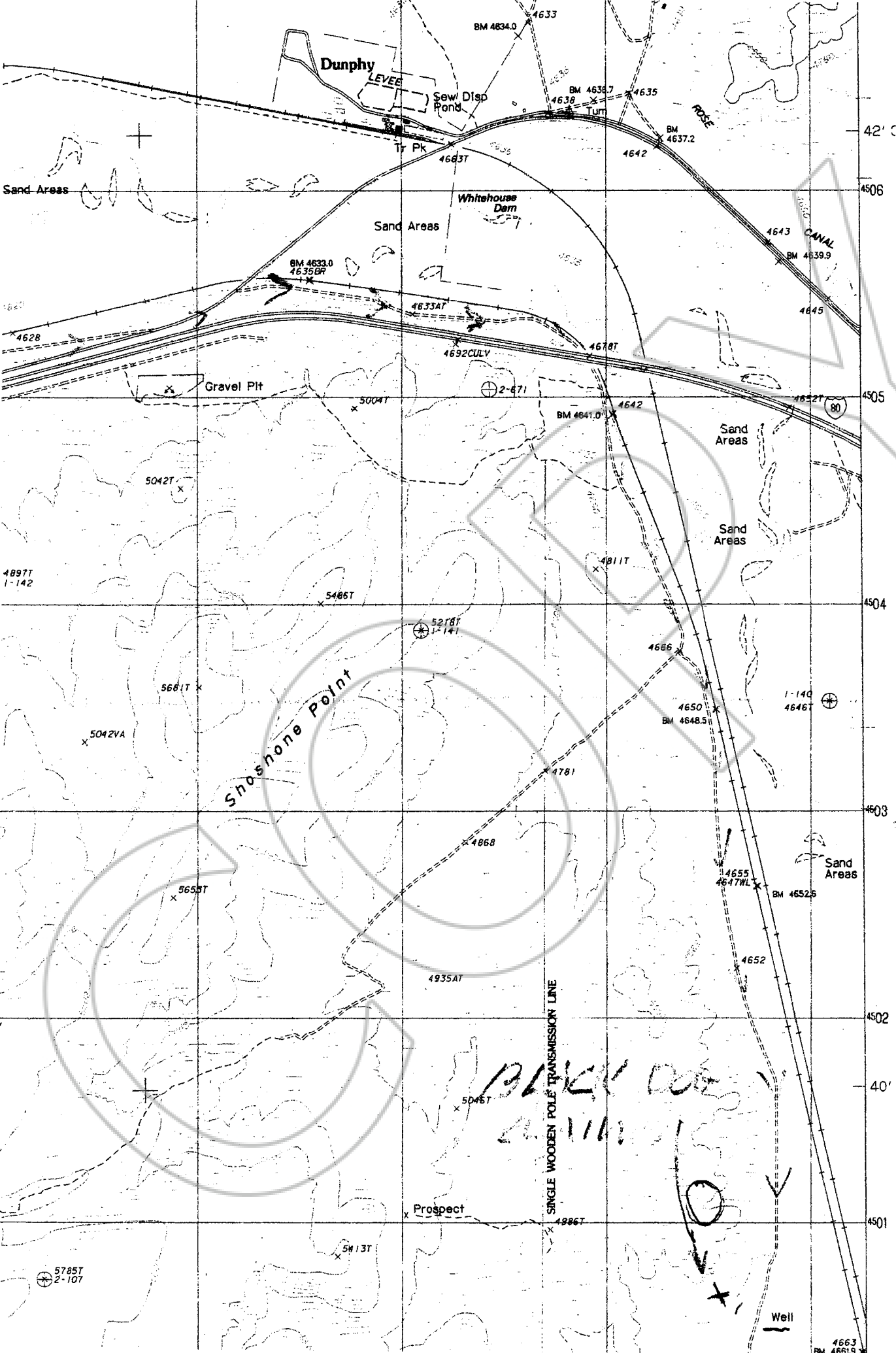

BLACK OAK  
2-11-11

SINGLE WOODEN POLE TRANSMISSION LINE

Well

Shoshone Point