

SURVEYOR'S CERTIFICATE

I, ROBERT THIBAUT, A PROFESSIONAL LAND SURVEYOR LICENSED IN THE STATE OF NEVADA, CERTIFY THAT:

- THIS PLAT REPRESENTS THE RESULTS OF A SURVEY CONDUCTED UNDER MY DIRECT SUPERVISION AT THE INSTANCE OF MARBLE KEY, LLC.
- THE LANDS SURVEYED LIE WITHIN SECTION 21, T.29 N., R.48 E., M.D.B. & M., AND THE SURVEY WAS COMPLETED ON AUGUST 21, 2025.
- THE MONUMENTS DEPICTED ON THE PLAT ARE OF THE CHARACTER SHOWN, AND OCCUPY THE POSITIONS INDICATED AND ARE OF SUFFICIENT NUMBER AND DURABILITY.

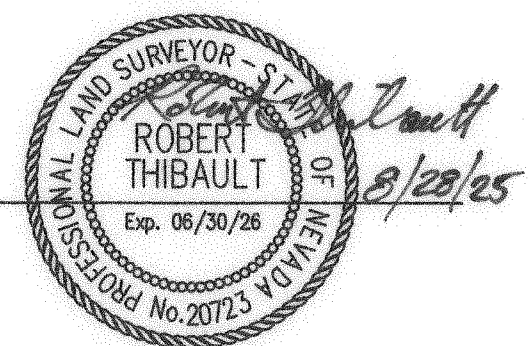

ROBERT THIBAUT, P.E., P.L.S. 20723

NOTES:

- THE TOTAL SURVEYED AREA OF THIS MAP EQUALS 159.921 ACRES.
- BASIS OF BEARINGS: THE LINE BETWEEN THE FOUND NORTHEAST CORNER AND EAST 1/4 CORNER OF SECTION 21, T.29 N., R.48 E., M.D.B. & M., TAKEN AS S 00° 25' 30" E.

LEGEND

- ◇ = SECTION CORNER AS NOTED.
- ◆ = 1/4 SECTION CORNER AS NOTED.
- = SET 5/8" REBAR WITH CAP MARKED P.L.S. 20723.

EUREKA COUNTY, NV
LAND-ROS
Rec: \$29.00
Total: \$29.00
HIGH DESERT ENGINEERING
2025-255080
09/08/2025 10:58 AM
Pgs: 1



KATHERINE J. BOWLING, CLERK RECORDER

FILING DATA

FILE NO. _____
FILED AT THE REQUEST OF
HIGH DESERT ENGINEERING.
DATE _____, 2025
TIME _____ M.
EUREKA COUNTY RECORDER

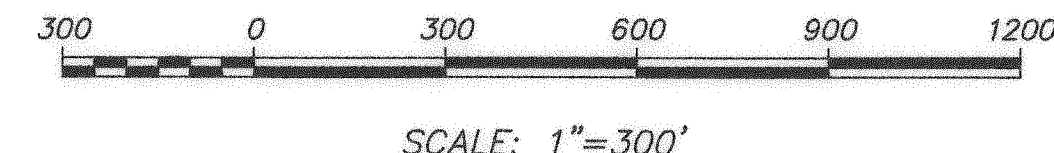

RECORD OF SURVEY FOR MARBLE KEY, LLC IN SECTION 21, T.29 N., R.48 E., M.D.B. & M. EUREKA COUNTY, NEVADA	
HIGH DESERT ENGINEERING	640 IDAHO STREET ELKO, NEVADA 89801 (775) 738-4053
225079	